





# From The Staff:

WTFDA Headquarters, P.O. Box 97, Calumet City, IL 60409

**CORRECTION...**In the October FROM THE STAFF, we mention that the deadline for getting bids in for the 1980 WTFDA Convention is November 1; this was in error. Persons interested in hosting the event have until November 30 to contact us in writing.

**FM DXers--ACT NOW!...**Have you got your copies of WTFDA's Educational FM Guide and Ondas FM yet? If not, hurry. Both of these information-packed club publications are one-time-only limited editions, filled with data that should be very useful to any FM DXer. EFM features a complete list of the educational FM stations operating in the U.S., and includes details on operating schedules and addresses. ONDAS FM is a unique bilingual directory to the FM stations of the Caribbean, Central America, and South America. EFM is available from HQ at \$2 per copy, ONDAS sells for \$3. No additional copies will be printed when our current supply of these run out, so if you want a copy, order soon.

**F2 CONDITIONS IMPROVE RAPIDLY...**During the month of October, F2 skip conditions on VHF enhanced so quickly that some DXers' heads must still be spinning. 41 MHz TV audio was heard by many on a couple of late September dates, but as late October approached, the European audio signals became a very regular visitor to North America. F2 MUFs on transAtlantic paths have been at 50 MHz and above on many occasions already, with some North Americans viewing video signals from Europe. The F2 skip is making DX news around the world this fall, with British video seen by viewers in Australia, and western Europeans watching co-channel interference on channel E2 caused by F2 skip. One German ham radio operator has been viewing video from the central western U.S.S.R.! More details will appear in the VUD in coming months.

**BITS...**Thanks to northern Michigan DXer Paul Petosky for this month's cover, and to Leo Boehl, Paul Gaines and John Zondlo for supplying many logos for use in the VUD's most recent issues...WTFDA NEWSWIRE will return in December... Some VHF amateur radio operators are calling September the best month ever for tropo DX--it featured a tropo duct that extended from Ontario to Texas in the 8th through 10th period.

## TABLE OF CONTENTS

MAILBOX: Bob Cooper to host satellite seminar in Florida...	3
FCC TV NEWS: More tall towers going up in the Southeast...	6
FCC FM NEWS: FMs on Minneapolis' IDS tower testing.....	8
NORTHERN FM DX: Northerners report on the great tropo.....	9
SOUTHERN FM DX: 920-mile catch highlights the ducting....	14
EASTERN TV DX: "Tropo was unbelievable...".....	22
PHOTO NEWS: Dominican and Puerto Rican TV DX photos.....	35
WESTERN TV DX: 950-mile Duluth-to-Baltimore UHF tropo!...	36
VHF UTILITY DX: F2 MUF back over 50 MHz again.....	38
IN SEARCH OF PSB: Some info on DXing F2 on lowband VHF...	42
TECHNICAL TOPICS: Questions on circular polarization.....	44
QSL CORNER: All FM QSLs; don't forget those addresses....	46
TUNE IN ON SIX: There's all kinds of DX on 50-54 MHz.....	47



# MAILBOX

John Zondlo  
6617 Maryland  
Hammond, IN 46323  
(219) 844-8694  
Deadline: 10th

### New Members:

John Adler	RR 2, Box 161	Milbank, SD 57252
Dean Bianco	50 Water St.	Eastchester, NY 10709
Louis Campagna	9724 Bridle Road	Philadelphia, PA 19115
Kocsis Ferenc	Tompa ut 9.	H-9431 Fertod, HUNGARY
Bakos Gabor	Zoldfa utca 13.	H-3733 Rudabanya, HUNGARY
Chris Patrinelis	2829 White Plains Ct.	Springfield, IL 62704
Sherwyn D. Rosen	2251 W. Tarleton, Apt. 206	Stephenville, TX 76401
John White, Jr.	The Moonshiner's CB Shack	Shacklefords, VA 23156
	Box 97	

### Renewals:

Thomas Bishop, Neil Dickerson, Robert Eddy, Philip Epstein, Glenn Hauser  
Bob Langridge, August Miller, John Rieger, William Scully, Yuuzi Shirahama,  
Robert Sowinski, Larry Van Horn, Walter Wesolowski, Dr. Richard E. Wood.

### Rejoin:

Craig Shura-19 Appelby Drive-St. Catherines, ON L2M 3E5

### Address Changes:

Mike Agner-c/o Delphi Associates-144 Merrimack St., 1st Floor-Lowell, MA  
 Roger Bortree-317 W. 4th Ave.-Dickinson, ND 58601 /01853  
 Guy Kroger-2212 Chicago-Trenton, MO 64683  
 Mark Levitt-University of Hartford-Mark Twain Box #1179-200 Bloomfield Ave.-  
 W. Hartford, CT 06117  
 Rolland Lindblade-2315 N. 67th Ave.-Omaha, NE 68104  
 Mark Lucas-1435 E. Columbus Road, Apt. A-33-Lancaster, OH 43130  
 Robert Sowinski-701 4th St., Apt. 6-Bowling Green, OH 43402

### Renewals Due in December:

Michael Albanese, W.B. Barker, John Baumgarten, Don Blevins, Mike Brewer,  
Pierre Daigle, Dave Garvey, Bill Godbey, Neil Grandjean, Chris Hansen,  
Stanley B. Jones, Al Kopec, Raymond Parker, Gerald Pulice, Roger Sabella,  
Richard Schaak, Eric Schutz, Norman Sorensen, Robert Steadman, James Thomas,  
John Topel, Arthur Williams, Jr., David M. Wurl.

From the Mt. Rushmore state comes new member JOHN ADLER. His DX gear includes a Zenith X337W for FM. John is currently in Brookings, South Dakota, at school (SD State?), but will keep the Milbank address.

DEAN BIANCO learned about the club in Communications Handbook. He's a 22 year old student who's interested in SW and TV-FM DX.

From the City of Brotherly Love we get yet another member- LOUIS CAMPAGNA. Louis is into TV and PSB DX, using a Bearcat 210 and an ACA tri-band antenna. This new member also belongs to RCMA.

New member KOCISIS FERENC is a TV DXer. His DX gear includes an AT 691 "Uranus" and two norms (antennas?-jz) made in the television factory ORION in Hungary.

Also joining us this month from Hungary is BAKOS GABOR. Bakos is a TV DX and uses an ORION 60 and two norms.

And finally, from the Lone Star State, we have college student SHERWYN ROSEN. Sherwyn's DXing interests include FM and shortwave.

### Tidbits.....

A couple notes from HQ are in order this month. First off, when you order something from WTFDA, please don't send the money or check directly to me at my home address. Granted, I handle the processing of such items, but unfortunately items sent here often get delayed (read that "lost") in my personal mail (which some of you know is not answered as quickly as it should be, hi). If you want your order filled fast, send it to HQ. That also goes for renewals.

The second point this month deals with the articles I'm writing for CB Magazine. Hope you all enjoy them and can find some help in them. Our friends from RCMA, who also contribute to CB Magazine, recently explained



that organization's involvement with the magazine, and I feel such is also fitting for us. CB Magazine approached us last spring with an offer to carry a TV-FM DX column. The proposal was discussed at a board of directors meeting held in June, and it was decided that I would do the articles. As of this writing I'm not being paid for the articles, but hopefully that will change soon. It's my intention to explain the hobby and the club in the simplest terms and draw people into WTFDA. We've already had a number of inquiries about the club because of the first (October) article, and a couple have joined. CB Magazine is looking to broaden the scope of its publication, and what better way to do it than with an exciting hobby like TV-FM DXing! There will be no column in the November CB Magazine, but in December we'll look at receiving foreign TV by F2. CB Magazine is also featuring a short-wave column, done by Robert Grove. As a point of clarification, PCMA's explanation was in their September Newsletter.

WTFDAer Paul Mount is having a Thanksgiving weekend DX get-together at his apartment in Nelsonville, Ohio. A registration fee (as yet undetermined) will be charged to cover refreshments. Here's all the info from Paul: "Nelsonville is on US 33 in Athens County in SE Ohio. Get to US 33, then From NW: Keep right as you get into town. At 2nd block past the light will be yellow "LS 4" store on right of you. Turn left, passing Yankee Burger. Make first right and go downtown. Entrance is through green door, 2 doors west of Fair Store. Upstairs and to the right. Door will be marked. From SE: Take regular 33 (not Business route) through town. Slow down near car dealer, then turn right one block after Dairy Queen, see NW. US 33 is Canal Street. A free parking lot is located on US 33, southside between LS and DQ streets. Lodging available at 2 motels in town and limited pass out space in living room. Sleeping bags okay. Several restaurants within a few blocks. Let me know if you're coming. Activities: Talk, of course, bring receivers, photos and veries. Possible tour of WLGX 98.3. A chance to meet other DXers on your day off. Hope to see you!"

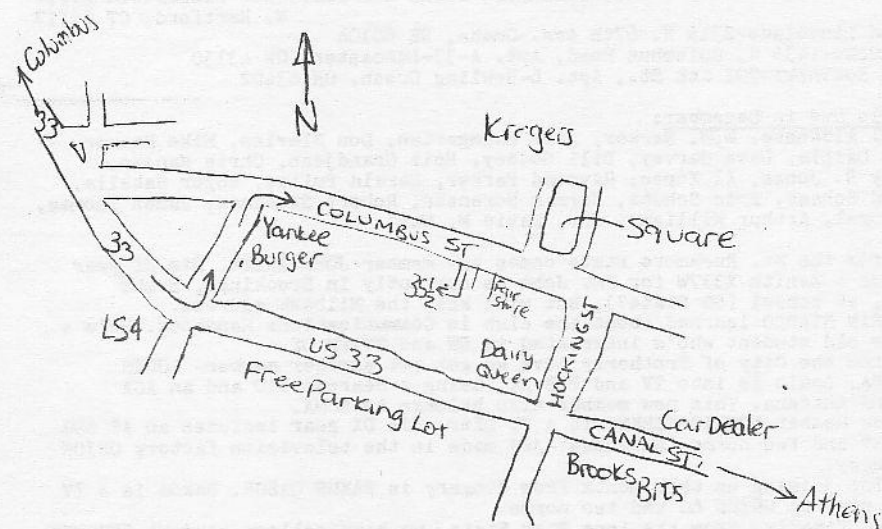

Our member in Israel, Martin Lawson, had a busy summer. He spent it working on building a new antenna tower, doubling the height of his old one. On the new tower he stacked 4 FM antennas. Hopefully we'll hear more from Martin about how the project went.

WTFDA processing manager Dave Janowiak had a quiet summer, DX-wise: "I haven't DXed at all this year. I've checked for Es several times and found little of it, as I guess it's been a bad Es year. Tropo probably has been good with so many slow moving highs, but I just don't have the time. In addition to tennis, I began running and found it a lot of fun. I don't know if I'll continue in the bad 4 months, but I'll worry about that later. I am building an MDS converter for local HBO. Also, I'm assembling plans for a small TVRO, but I'm probably a year away, at least. Otherwise, the family, etc., just take up most of the spare time." As processing manager, Dave sends out such things as QSL report forms and DX log sheets.



Electronics Trader has notified us that until December 31 it will donate 20% of all subscription revenue received to the Handicapped Aid Program. Electronics Trader is a twice-a-month ad sheet offering radio enthusiasts a chance to advertise to buy, sell, or trade equipment, literature, etc. The subscription price of \$7.50 for 24 issues includes a free ad. For more info, write Electronics Trader, P.O. Box 73, Folly Beach, SC 29439. This is a good way to help the Handicapped Aid Program, which gives disabled individuals a chance to get into the DXing hobby. WTFDA and ANARC support NAP.

Good to have Doug Everitt renew for another year! He shares these words: "I'd like to say that, in my opinion, VUD has improved since Bill Thompson took over as EIC, and I'd like to congratulate everyone on making the magazine a better one. I generally hate the petty politics that DX clubs always seem to get entangled in, and I'm glad to see much of this fade into the past. In my opinion, the club is being very well run at the moment, both from the publishing and the editorial standpoints. Keep it up! As if my satisfaction with the current state of the organization wasn't enough, I've been re-bitten thoroughly by the DX bug, and I'm hard at work on a new antenna system, so I hope the tropo conditions are unusually good this fall. This hobby is too much fun to put on the shelf for as long as I have, so I hope to be contributing to the VUD again on a regular basis."

As you may have noticed on page 3, CCI column co-editor Mark Levitt is now a student at the University of Hartford. Fortunately, his partner in editing, brother Scott, bought him a TV for his birthday so he can DX at school. If only we all had family members like that, hi!

Those of you who attended the convention and heard Mel Wilson's talk on E-skip were certainly enlightened on the subject. If you'd like to learn more about E-skip, you can get a copy of the tape by sending me a blank 60 minute cassette (to the home address this time, hi). I've got a copy and will be happy to dub it for anyone interested.

WTFDA member and TVRO expert Bob Cooper will host another Satellite Private Terminal Seminar February 5-7 in Miami FL. The first such seminar, held in Oklahoma City last August, was an overwhelming success. If you'd like to attend and learn more about building your own satellite TV receiving system, write Bob for more info. The address is SPTS '80, P.O. Box G, Arcadia, OK 73007. Registration fee for the seminar is \$150, which includes several manuals on TVRO construction. If you can't attend and are still interested in TVRO's, write Bob for more info on the services of his company, Satellite Television Technology, at the Arcadia address. The Satellite Study Package offered by STT is a must for any TVRO enthusiast.

Many thanks go to member Ken Simon for an article he wrote on TV DX for the Palm Beach Times. Ken is a staff writer for the paper. The article appeared in the June 7th edition of the Times. It just goes to show that TV-FM DX is a great topic for a newspaper article! We'll have more news in a future Mailbox about how you can contact your local news media about having a story done on you and your hobby.

Now from recent joiner Saul Chernos we have these comments: "I've had a mediocre summer season of DXing in FM & TV. I only did TV for a few days, as most of my time was spent on FM and mediumwave. On FM, I had several skips from the south and from the west. I had one interesting meteor scatter. While listening to 103.3 WPHD in Buffalo NY (not DX'ing), I heard faint MS. One time, it came in on the 1/2 hour, and all I heard was "KPRS, Kansas City". As I was on 103.3, I simply looked it up in a logbook (Kansas City, Missouri). I also had 5-6 second MS on TV, channel 5, at about 0530 (within an hour of it, or so). WCVB in Boston MA came in with a loco (pre-broadcast test pattern). Used a rotor for summer TV and some FM. Caught all skip without the rotor, on my "antique" radio, a Sony TFM-1102. I collect radio promo items and would be willing to trade by mail. I only need buttons and stickers, but, in return, can provide anything a Toronto radio/TV station gives out (also other stations in Ontario and AMers), e.g. CHUM-FM, CBNV, CBC, CHIN, CILQ [Q-107]. Also, most important: what Alabama FM on 92.1 IDs as "FM-92" Three possibilities: Cullman, Fairhope or Hamilton. But which? Also, Q-102 on 101.9 - not KFMQ in Nebraska, or so they tell me. Had with skips from MO, SD, KS. If anyone needs Ontario DX information (AM, FM or TV), feel free to write. My address is 79 Ridge Drive, Toronto, ON M4T 1B6."

Well, that's about it for this month. Hope you all have had more DX lately than we've had here. After a good start in late August and early September, the band has died. Oh, well, such is life; maybe it'll be made up in lots of early skip next spring (don't bet on it, hi). See y'all next month.....73.....jz



# TV NEWS

John F. Combs  
2485 Ivan Ct.  
Orlando FL 32807  
305-677-0066

November 1979

### NEW STATIONS ON AIR

AZ Phoenix	KNXV-15	9-5-79
AZ Phoenix	KTVV-33	9-2-79 (SIN)
NC Winston-Salem	WGWN-45	9-21-79 (Rlgs.)
PA Red Lion	WGCB-49+	(Unofficial)
TX El Paso	KGIC-14	7-31-79 (Rlgs.)
VA Norfolk	WTVZ-33	9-20-79

### STATIONS RETURNING TO AIR

FL Orlando	WOPF-35+	10-1-79 (tests, promos)
		10-15-79 (reg. perm.)

KY Paducah WKPD-29 9-5-79 as ETV stn

### STATION OFF-AIR TEMPORARILY

CT Hartford WHCT-18 8-8-79 until 11-5-79

### APPLICATIONS FOR NEW STATIONS (\*ETV)

\*AZ Casa Grande Ch. 43, 4.19, 45  
(by Casa Grande Union High School; Channel is allocated to Coolidge...)

FL St. Petersburg Ch. 38, 4850, 1436

FL St. Petersburg Ch. 38, 1580, 563

IA Des Moines Ch. 17+, 3715, 1769

(by licensee of KPLR-11 MO)

IA Des Moines Ch. 17+, 2500, 1810

KS Topeka Ch. 43, 1150, 1118

(by licensee of KQTV-2; Ch. 43 would be full-time ABC with KQTV-2 becoming a semi-satellite of Ch. 43; Topeka currently has no full-time ABC affiliate...)

MO Springfield Ch. 33 (offset unknown),  
579, 1634

NE Omaha Ch. 15, 2910, 841

NE Omaha Ch. 15, 2630, 1040

NE Omaha Ch. 15, 5000, 1320

NY Buffalo Ch. 49-, 1000, 966

\*NC Jacksonville Ch. 19, 1393, 1049

NC Kannapolis Ch. 64-, 12.42, 318

TN Memphis Ch. 30, 2740, 1100

TN Nashville Ch. 30+, 1162, 745

(by Carolina Christian Broadcasting,  
licensee of WGS-16 SC)

TX Austin Ch. 42-, 5000, 1290

(contending with SIN xlr application)

TX Victoria Ch. 25, 0.808, 506

UT Salt Lake City Ch. 14-, 1660, 3836

\*WA Centralia Ch. 15+, 600, 2314

WA Spokane Ch. 22, 1156, 2829

WY Rawlins Ch. 11-, 6.14, -13

### APPLICATIONS FOR PAY-TV SERVICE

CA San Francisco New Ch. 26

CA San Jose KSTS-48 (CP)

FL St. Petersburg New Ch. 38 (2)

FL Tampa New Ch. 28

IL Aurora New Ch. 60

NJ Vineland WREN-65 (CP)

### PAY-TV SERVICE AUTHORIZED

AZ Phoenix KNXV-15 9-6-79 until 12-5-79

### NETWORK CHANGES AND AFFILIATIONS

MS Meridian WTOK-11 switches from CBS to ABC, effective March 1980

MN Minneapolis WTCN-11 affiliates with NBC WMSF-9, losing ABC to KSTP-5, goes independent

AND ALSO, new stations KJCT-8, Grand Jct. CO, WMDT-47, Salisbury MS, and WGA-44, Valdosta GA (all Cps expected on by 1-1-80) all have signed with ABC, bringing ABC affiliates to 204.

MS Columbus WCBI-4 switches back to CBS again (was ABC for awhile)

MS Columbus WCBI-4 switches back to CBS again (was ABC for awhile)

### SELECTED TRANSLATOR CPs

AL Jackson, W5HAJ (WTTQ-41), 100
CA Bear Valley Springs, K45AD (KMTF-18), 10 K54AJ (KCOY-12), 20
CA Bear Valley Springs (eastern portion), K26AA (KAIL-53), 20 K33AD (KBAK-29), 20 K35AC (KMTF-18), 20 K39AD (KERO-23), 20 K41AC (KNKT-2), 20
CA Bear Valley Springs (northern portion), K48AG (KETT-3), 20 K51AJ (KSBY-6), 20
CA Bear Valley Springs (western portion), K56BC (KMTF-18), 20 K66BD (KML-24), 20 K62BB (KMPH-26), 20 K66BL (KFSN-30), 20 K68BN (KJBO-47), 20
CA Carpinteria, etc., K65BP (KTRN-40), 100
CA Cathays Valley, K55BZ (KMPH-26), 100
CA Thousand Oaks, K55CC (KTRN-40), 100
CA Ukiah, K67BV (KQSC-36), 20
ND Oakland, W36AB (WWPB-31), 1 (Try it, Tom Y.)
MN Donnelly/Herman, K57EL (KTHI-11), 100 K59BT (KMSP-9), 100 K61BJ (KDLO-3), 100
MN Red Lake, K65BN (KXJB-4), 100
MN St. James, K44AD (KMSP-9), 100
NY Belden, W62AX (WSKG-46), 10
NY Franklin, W56BA (WSKG-46), 1

**5** KTLA 100/

### SELECTED TRANSLATOR APPLICATIONS

CA Victorville, 60, 62, 69 (KNKT-2, KNBC-4, KTLA-5), 100
CA Hartwell/Royston, 22 (WCES-20), 1000
MN Big Fork, etc., 67, 69 (KDLH-3, KJBR-6), 100
MN Max, 60, 62 (WIRT-13, KDHL-3), 100
MN Pope Cty./Starbuck, 68 (KXJB-4), 100
NE Beatrice, 23 (KUON-12), 1000
NY Gabriels, etc., 67 (WCPE-57), 100
NY Willsboro, 67 (WCPE-57), 100
NC Burnsville, 67 (WUNE-17), 100
NC Marion, 65 (WUNE-17), 100
NC Spruce Pine, 59 (WUNE-17), 100

### SELECTED TRANSLATOR CHANGES

NY Fillmore, W62AQ -  
NY Friendship, W62AS - both change stn to WXXI-21

### TRANSLATOR APPLICATIONS DISMISSED

PA Philadelphia, Ch. 57 (SIN)  
CA Los Altos, Los Gatos, Mountain View, Palo Alto, San Jose, Santa Clara, Saratoga, and Sunnyvale (too bad--I would have liked to see someone log it and try to fit the location in their log--hi!), Ch. 42.

### CALL LETTERS ASSIGNED

AR Mountain View, Ch. 6-ETV, KEMV
FL Jacksonville, Ch. 30+, WAWS-TV
MD Baltimore, Ch. 54, WNUV-TV
ND Minot, Ch. 6+ ETV, KSRE
OK Oklahoma City, Ch. 34, KGMC
SC Spartanburg, Ch. 49 ETV, WRTS-TV
WI Eau Claire, Ch. 18, WQOW

### CHANGE IN CALL LETTERS

FL Orlando, WOPF-35 (ex-SWB)
GA Atlanta, WTRS-17 (ex-WTCG)
MO St. Louis, KSDK-5 (ex-KSD)
NM Clovis, KMCC-12 (ex-KFDW) (aren't those the former calls of Ch. 28 Lubbock TX?)

MS DEPARTMENT: As I worked this column



SELECTED CANADIAN INFORMATION FOLLOWS:  
(via Walter Patton and David Leibold)

**JOIN US AT THE  
END OF THE RAINBOW.**

**STARTING  
MONDAY  
SEPT. 3rd**

- MOVIES
- VARIETY
- GAMES
- SPORTS



**GREAT PROGRAMS IN ANY MAN'S LANGUAGE**

**NEW STATION ON-AIR**

**CHMT-47** Toronto ON 9-3-79 with programming in some 26 different languages, to be increased to anywhere from 32 to 40, depending on what you read. CHMT runs 807-kw from the CN tower. About a third of schedule is in that obscure tongue, English. (Schedule runs 1400 to 0130 weekdays, 0600 to 0130 on weekends.)

**DECISIONS (CPs)**

ON Geraldton Ch. 7 2.3-kw rebr.: CBLFT-25  
ON Maniwotouage Ch.15 9.8-kw rebr.: CBLFT-25

**APPLICATIONS**

MB McCreary Ch. 11 31.8-kw rebr.: CKX-5  
ON Mattawa Ch. 26 2.8-kw rebr.: CBLFT-25  
ON Owen Sound Ch. 14 133-kw rebr.: CKNX-8  
SK Meadow Lake Ch. 8 8.56-kw rebr.: CKSA-2

**CHMT-47 Promo**

**MORE ON THE CONTINUING SAGA OF UNCLE DAVID BROUGH AND HIS PIRATE STATION FOLLIES:** Brough has received permission to run his stations in Nakima, South Bay Mines, Caramat, Mattabi Mines, and Moosonee. He proposes 5 transmitters in each location: (1) An educational service, (2) A community programming service (public access?), (3) a CTV service, (4) a French service, and (5) A scrambled pay-TV service. Brough stations in Cochehour, Ear Falls, Ignace, Sioux Look-out, and Wawa will be allowed to continue operating, although not licensed by the CRT. **THE CTV NETWORK** has been ordered by the CRT to increase its Canadian content in 1980-81, primarily in the areas of children's programming and drama. **TVOH-OH!** Recent budget cuts for TVOntario (TVO) will likely delay and expansion plans that TVO may have been entertaining.

\*\*\*\*\*  
MORE U.S. NEWS.....MORE U.S. NEWS.....MORE U.S. NEWS.....MORE U.S. NEWS.....  
\*\*\*\*\*

**TV Non-IDs.** Due to a lack of interest and support, I will not list TV Non-IDs this time. If this information is important to you, please contribute any slogans or non-IDs that your area stations use!

**JOHNNY SAYS "NO" TO NBC.** Wait, Carson is still the host of the TONIGHT show. But the hand that feeds him wanted something other than Johnny's talent—namely, his TV station! It seems that NBC quickly attempted to persuade Carson to affiliate his KVVU-5 Henderson NV with NBC. Why all the fuss? The local NBC affiliate, KORK-3 Las Vegas, was ordered off-the-air by Sept. 3 for clipping violations. At last report, KORK-3 has not yet been reported off, but NBC officials are trying to sway Carson "just in case" the FCC carries out the threat!

**SURPRISE!** A Pennsylvania reader confirms that WGCB-49 Red Lion PA is on-the-air! Although no official word has gone out, the reader gives their schedule as 1200-2400 daily with "about 50% religious programming and 50% 'family' shows (e.g. "Lassie")." WGCB stands for "God, Christ, and the Bible." (For those of you who have studied communications law, remember the infamous Red Lion Broadcasting case involving equal time, etc.? You got it, same folks....)

**MORE IPEN NEWS:** Iowa Public Broadcasting's new translators in Rock Rapids (Ch. 25, 1-kw) and Sibley (Ch. 33, 1-kw) are on-the-air according to Bob Baker. (Baker, not Barker, for you "T or C" aficionados....) Ch. 44 translator in Keokuk (100-w) should go on in late October/early November.

**THE TALL TOWER BANDWAGON GROWS!** It looks like almost every station in eastern North Carolina and South Carolina may eventually wind up with a tower in the neighborhood of 2000'. WRAL-5 is already there, with WTVD-11 joining the club on Aug. 13. WFTN-7 is building a 2000-footer which should be in use by now. WCTI-12, WECT-6, WNCN-9, and WFTW-13(SC) have applied for the masts. (WCTI-12 is currently being contested by another station; WNCN-9's new antenna would be directional to protect WSOC-9 in Charlotte). All have, or will have, circular polarization. Who's next?

**SPEAKING OF TOWERS,** Ken Simon (back from Mexico) reports that the applicants for Ch. 42 ETV in Boynton Beach will construct a 1600-ft. tower and rent space on it to the new Ch. 25 in West Palm Beach (also in the application stage). And in Orlando, WOFL-35 was able (finally) to acquire the old tower and facilities of defunct WSWB-35 (all but the studios and offices, now occupied by public WMFE-24) and began limited broadcasting October 1, consisting of a 30-40 minute promotional tape, previewing the various shows they will carry, and some tests with 3/4 color bars, all mostly between 1500 and 2000 EDT (varies.) Regular programming to start October 15.

**GEMS, JEWELS, AND TIDBITS FROM THE 1979 TV FACTBOOK:** WTVY-4 AL now has xtr in FL...KFPW-40/KTVP-29 AR are ABC primary/CBS secondary...KFSM-5 AR is NBC prim./ABC sec....KLMN-24 is CBS...KQTV-2 wants 2000-ft. tower near Potter KS...KOMC-8 MO has xtr in KS...new owners of WCMC-40 want 1706-kw and 447 AAT (now 16.6, 100)...KXIX-19 no longer a satellite of KIII-3 (TX)--can Pat or someone confirm network on this one?...WTRF-7, WTAP-15 (WV) xtrs in OH...WXOW-19 WI xtr in MI...ERROR: WOLE-12 PR shown as getting service from WAPA-4, but my DX experience shows WAPA-4 affiliated with WORA-5 while WKAQ-2 and WOLE-12 simulcast (former noted on TV Es, latter via sked hard on Es from Mayaguez FM).

**CONTRIBUTORS:** Robert Baker, Humboldt IA; Leo Boehl, Grand Island NE; Roy Horsley, Gadsden AL; David Leibold, Blyth ON, Canada; Walter Patton, Montreal PQ, Canada; Dave Pomeroy, KTWU-11, Tampa FL; Leslie Price, Wilmington NC; Ken Simon, Lake Worth FL. (collapsed tower capital of



# FM NEWS

Bruce F. Elving, Editor  
Box 251-KSC  
Kearney NE 68847

Yes, I'll answer mail, but I don't have too much time for this. I do thank all contributors to this column for their news!

SCA (67 kHz)

## NEW FM STATIONS

- AK Anchor Point K296BH 107.1 \$, g (KHVN 100.5 Anchorage translator)
- CA Alturas K265AN 100.9 \$, m (KTMT 93.7 Medford OR translator), I
- CA Bishop K221AO 92.1 \$, m (KSRN 104.5 Reno NV translator)
- CA Yreka K265AI 100.9 \$, m (KTMT), I
- GA Donalsonville 106.3 2500 h.v.; 330'
- HI Lihue 92.7 100 h.v.; 1220' Hawaiian music
- ID Bonners Ferry K272AR 102.3 \$, m (KEZE 106.5 Spokane WA), U
- K276AQ 103.1 \$, r (KHQ-FM 95.1 Spokane WA), N
- K296BJ 107.1 \$, m (KXLY-FM 99.9 Spokane WA), Columbia Bstg. System
- MN Cook K280AZ 103.9 \$, r (WAKY-FM 98.9 Duluth MN), I
- MN Orr K288BN 105.5 \$, m (WEVE-FM 100.1 Eveleth MN), Y
- MS Starkville 92.1 1080 watts; 500'; m
- MT Marysville and "Three-Mile Creek Area" (about 25 km NW Helena) K296BI \*107.1 \$, c; (KUFM \*89.1 Missoula translator); P
- MT Ronan 92.3 10000; 600'; rk
- NV Incline Village "Near Carson City just above L. Tahoe" K265AJ 100.9 \$, mk (KEZC 101.7 Truckee CA translator), Mutual network
- NV Round Hill (location unknown): I have written KEZC, which station this translator will be broadcast, for the translator's geographical coordinates) K265AK 100.9 \$, mk, Mutual
- NV McDermitt K292BH 106.3 \$, r (KFXD-FM 94.9 translator); KFXD-FM is in Nanpana 17'
- NC Dallas \*91.7 3000 h.v.; 155'; Gaston College
- OR Ashland and Jacksonville K276AP 103.1 \$, m (KTMT 93.7 Medford OR), I
- SD Kadoka K280BA 103.9 (KRCS 93.1 Sturgis), mk TX Eldorado - new translator authorized, but calls, frequency and station rebroadcast unknown
- WI Ashland and Washburn K265AM \$, g (WWIB 103.7 Ladysmith WI), U
- AT Bossano CJAY- 106.1 9watts; relay of CJAY-FM 92.1 Calgary; rock
- MB Thompson 100.9 94 w; CBC-AM; CBCW relay
- NB Campbellton 88.9 36000; CBC French CBAF'
- NB Nequac 97.9 32000

## STEREO STATIONS

- KS Clay Center KCLY 100.9
- MD College Park WMUC \*88.1, p
- OH Wapakoneta-St. Marys WAXC 92.1
- TX Lubbock KTXL \*88.1, no SCA heard

## FACILITIES CHANGES

- AL Birmingham WDJC 83.7 100000 h.v.; 870'
- CA Ojai KOVA 105.5 115 h.v.; 1260'
- CA Thousand Oaks KCPB \*91.3 4800 h.v.; 1280'
- CO Security KRWYD 105.5 49 h.v.; 2230'
- ID Orofino KLER-FM 95.3 100 h.v.; +750'
- KS Arkansas City KBUZ 106.5 460' (100000 h.v.), Stereo, rk, soon to be on the air
- LA Crowley KAJN-FM 102.9 100000 h.v.; 1500'
- PA Charlotte WMMQ 2550 h.v.; 320'
- MI Flint WDDZ 97.7 255' (3000 h.v)
- MN Rochester KRPR \*89.9 1000 h.v.; 500'
- NY Greer WGMC \*90.1 2050 h.v.; 46'
- TX Denton KNTU from 88.5 to \*88.1 17000 h.v.; /
- TX Orange KZOM 104.5 100000 h.v.; 400'
- VT Brattleboro WKVT-FM 92.7 480 h.v.; 660'
- WI Waukascha WCCX from 88.1 to \*104.5 10 w, 44'

## DELETIONS

- MS Columbus WLNK \*90.9
- SD Aberdeen KASD \*90.1
- VT Putney WVUS \*88.9

NY Albany WAMC \*90.3 talk (medical news, occasional)

## SLOGANS/NON-IDS

- AR Jonesboro KBTM-FM 101.9 Stereo 102
- KY Hopkinsville WHOP-FM 98.7 FM-98
- MO Louiston WCOU-FM 93.9 U-94
- MD LaPlata-Waldorf WXTR 104.1 The Extra 1
- MN Richfield KDWB-FM 101.3 K-101, no programming separately from AM adjacent
- NE Kearney KOKY 105.9 KD-106, ON AIR!
- NY Plattsburgh WGBF 99.9 B-100-FM
- NC Asheville WLOS 99.9 FM-99.9
- OH Cincinnati WEBN 102.7 no nonID - never used Q-102, as reported earlier!
- TN Memphis WHRR 97.1 K-97-FM Verystriect WQUD 104.5 Quid-104
- VV Winchester WQUS 92.5 US-92; monaural.
- WV Parkersburg WQAW 103.1 mr, Stereo 103
- PO Sherbrooke 101.1 (calls not known), IDs only as "Radio Canada" (French)

## CALL LETTERS

- AK Fairbanks 101.1 KAYY (KAME)
- AK Homer 103.5 KGTL
- CO Colorado Springs 101.9 K KCS-FM (KINX)
- CT Somers \*89.7 WDJW
- FL Orlando \*89.9 WUCF-FM (WFTU-FM) I
- IL Champaign \*90.1 WERU
- KY Richmond 101.7 WCBR-FM (WBZF)
- LA Baton Rouge \*107.3 WPRG
- MI Detroit 95.5 WCZY-FM (WCZY)
- MI Tawas City 103.9 WKJC
- MN Spring Grove 98.3 KQYB
- MO Malden 92.7 KMAL
- MO St. Louis 96.3 KADI-FM (KADI)
- NE Norfolk 106.7 KEXL (WJAG-FM)
- NY Southampton \*91.3 WPBX
- OH Waverly 100.9 WIXZ (WIBO)
- OR Coos Bay 105.5 KYNG-FM
- PA Waynesburg \*88.7 WCYJ-FM
- TN Pikeville \*91.3 WIKU
- TX Fredericksburg 101.1 KFAN (KNAF-FM)
- TX McAllen 96.9 KVMV (KVMV-FM)'
- UT Tootsie 92.1 KTLT
- WV Oak Hill 94.1 WRJL (WOAY-FM)
- WI Schofield \*89.1 WESD

## FORMATS/NETWORKS

- CA Los Angeles KZLA 93.9 rock
- FL Fort Lauderdale WSDO 106.7 all rock
- FL Leesburg WHLY 106.7 r (from pm)
- FL Miami WMJX 96.3 disco (d)
- WAIA 97.3 all rock
- FL Mount Dora-Orlando WORJ 107.7 r (from p)
- FL New Port Richey WGUL-FM 105.5 r (from mk)
- FL Plantation Key WXOS 100.3 m (from mj)
- FL Sarasota WSPB-FM 106.3 m (from r)
- FL Tampa WUSF \*89.7 c (from cr)
- IL Benton WoodR 106.3 rp, "106."
- IL Normal WGLT \*89.1 P
- IN Danville WGR 107.1 dg, "Foxy-107"
- IN Jasper-Huntingburg WITZ-FM 104.7 r, Stereo
- KY Morehead WMOR-FM 92.1 k
- MN Rochester KWGK 96.7 r (from rm)
- KRCH 101.7 r (from p)
- MS Amory WAFM 95.3 rp
- NE Hastings KICS-FM 93.5 s (from y)
- NE Lincoln KLIN-FM 107.3 CBS (7-7:15 am news)
- ON Cornwall CFLG 104.5 m
- PQ Longueuil CIEL 98.5 mr
- PQ Montreal CITE 107.3 m
- PQ Sherbrooke CITE-1 102.7 m; separately programmed from the above station.

Some abbreviations used, this column: m is middle of the road or easy-listening music, r rock, rp is so-called "album-oriented rock"; P National Public Radio, N NBC, C CBS, I ABC Information, k is country music; S is stereo; \*educational station.

was surprised I left Duluth, but expects I'll be back from time to time to add to my log.

As you can see, I am settling into NE life, while my family is temporarily in Duluth. I hope soon to have a house bought at a nice hill-top location and to have a tower for DXing. Chris Hansen says WTFM 103.5, on its SCA, is usually running "X", but has a "Family Hour," 8:30-9:30 pm Eastern time Saturdays. This is a Mormon production and recent programming included sermons from various LDS leaders and a commencement address at Brigham Young University. John Ebeling says "KZIO 102.5 Duluth/Superior is on the air with a rock (ugh!) format. Guess they must be 100 kw (they) put in a pretty good signal here in Minneapolis. The 5 stations involved in the IDS antenna mess have been running transmitter tests for the past several weeks. . . they went through 4 different consulting firms before finding one that would attempt the job, due to all the RF problems involved. Every night between 12-1 am the normal programming of KDWB-FM, WAYL-FM, KORS-FM, KEYE-FM and WLOL has ended, allowing some DX attempts on normally used frequencies."

From Louisiana, Mike Dorner reports: In all fairness, it must be said that MISSISSIPPI has an excellent ETV network, and when it comes to public radio, Louisiana is not so far ahead of Mississippi. We have one public station, WWOZ, and seven non-watters, plus applications and construction permits for more. A long-term link up for a New Orleans station (WNOZ \*90.7) is likely to expire...WRB\*89.3 New Orleans, operated by Lighthouse for the Blind, not likely to be on air by end of year, as planned...WPCS \*89.3 Pensacola, transmitter at Robertdale AL, is off the air after Hurricane Frederick...perhaps other Mobile-Pensacola area stations that I do not hear regularly are off the air.

WEVZ 101.7 Fort Wayne IN said to have had audio quality, S, beautiful music: P. Boersma. Walt Kowalczyk read a few years ago an article that the FCC was against prohibitions on home SCA listening, and said stations may eventually offer programs on their subchannels as well [to the public]. OH 101.1 WSRD is not WHOT as a DXer mentioned in VUD, but they do simulcast WHOT AM in the morning, with acid rock the rest of the time. Ralph sent a propaganda tape extolling virtues of stereo AM.

NY's Robert L. Foxworth drafted a letter to Sino's attorney, supporting my stand for the public's being able to tune in SCA, but I am not sure such a letter is necessary. Recent word has it Sino no longer runs out radios, and is making money just by selling ads, and is apparently not going to fight private listening to their SCA.

Randall Clark says WQIT 100.9 Grafton WV heard 105.9 Middletown OH has German language programming occasionally, but it is normally, "Disco-106."

CONTRIBUTORS, this month and last: Phil Boersma, Spring Lake MI; R. B. Clark, Parkersburg WV; Tom Cornell, Greentown IN; Mike Dorner, Jr., Metairie LA; John Ebeling, Bloomington MN; R. L. Foxworth, New York NY; Chris Hansen, Bronx NY; Alber J. Mariani, M.D., Rochester MN; Larry McKinney, Adams-town PA; August J. Miller, Newark CA; J.W. Richards, Orange NJ; Leon Sider, Berwick PA; Andy Smith, Jr., Hyattsville MD; Walter Kowalczyk, Pittsburgh PA; Gary Violet, owner, KBUZ 106.5 Arkansas City KS (whose SCA is for telemetry only); Larry Weil, Action MA; W.W. Wynn, Richmond Hill, Ont. Also: Andy Decker, Batesville IN; Al Ellis, Brentford, Ont.; Dave Grim, Akron OH; Rick Lombardi, Atlanta GA; Walter Patton, Montreal PQ, who can't believe all the detail I get in this column; Paul Petosky MI; R. H. Perrin, Wells ME; Bill Staus, Pasadena MD; Ralph Strobel, Muncie IN, who



# NORTHERN FM-DX

Ralph Strobel, editor  
2510 E. McGalliard Rd.  
Muncie, Indiana 47303  
(317) 288-5815

Deadline: the 10th

NOVEMBER 1979

For FM DXers in Canada, the Northwest-Central states of WA OR ID MT WY ND SD NE MN IA MO and states east of the Mississippi River and north of the Mason-Dixon Line.

## EXCELLENT TROPO OPENINGS HEARD THROUGHOUT SEPTEMBER

John Zondlo - 6617 Maryland - Hammond, IN 46323

Equipment: Sony ST-5130 with rabbit ears. All times CDT. All new.

7/31 tr 1925 KOEL 92.3 IA Oelwein, local WYCA off all day  
2347 WMHE 92.5 OH Toledo, heard often, finally logged it  
8/1 tr 0001 WYXE 92.1 WI Sun Prairie, r  
8/30 tr 2059 WARG 88.9 IL Summit, a tough to get 10w with r  
2100 WSOF 89.9 KY Madisonville, s/off  
9/4 tr 1513 WDFP 95.3 MI Battle Creek, "Gospel music radio"  
1600 WJIM 97.5 MI Lansing, ID & NBC news  
1615 WBCH 100.1 MI Hastings, ABC radio sports  
1632 WELL 104.9 MI Marshall, m  
1758 WNDH 103.1 OH Napoleon, well over semi-local WHME  
1801 KNWS 101.9 IA Waterloo, local WCLR looped out  
1823 WIXX 101.1 WI Green Bay, l&c over looped out WKQX  
1858 WHLA 90.3 WI La Crosse, WERN net ID  
2228 WLEW 92.1 MI Bad Axe, in surprisingly well with ID, m  
2257 WDCX 99.5 NY Buffalo, end rel. pgm., looped local WEFM  
9/5 tr 0007 KRES 104.7 MO Moberly, automated k  
0041 KCLD 104.7 MN St. Cloud, simulcast with AM 1450  
0139 KWIT 90.3 IA Sioux City, end c pgm., s/off  
0143 WCML 91.7 MI Alpena, simulcast with WCMU 89.5  
0200 WWRM 106.7 MI Gaylord, semi-local WYEN inaudible  
0222 WATZ 93.5 MI Alpena, simulcast with AM 1450  
0227 KRNA 93.5 IA Iowa City, in with call mention  
0231 WAYL 93.7 MN Minneapolis-St. Paul, m  
0237 WLST 95.1 WI Marinette, "FM-95" non-ID  
0245 WQFL 100.9 IL Rockford, finally after much trying

9/4-5 a banner opening, ironically occurring the same time as an opening to the same areas last year. Had great success in eliminating Chicago stations, ala Roger Winsor....hope to get rid of more of them, hi. 73, John

\* \* \* \* \*

John Ebeling - 9209 Vincent Ave. So. - Bloomington, MN 55431

Equipment: Bloomington - Sony ST-5130 & Heath AJ-15.

Prosit - Sony ST-5130 (I carry it back & forth).

Bloomington:

9/12 MS 0430 WRNO 99.5 LA New Orleans, good ID on super burst 1035  
9/16 tr 2300 KZIC 102.5 WI Superior, new station, r, "Super-Z"  
9/17 Au 0005 KBIA 91.3 MO Columbia, s/off 400  
0010 KSKU 102.1 KS Hutchinson, k, "U-102" 520  
0013 WKDQ 99.5 KY Henderson 555

Prosit:

9/15 tr 1000 KZIC 102.5 WI Superior

As usual, two locations are listed. The Prosit location will be almost unused until next summer, as the place is now winterized and ready for winter. Locally, the normal 24 hr. stations on 92.5, 93.7, 99.5, 101.3, & 102.1 have been leaving the air to allow work on the new transmitter complex on top of the IDS building in downtown Minneapolis. This has left the frequencies open for some DX work, which I have taken advantage of to some extent. All stations listed above are new with new mode dashed.

73, John

\* \* \* \* \*

Paul D. Traska - 64 Weaver Ave. - Buffalo, NY 14206

(DX report from 1/23 to 9/17/79)

<u>1/23</u> tr			<u>9/5</u> tr		
0003	WBCL	90.3 IN Ft. Wayne	0055	WJML	98.9 MI Petoskey
<u>1/26</u> tr			0100	WHLA	90.3 WI La Crosse
1504	CBE	89.9 ON Windsor	0104	WBKV	92.5 WI West Bend
<u>2/3</u> tr			0130	WHSB	107.7 MI Alpena
2340	CJBC	99.5 ON Kingston, WDCX off	0235	WIXX	101.1 WI Green Bay
<u>5/22</u> Es			0255	WLPX	97.3 WI Milwaukee, ex-WISN
1900	WTSU	90.1 AL Troy	<u>9/6</u> tr		
1915	WLWI	92.3 AL Montgomery, ex-ch 13	1610	WERG	89.9 PA Erie, ex-89.1 still 10w? (Don't think so-RS)
<u>5/30</u> Es			1647	WCVJ	90.9 OH Jefferson
2030	WAFG	90.3 FL Ft. Lauderdale	<u>9/9</u> tr		
2055	WPCV	97.5 FL Winter Haven	2100	CBBL	100.5 ON London
2055	WDTZ	100.3 FL Orlando	2345	WVWR	89.1 VA Roanoke
2102	WHRS	90.7 FL Boynton Beach, ex-91.7	<u>9/10</u> tr		
<u>6/7</u> Es			0045	KWMM	90.7 MO St. Louis
1151	KGJR	90.1 MN Collegeville	0116	WILL	90.9 IL Urbana
1344	KFJM	89.3 ND Grand Forks	0200	WWJY	101.5 IN South Bend
<u>6/24</u> Es			0201	WSND	88.9 IN Notre Dame
2000	KVTT	91.7 TX Dallas	0230	WBFQ	98.7 MI Detroit
2000	WTSU	90.1 AL Troy	1200	WEKU	88.9 KY Richmond
2055	WLYX	89.3 TN Memphis	1930	WCVF	88.9 NY Fredonia, 10w
<u>6/29</u> Es			<u>9/11</u> tr		
1200	KWEY	97.3 OK Weatherford	2207	WGBI	101.3 PA Scranton
<u>8/7</u> Es			2209	WBJZ	100.9 NY Olean
1725	WYNK	101.5 LA Baton Rouge	<u>9/11</u> tr		
1744	KNUE	101.5 TX Tyler	2300	WGMR	101.1 PA Tyrone
1840	KERA	90.1 TX Dallas	<u>9/12</u> tr		
<u>8/7</u> tr			0045	WBRE	98.5 PA Wilkes-Barre
1900	WBRD	101.1 OH Youngstown, ex-WHOT	0059	WIBQ	98.7 NY Utica
<u>8/20</u> tr			1930	WQSU	88.9 PA Sellingrove
1230	WMHE	92.5 OH Toledo	<u>9/13</u> tr		
<u>8/28</u> tr			0034	WCBS	101.1 NY New York City
1230	WPIT	101.5 PA Pittsburgh	0050	WDVR	101.1 PA Philadelphia
1230	WFAH	92.5 OH Alliance	0059	WNYU	89.1 NY New York City
<u>9/1</u> Es			0100	WXPB	88.9 PA Philadelphia
1735	KPFT	90.1 TX Houston	0115	WFHU	91.1 NJ East Orange
<u>9/4</u> tr			0140	WIRQ	90.9 NY Rochester, 10w
1200	WMBI	90.1 IL Chicago	0300	WKTP	92.3 NY New York City
1205	WHAD	90.7 WI Delafield	0320	WYVA	94.1 VA Yorktown
1930	WHRM	90.9 WI Wausau	0340	WPGC	95.5 DC Washington
2100	KUNI	90.9 IA Cedar Falls	<u>9/17</u> GW		
2101	WPNE	89.3 WI Green Bay	0115	WECQ	101.7 NY Geneva, "CQ-102"
<u>9/5</u> tr					(New underlined; log totals: 256)
0010	WKZY	97.1 MI Escanaba			

Robert S. Ross, VE3JFC - Box 4373, Stn. C - London, ON

Equipment: Marantz 2226B Receiver, Dipole @90 feet from apt. balcony.

<u>8/4</u> tr	0226	WJIM	87.75	MI	Lansing, ch. 6, excellent	175
	0322	WVIC	94.9	MI	East Lansing, very good	175
<u>8/6</u> tr	0215	WJFM	93.7	MI	Grand Rapids, excellent	225
	0333	WCHL	91.7	MI	Alpena, good	190
	0400	WCZY	95.5	MI	Detroit, excellent	120
<u>8/9</u> tr	0541	WHSB	107.7	MI	Alpena, good	190
<u>8/30</u> tr	0358	WMBI	90.1	IL	Chicago, excellent	350
	0411	WPLB	107.3	MI	Greenville, very good	225
	0500	WNDH	103.1	OH	Napoleon, very good	220
<u>9/1</u> tr	0058	WQRS	105.1	MI	Detroit, excellent	120
<u>9/3</u> tr	0157	WILS	101.7	MI	Lansing, very good	175
<u>9/4</u> tr	0400	WMBI	90.1	IL	Chicago, very good	350
	0430	WBCL	90.3	IN	Ft. Wayne, very good	220
<u>9/5</u> tr	0155	KXCV	90.5	MO	Maryville, very good	870
	0320	WBCS	102.9	WI	Milwaukee, very good	340
<u>9/10</u> tr	0500	WVJC	89.1	IL	Mt. Carmel, fair	475

Log total: 171 stations heard w/100 verified. 14 states heard w/13 verified. 1 province heard and verified.

\*\*\*\*\*



Fred McCormack - 909 12th St. N. - Fargo, ND 58102

Equipment: Fargo - Heath AJ-1600, Winegard CH-7078, Alliance rotor.

Des Lacs - Heath AR-1500, JFD 10 element log, CDR rotor.

Loggings marked with an asterisk are from Des Lacs. The rest are from Fargo.

8/5 tr				8/10 Es			
2048	KCNB	105.7	IA Waterloo	"X-rock"	375	2300*	KWBI 91.1 CO Morrison-Denver 620
2201	KIWI	105.3	IA Dubuque		435	8/17 tr	
8/7 tr						1026	KQRN 107.3 SD Mitchell r, "Q-107" 225
0633	WIMI	99.7	MI Ironwood r,	"100-FM"	315	1901	WIZM 95.3 WI La Crosse r, "Z-93" 345
1855	KBEM	88.5	MN Minneapolis		215	1958	WHRM 90.9 WI Wausau 370
1930	KQAD	100.9	MN Luverne		225	2258	KLGR 97.7 MN Redwood Falls r 180
8/10 Es						2329	KPAT 97.3 SD Sioux Falls r 230
1941*	WBLL	95.9	AL Tuskegee		1370	8/18 tr	
2024*	KMGC	102.9	TX Dallas		1100	0004	WRDN 95.9 WI Durand s/off 280
2027*	KEBC	94.7	OK Oklahoma City		905	0054	KWWK 96.7 MN Rochester r 285
2029*	KUT	90.7	TX Austin j		1260	0116	WITX 101.1 WI Green Bay 455
2031*	KTEN	93.3	OK Ada	"FM-93"	965	0621	KIOW 102.3 IA Forest City 295
2032*	KVWC	102.3	TX Vernon		980	0824	KYNN 94.1 NE Omaha 390
2039*	WCCA	94.1	MS McComb		1310	8/18 MS	
2040*	KAFM	92.5	TX Dallas		1100	0853	KATT 100.5 OK Oklahoma City 790
2043*	KOKX	101.5	TX Brownwood		1150	8/18 tr	
2045*	KOFM	104.1	OK Oklahoma City r		905	0923	KFRX 102.7 NE Lincoln r 420
2047*	KVIL	103.7	TX Highland Park		1095	8/20 tr	
2059*	KEBA	90.1	TX Dallas j		1100	2351	WCMP 92.1 MN Pine City k 200
2059*	KPMN	107.9	TX Abilene r		1095	9/3 tr	
2103*	KSIW	93.5	OK Woodward		825	1831	KAOH 94.9 MN Duluth "KO-95" 220
2112*	KFRA	105.5	LA Franklin		1380	9/28 tr	
2130*	KYUV	95.3	TX Uvalde		1320	1305	KQAA 94.9 SD Aberdeen r, "KQ-95" 125
2237*	unID	94.1	SS		??	2358	WVIB 103.7 WI Ladysmith s/off 285

\* \* \* \* \*

Joseph Fela - 150 Robert Place - So. Plainfield, NJ 07080

Equipment: Pioneer SX-828, pair of Antennacraft GFM-10s, stacked at 35 ft. w/rotor.

9/10 tr				9/12 Super tr			
2011	WKKW	106.5	WV Clarksburg k	2352	CJQR	97.7	ON St. Catharines "QR" was // to CKTB-610 after 0000.
2022	WHLM	106.5	PA Bloomsburg local ads, last heard five plus years ago.	2355	WBLK	93.7	NY DePew s
2100	WHYH	92.7	PA Starview pr, "Starview-92" plus legal ID	2359	WPIT	101.5	PA Pittsburgh s/off
2229	WMPR	88.1	SC Sumter NPR, ID	9/13 Super tr continues:			
9/12 Super tr begins:				0000	WBTF	101.7	NY Attica s/off
1915	WKKW	106.5	WV Clarksburg k, female	0005	WVCC	101.7	PA Linesville SID, prob. k
1929	WDBA	107.3	PA Dubois ID, wx	DJ0022	CKO-2	99.1	ON Toronto CKO nx
1938	WVMT	105.7	OH Cleveland	0032	WLQR	101.5	OH Toledo m, ID, ex-WSPD
1941	WDMT	107.9	OH Cleveland d, OH PSA	0048	WVCS	91.9	PA California rp, ID
1953	WAMO	105.9	PA Pittsburgh s, o/WHBI	0051	CKDS	95.3	ON Hamilton m, ID
2045	WJNL	96.5	PA Johnstown Pirates BB	0059	WJAC	95.5	PA Johnstown s/off, WPLJ off
2115	WEBF	95.7	NY Olean m, ID	0104	CKQT	94.9	ON Oshawa d, CKAR-CKQT ID
2137	CFNY	102.1	ON Brampton ID, seemed to be r, Toronto ads	0123	WQTX	100.9	NY Horseheads contest, ID
2146	WDL	104.9	PA Scranton ID	0125	WECQ	101.7	NY Geneva "CQ-102"
2154	CKPCT	92.1	ON Brantford Blue Jays BB	0138	WCMF	96.5	NY Rochester r
2205	WBUF	92.9	NY Buffalo r	0201	CING	107.9	ON Burlington old r, ID
2216	WJYE	96.1	NY Buffalo m, "Joy"	0213	unID	95.5	French with a program name or word ID every 15 mins. This CJBC-177?
2306	WHUG	101.7	NY Jamestown prob. k, ID	0237	CKLA	106.1	ON Guelph r, "K-106"
2315	WUOM	91.7	MI Ann Arbor MI nx	2100	Boston		Boston and New England very strong
2332	WDUQ	90.5	PA Pittsburgh ID	2116	WHOM	94.9	NH Mt. Washington m
2335	WSHH	99.7	PA Pittsburgh m	2132	WBRK	101.7	MA Pittsfield "K-102 in Pittsfield" Still WBRK?
2341	WDSY	107.9	PA Pittsburgh k, ex-WEEP	2203	WNEX	103.7	NH Keene m
2343	WADV	106.5	NY Buffalo	2300	WECM	106.1	NH Claremont WECM-WTSV ID

I really didn't think I'd be sending another report in this year. However, with some of the best tropes in memory on 9/12 and 9/13, I think a report is called for.

73, Joe

\* \* \* \* \*

Paul Mount - 35 1/2 W. Columbus St. - Nelsonville, OH 45764

RX: Sanyo H9980

## From Teaneck, NJ:

9/10 tr 2258 WHP 97.3 PA Harrisburg m  
 9/11 tr 0055 WFLJ-95.5, WYNY-97.1, WCBS 101.1 all New York City off  
 0057 WFGC 95.5 MD Morningside r, weak  
 0100 WKCI 101.3 CT Hamden r "KC-101"  
 0104 WQVR 101.1 PA Philadelphia m, "The place to relax"  
 0128 WLAN 96.9 PA Lancaster r, "FM-97" automated (TM?)  
 0130 WFFG 96.9 NJ Atlantic City m

## Back in Nelsonville, OH:

9/15 tr 0140 WLAP 94.5 KY Lexington talking, rp ORN  
 0212 WKKW 106.5 WV Clarksburg k  
 0228 WHAJ 104.5 WV Bluefield m, "\$-104"  
 9/18 tr ?? WTOP 98.1 OH Canton g  
 ?? WGCL 98.5 OH Cleveland r  
 ?? unID 99.3 g QRMing WIBZ's rp  
 9/23 tr 2330 WSLQ 99.1 VA Roanoke State 7  
 2344 WUBE 105.1 OH Cincinnati "No. 1 country, UBE FM-105"  
 2349 WPEZ 94.5 PA Pittsburgh Alien Worlds  
 2355 WSAI 94.1 OH Cincinnati rS  
 2359 WFCJ 93.7 OH Miamisburg s/off  
 9/24 tr 0011 WROA 94.3 OH Marietta s/off, very weak  
 0013 WBZI 95.3 OH Xenia r, "I-95"  
 0016 WDJX 103.9 OH Xenia r  
 0050 WMEE 97.3 IN Ft. Wayne r, "WMEE-FM Magic-97"  
 0054 WXBQ 96.9 ?? "Country Lovin' for the Tri-Cities"  
 (This is in Bristol, TN - ex-WFHG-RS)  
 0055 WBKW 99.5 WV Beckley g  
 0202 KDKA 92.9 PA Pittsburgh m (Recently changed calls and are  
 now WPNT "The Point-FM-93"-RS)  
 9/25 tr 0912 WCPI 98.7 WV Wheeling r  
 0913 WKWK 97.3 WV Wheeling r, "14 WK & WK-FM"  
 0928 WSGS 101.1 KY Hazard local spots  
 1000 WXYZ 100.9 OH Waverly r, "Wixy" ABC/C nx  
 2200 WSLQ 99.1 VA Roanoke rp, typical Burkhardt/Abrams ID  
 2207 WSIP 98.9 KY Paintsville r  
 9/29 tr 2000 WZZP 106.5 OH Cleveland r  
 2000 WKKW 106.5 WV Clarksburg k

In Communications Systems class at school we've learned propagation. Every now and then the instructor will touch on FM/TV DX. He said, "Some of you may have been lucky enough to see Texas TV, but don't expect to see it everyday." I showed him the January 78 10th anniversary edition which he read over a weekend. Then commented that he found it interesting, but he doesn't get to see articles about that kind of thing often enough. Maybe he should see CB magazine which I read in Kroger's. I'm again working at WLGN 98.3. Hear us? I want to know about it. Paul Mount

\* \* \* \* \*

Harry J. Hayes - Star Route, Box 226c - Gouldsboro, PA 18424

Equipment: Zenith Trans Oceanic on FM-4G Fincold antenna w/CM amp.

9/1 tr 1520 WAQY 102.1 MA Springfield r, "Walkie-102" fair 170  
 1800 WPBH 90.5 CT Middlefield NPR, excellent signal 155  
 1906 WTSR 91.3 NJ Trenton r, "The Alternative" 80  
 9/8 tr 1600 WOOK 100.3 DC Washington s 190  
 9/9 tr 1114 WOEL 88.3 MD Elkton religion, church service 130  
 1200 WCRH 90.5 MD Williamsport end sermon into c 160  
 1657 WXXI 91.5 NY Rochester NPR 180  
 1700 WQLnt 91.3 PA Erie 200  
 1757 WJRT 91.1 ON Toronto ending Sunday Journal 255  
 1808 WAVR 102.3 NY Waverly m 80  
 1816 WFNy 102.1 ON Brampton r, ID 270  
 1845 WJBO 97.1 ON Belleville m, spots for Canada, no ID  
 9/13 tr 2130-2300 Caught a super intense tr opening in progress to  
 Boston area. Unfortunately, I was in Wilkes-Barre PA at the  
 time with just my RX w/indoor whip antenna.  
 2255 WXS 107.9 MA Medford blasting into downtown Wilkes-Barre  
 through the high mts. to the east w/disco and a Mork look-alike  
 contest. (yeeecchhhh!) "Kiss-108" non-ID  
 2300 WLWH 93.7 CT Hartford rare in Wilkes-Barre  
 2200-2300 WCVB-5 dominating over WNEW-5 NYC on the local cable  
 system. Full color and good sound at times. Truly amazing!

Harry Hayes cont'd:

9/15 tr Back at Gouldsboro:

0934	WDSY	107.9	PA	Pittsburgh km, "This is Daisy"	200
1542	WTYD	100.9	CT	New London in fair briefly	180
1600	WCIB	101.9	MA	Falmouth o/WPIX, football game, good	260
1700	WCOB	94.9	MA	W. Yarmouth Boston-Detroit BB, good	270
1701	WJFD	97.3	MA	New Bedford blasting in w/SS	240
1702	WCOZ	94.5		and WEEI 103.3 Boston also in but much weaker than S. MA stations.	

September has not been such a hot month for me. Seems that the best openings have been happening during the week when I'm not here. I forgot to mention it the last time, but I thought Don Blevins and Tom Yingling did an excellent job in getting people to and from the airport, bus station, etc. at the convention. Also a great convention, guys.

\* \* \* \* \*

Ralph Strobel - 2510 E. McGalliard Rd. - Muncie, IN 47303  
Equipment: Heath AJ-1510, Winegard antenna w/rotor at 60 ft.

On October 11, I received a gigantic report from Frank Merrill of Toledo, OH. Since it is 4½ pages of solid DX, and due to the fact I am behind schedule, this interesting report will appear next month. Frank outdid us all for the month of Sept. and has increased his total to 823. The only new stations I've heard since last month was on 9/24. They are WQLT 107.3 Florence AL and KTJJ 98.5 Farmington MO. Many relogs were heard in Sept. I finally heard a full legal ID from WHRK 97.1 -73 "K-97" at 0354 on 9/24. Much more next month. (WHRK is in Memphis, TN) Total: 808 ~~844~~

\* \* \* \* \*

## STATION BREAK

WTFDA Headquarters  
Post Office Box 97  
Calumet City, IL 60409

WTFDA member ads only. 3 line or 30 word limit.

FOR SALE - Heathkit AJ-15 manual consisting of schematics, parts layout, operation & assembly drawings. Mint condition - \$5 postpaid. John Kbeling, 9209 Vincent Avenue South, Bloomington, MN 55431.

FOR SALE - Heathkit AJ-1510, AJ-15, AR-15 tuning units. This is parts # 110-39 & 110-61. These are surplus-unused-mint condition-guaranteed. Write for dirt cheap prices. Andy Bolin - 709 Lincoln - Charleston IL - 61920

Your non-commercial ad can appear in the VUD free of charge! Got a piece of gear you'd like to sell? Looking for something? Advertise in STATION BREAK.

INTERNATIONAL NOTES features Mexico's Net-13 TV stations...plus TV skeds from Italy, Turkey, and El Salvador

PHOTO NEWS shows you a rare catch from the Canadian Maritimes

A simple yagi antenna for DXing foreign TV signals below 54 MHz

How two hurricanes helped to bring super tropo conditions to part of the North American continent

NEXT MONTH  
in the V.U.D.



# SOUTHERN • F M D X

Danny Buntin, editor  
1312 N. Skyline  
Stillwater, OK 74074

NOVEMBER, 1979

DEADLINE: the 9th

\* MAJOR SEPTEMBER TR OUTBREAKS RANGE UP TO 920 MILES \*

One lucky reporter and to a lesser extent a few others got into some big time tr ducting during the Sept. 9-13 period. The best opening stretched along the eastern base of the Appalachians and continuing to the Gulf coast, reaching a maximum reported distance of 920 miles. Beyond that mileage is only open water so probably the maximum mileage in that opening was never realized. Another high point came when a sub class A station was heard in stereo from 720 miles. While not as impressive with its mileage figures, another opening was remarkable for going strong all day long after a mid-morning start, in fact strong enough to overload the dxer's rx. Another nice opening was noted by at least one reporter on the 26th. Hurricane Fredrick evidently ended the tr first mentioned.

Some early "Indian summer" Es was noted Sept. 1. As can be expected no other skip days were noted during September.

Neil Dickerson, 426 State St., Sharptown, MD 21861 - Aug. 9 to Sept. 13  
Eqpt.: Panasonic Technics SA-5570 w/two Channelmaster ant.s stacked at 50 ft., rotor

8/9 tr  
2000 WCHR 95.3 NC Wanchese 210

8/13 tr  
1800 WQDX 94.1 PA Sunbury, "Super QKS" 150  
1830 WKZ 95.1 PA Chambersburg 180

8/17 gw  
2030 WNUC 88.1 MD College Park  
(new on the air, heard on Et. 10 watts)

9/1 Es  
1700 KUHF 88.7 TX Houston 1275  
1710 KFJZ 97.1 TX Ft. Worth 1300  
1715 KYKR 93.3 TX Port Arthur 1250  
1730 KAUM 96.5 TX Houston 1275  
1738 KKNG 92.5 OK Oklahoma City, "King Stereo 92"  
1745 DVTT 91.7 TX Dallas 1300  
1758 KUT 90.5 TX Austin 1380  
1800 KBFL 90.3 MO Buffalo 950  
1820 KNGS 94.9 TX Arlington 1300  
1830 WBYU 95.7 LA New Orleans 1000  
1830 WAFB 98.1 LA Baton Rouge 1075  
1845 KLAW 101.5 OK Lawton 1330

9/9 tr  
1730 WKAR 90.5 MI East Lansing 550  
1800 WMBI 90.1 IL Chicago 675  
1800 WAUS 90.7 MI Berrington Springs 635  
1830 WVPE 88.1 IN Elkhart 600  
1845 WLOS 99.9 NC Asheville 450  
1900 WCDR 90.3 OH Cedarville 450  
1930 WSPR 90.1 SC Greenville 460  
2000 WCSG 91.3 MI Grand Rapids 625  
2130 WVCM 91.7 MI Ann Arbor 500

9/10 tr  
0055 KMMU 90.7 MO St Louis 810  
1400 WLET 106.1 GA Toccoa 520  
1420 WMIT 106.9 NC Black Mountain 440  
1445 WAUG 105.7 GA Augusta 520  
1500 WFMX 105.7 NC Statesville, k 350  
1530 WVEE 103.3 GA Atlanta, "V-103" 600  
1600 WSPA 98.9 SC Spartansburg, "FM 99"

9/10 tr  
1638 WLOS 99.9 NC Asheville 450  
1700 WKLS 96.1 GA Atlanta, "Stereo 96" 600  
1730 WLTA 99.7 GA Atlanta, m 600  
1745 WEAS 93.1 GA Savannah 570  
1800 WRAS 88.5 GA Atlanta 500  
1820 WEZL 103.5 SC Charleston 500  
1830 WNGC 95.5 GA Athens 560  
1900 WVPE 91.7 WV Beckley 310  
1925 WDEN 105.3 GA Macon 625  
1945 WBTE 101.5 GA Marietta 600  
2000 WBHM 90.3 AL Birmingham, c 725  
(state #25 for tr)  
2:15 WTOG 94.1 GA Savannah 570  
2030 WREK 91.1 GA Atlanta 600  
2045 WJCL 96.5 GA Savannah 570  
2056 WLAT 104.1 SC Conway 400  
2100 WSGF 95.5 GASavannah 570  
2120 WCKT 100.3 TN Oak Ridge, r, "FM 100" 500  
2130 WAGC 90.7 GA Augusta 520  
2200 WPJS 106.7 SC Orangeburg, g 480  
2218 WSIP 98.9 KY Paintsville 450  
2230 WMC 99.7 TN Memphis, r 855  
2245 WCJM 100.9 GA West Point 680  
2300 WSMC 90.7 TN Collegedale, g 610  
2320 WXFL 100.5 ? ? ?  
2350 WDDM 101.3 SC Sumter 460

9/11 tr  
0000 WQSI 100.9 AL Union Springs, legal ID (r, "FM 101") 725  
0035 WNCW 101.7 GA Albany 690  
0045 WBAM 98.9 AL Montgomery 750  
0100 WBLX 92.9 AL Mobile, legal ID 920!  
0130 WVOG 90.5 GA Athens 560  
0150 WSHV 105.5 VA South Hill, local WRAR off  
0200 WAIM 101.1 SC Anderson, "Rock 101" 500  
0210 WKXX 106.9 AL Birmingham 725  
1730 WGTE 91.3 OH Toledo 470  
1800 WMBI 90.1 IL Chicago 675  
1830 WVPE 88.1 IN Elkhart 600  
1900 WWSA 89.9 WI Burle 830  
2000 WHAD 90.7 MI Delafield 800  
    WWGA 100.9 GA Waynesboro, g 575

more great tr cont.....

9/12 tr			
0900	CJRT	91.1 ON Toronto	430
0902	CKPC	92.1 ON Brantford, k	410
0930	CBE	89.9 ON Windsor, c	470
1000	CFPL	95.9 ON London, progressive	425
1000	CBCL	93.5 ON London, CBC	425
1020	CHXK	101.7 ON Wingham	490
1030	WBUP	92.9 NY Buffalo	360
1045	CFMP	101.5 ON Peterborough	440
1100	CHAY	93.1 ON Barrie	470
1100	CBL	94.1 ON Toronto	430
1115	WFFX	101.3 MI Grand Rapids	625
1130	WDVE	102.5 PA Pittsburg	260
1145	WVCC	101.7 PA Linesville	325
1200	WCCK	103.7 PA Erie, r, "K-104"	345
1200	WWMM	105.7 OH Cleveland, r	390
1210	CFCA	105.3 ON Kitchener	440
1215	WGOJ	105.5 OH Conneaut	360
1230	CKLA	106.1 ON Guelph, m, "FM 106"	440
1245	WIVB	102.5 NY Buffalo	360
1250	WZPR	100.3 PA Meadville, m	320
1300	WYFM	102.9 PA Sharon, "Y-103"	310
1315	WLWU	99.9 PA Erie, m	345

9/12 tr			
1315	CKFM	99.9 ON Toronto	430
1330	WELA	104.3 OH East Liverpool	300
1335	CHUM	104.5 ON Toronto, "CHUM FM"	430
1355	WBIV	107.7 NY Wethersfield	310
1400	GING	107.9 ON Burlington, m, "FM108"	430
1400	WGPR	107.5 MI Detroit	470
1406	WMDI	102.3 PA McKean, progressive	330
1418	CFWY	102.1 ON Toronto, r	430
1420	WWKS	106.7 PA Beaver Falls	280
1430	WDET	101.9 MI Detroit	470
1441	WHUC	101.7 NY Jamestown	320
1455	WLAR	101.5 OH Toledo, m	470
1500	CKOT	101.3 ON Tillonsburg	450
1508	CBEE	95.1 ON Chatham	430
1511	WCMC	104.3 MI Detroit, r	470
1520	WCED	102.1 PA Dubois, r	280
1530	WJAC	95.5 PA Johnstown, m	225
1545	WVOR	100.5 NY Rochester, r	325
1600	WCLT	106.1 NY Corning	260

9/13 tr			
0900	WCNY	91.3 NY Syracuse	330

What a Blast! Over 80 new stations added to the log in a few days thanks to the splendid tr! The tr! I don't think another opening such as the 9/10 and 9/12 openings will ever be repeated here. First caught on to the 9/10 opening when I heard WLRG 92.3 instead of WLPL on my car radio. Quite a trip hearing WLTA 99.7, WKLS 96.1 and WLMT 106.1 all 600 miles away in perfect stereo in the afternoon. My tr record was broken three times. First KWMU (810 mi.) then WMC at 855 mi. and finally WBLX at 920 mi. Quite a shock hearing WQSI 100.9, a class A station, at 725 mi. in stereo. When I went to bed at 0230 most Atlanta and Savannah stations were still in. I thought I had heard the ultimate tr opening until 9/12 when the tr came in from the north. Although not as deep as the 9/10 opening, most all Toronto stations pegged the meter in stereo. Some like CHUM 104.5, CKLA 106.1, and CJRT 91.1 came in so strong they overloaded my receiver. Thus after three years of FM dxing, I finally got my two dream openings. And I thought the season was over! Hope everybody got in on it.

TOTALS: 965 stations, 40 states, six provinces plus 356 stations taped from 34 states and four provinces.

Randall B. Clark, RT9 Box #231 (Dutch Ridge), Parkersburg, WV 26101 - Sept. 1 to Oct. 1

Using a Realistic STA-42 with a 3 ft. long antenna up at 45 ft. above ground level... five miles east of Parkersburg, WV (one mile shy of WJLL 95.1!). Time in EDT (1-304-422-2923)

9/1			
2105	KASE	100.7 TX Austin (Kasie-100 ID)	
2119	KPYI	100.7 TX Mt. Pleasant	
2135	unID	Mexican (Spanish) stn in on 104.5	
opening dropped out rather fast by 2150			
9/4			
1400	WBRN	100.9 in tentative	
2210	WBBI	90.1 IL Chicago	
9/5			
1120	WDET	101.9 MI Detroit	
9/6			
0954	CJOM	88.7 ON Windsor	
2350	WOKU	107.1 PA Greensburg, d	
9/8			
1659	WLOS	99.9 NC Asheville, stereo at 1950	
2009	WEZC	104.7 NC Charlotte	
9/9			
0106	WYFM	102.9 & WELY (now WAZU) both in	
1838	WRIF	101.1 MI Detroit	
1900	WPIT	101.5 PA Pittsburg, o/WYPC!	
2155	WKDD	96.5 OH Akron	
9/10 (start of "SUPER TROP" period)			
0003	KWMU	90.7 MO St. Louis	
0029	WEPR	90.1 SC Greenville, (state #20)	
0052	CJOM	88.7 ON Windsor, back in	

9/10 tr			
0059	WIBI	91.1 IL Carlinville	
(that makes all E-FM freqs. received here!)			
0201	WKAR	90.5 MI East Lansing	
0202	WILL	90.9 IL Urbana	
0241	WTLG	105.7 IN Indianapolis	
0248	WBNO	101.5 IL Bloomington	
0256	WGCI	107.5 IL Chicago	
0305	KTXR	101.5 MO Springfield	
(my farthest tr yet!)			
0316	WHJY	100.5 IL South Bend	
0339	KMOX	103.5 MO St. Louis	
0332	WGRT	107.1 IN Danville	
(popped out by 0405!!)			
1902	WFFK	91.9 KY Louisville	

9/11			
0000	WIVK	107.7 TN Knoxville	
0005	WSMC	90.7 TN Collegedale	
0029	WMPR	88.1 SC Sumter	
0031	WUOT	91.9 TN Knoxville	
0104	WMBW	88.9 TN Chattanooga	
0143	WBKR	92.5 KY Owensboro	
0200	WVXU	91.7 OH Cincinnati, (heard s/off)	
0228	WVHI	105.3 IN Evansville	
cont.			

9/11

0232 WFMX 105.7 NC Statesville  
 0300 WSAC 105.5 KY Fort Knox  
 (popped out by 0315!)

1301 WDMT 107.9 OH Cleveland, "Disco 108"  
 2001 WKSU 89.7 OH Kent  
 2309 WKNT 100.1 OH Akron

9/12

0000 WPEM 92.1 PA Elwood City  
 0259 WWWW 105.7 OH Cleveland  
 (failed to even ID at 0300, used "M-105"  
 non-ID....0333 to bed!)

1040 WKJJ 99.7 KY Louisville, "KJ-100"  
 1654 WGMR 101.1 PA Tyrone  
 1959 WBTV 103.7 NY Ithaca, (state #21!)  
 2131 WJAC 95.5 PA Johnstown  
 2146 WOTY 100.9 NY Horseheads, (class A!)  
 2305 WBIV 107.7 NY Wethersfield Township  
 2230 WFRB 105.3 MD Frostburg

9/13

0192 WEZO 101.3 NY Rochester  
 0202 WPAT 93.1 NJ Patterson, tent  
 0335 to bed!, left for Charleston, WV at  
 4:30 am 9/14, so assumed Hurricane  
 Fredrick took care of the SUPER TROP!  
 Also at 0304 WYSO 91.5 OH Yellow Springs

9/22

0105 WUCM 91.7 MI Ann Arbor  
 0197 WETA 90.9 DC Washington  
 0131 WDOX 102.1 OH Cleveland  
 0145 WKSW 99.5 OH Cleveland

9/23

1530 WKPT 98.5 TN Kingsport  
 1705 WLWQ 96.3 OH Columbus, no nuke mx fest.  
 1800 WXBQ 96.9 TN Bristol  
 1840 WXCC 96.5 WV Williamson, "Coal Country"  
 2030 WYES 91.9 PA California  
 2100 WKYS 93.9 DC Washington

9/24 (a rather surprising duct)

1010 KTTJ 98.5 MO Farmington  
 1055 WILL 90.9 IL Urbana  
 1100 WSIU 91.9 IL Carbondale  
 2209 WTRF 107.3 IN Greensburg

9/25

2200 WKOY 96.7 OH Wellston

9/27

0100 WUNC 91.5 NC Chapel Hill

9/29

1659 WGLI 98.5 OH Cincinnati (new calls)

9/30

2353 WRJA 101.3 IN Richmond

10/1

0028 WLOP 101.5 OH Toledo

0103 WHKK 100.9 KY Erlanger

0200 WWEZ 92.5 OH Cincinnati

Hello everyone! Well, my STA-42 receiver's pulling in the stations pretty good as noted by my log. I finally snagged a state that I thought I'd never hear--New York!.... and to top it off a class A station.

I now note seven stations in the area on with overprocessed audio, what I'd term--"Fidelity Overkill". This is most evident in the Pittsburg area. (Seems like no one wants to hear TRUE hi-fidelity anymore!)

For all of you out there who are looking out for TV Audio--BBC/a. It was just heard Sept. 24th for two hours. That is three weeks earlier than last year's reception date! Seems like we'll be in for a fairly good F2 season--I hope.

It's been a year and a month since I first contributed to Southern FM, so I thought I would tip my hat off to Danny Buntin for doing such a wonderful job of column editing since I've been in WTFDA! (Thank you. And my thanks go to those who have contributed to SFM, making it the best SFM since I've been in WTFDA. DB)

Jim Pizzi, 300 Park, Orcutt, CA 93454 - March 1 to July 30 PST

4/17 Es

1150 KACV 89.9 TX Amarillo, tent, brief  
 1220 KLYT 88.3 NM Albuquerque, r, ID  
 1236 KTEP 88.1 TX El Paso, nx, \$

5/4 Es (most all Es)

2126 KBBK 92.3 ID Boise, r, \$

5/12

1828 KNFM 92.3 TX Midland, m

5/18 gw

---- KIQO 104.5 CA Atascadero, r, local 45m.

6/12

1201 KOCV 91.3 TX Odessa  
 1202 KNFM 92.3 TX Midland  
 1203 KBUY 94.1 TX Amarillo, r

6/23

1035 KULL 94.5 KS Scott City, KS IN NET

6/23

1750 KVRN 92.1 TX Sonora, k, mono  
 1802 KFIM 92.3 TX El Paso, r  
 1805 KXDX 96.7 TX Sweetwater, r

6/26

1133 KURL 97.1 MT Billings

7/4

2156 CKLG? 99.3 BC Vancouver, "C-FOX" ??  
 2158 CFMI 101.1 BC New Westminster, r  
 2159 CJQC 103.5 BC Vancouver  
 2200 KYYX 96.5 WA Seattle  
 2201 KISM 92.9 WA Bellingham, r, \$  
 2210 KANW 89.1 NM Albuquerque, s/off  
 2211 KRST 92.3 NM Albuquerque

7/30 tr

2007 ??? 94.7 SS-live DJ (reverb mike)

This season has been very poor, not many days of FM Es or very good tr. Now working for General Telephone Co. as a directory assistance operator. My hours are different every day--difficult to find time to DX.



Edward R. Cotton, 4106 2nd St., Chesapeake, VA 23324 - May 2 to Sept. 12

Equip.: Pioneer TX6500 II, outside S type antenna 18' high

Es more plentiful this year than last. Tropo was the best ever noted here. Tropo into NYC and NE was the most intense and farthest ever seen here in May and June. List includes new loggings only, no relogs.

5/2 tr

2135 WEAA 88.9 MD Baltimore  
2147 WWTR 95.9 DE Bethany Each  
2233 WDSO 94.7 DE Dover  
2311 WCTD 107.1 MD Federalsburg, nx

5/20 tr

2304 WBJC 91.5 MD Baltimore, c

5/22 Es

1725 KROZ 92.1 TX Tyler, k  
1737 KAFM 92.5 TX Dallas, ad for TV 5  
1741 KLIS 94.3 TX Palistine  
1745 KOTN 92.3 AR Pine Bluff  
1751 KSEO 107.1 OK Durant  
1752 KOFM 104.1 OK Oklahoma City, nx  
1755 KKEG 92.1 AR Fayetteville  
1757 KKGK 92.5 OK Oklahoma City, stock rt.  
1800 KOSU 91.7 OK Stillwater  
1800 KCSC 90.1 OK Edmond  
1810 KRKQ 104.9 MO Carthage, ABC nx  
1816 KYFM 100.1 OK Bartlesville, local nx  
1930 KVTY 91.7 TX Dallas, g  
1947 KSYN 92.5 MO Joplin  
1950 KWEN 95.5 OK Tulsa, "Queen 95"  
2000 KBFL 90.3 MO Buffalo, HS radio sta.  
2000 KOCB 90.7 MO Joplin  
2001 KKBL 95.9 MO Monett  
2010 KGOW 92.1 OK Broken Arrow, k  
2022 KYKX 105.7 TX Longview  
2050 KIXS 93.3 TX Killeen  
2110 KTXR 101.5 MO Springfield, BB game  
2120 KARD 107.3 KS Wichita  
2125 WDDD 107.3 IL Marion  
2140 KSWT 107.7 KS Topeka

5/30 Es

2050 KQID 93.1 LA Alexandria, "93 QID"  
2057 WQST 92.5 MS Forest, curley Q show

6/2 tr

2044 WKTU 92.3 NY NYC, "Disco 92", ID  
2145 WKDN 106.9 NJ Camden, g  
2153 WAFL 97.7 DE Milford, k  
2246 WDVN 101.1 PA Philidelphia, m  
2344 WJMD 94.7 MD Bethesda, "FM 94"  
2346 WLPL 92.3 MD Baltimore, "92-FM"

6/3 tr

0000 WCVT 89.7 MD Towson, s/off  
0002 WJBR 99.5 DE Wilmington  
0029 WKYV 102.7 MD Baltimore, "V-103"  
0732 WOEL 88.3 MD Elkton  
0920 WAQA 103.1 MD Grasonville

6/8 tr

0616 WCSE 92.3 NC Ashboro  
0642 WANS 107.3 SC Anderson  
0705 WNUU 94.5 SC Greenville, g  
0700 WESC 92.5 SC " " "  
0701 WEPR 90.1 SC  
0715 WEZC 104.7 NC Charlotte  
0723 WTQR 104.1 NC Winston-Salem  
(heard on car radio on way to work)

6/9 tr

0716 WGAY 99.5 DC Washington, "Beautiful 99"  
0806 WBCY 107.9 NC Charlotte, nx

6/10 tr

0726 WLRB 92.7 DE Rehoboth Beach  
2120 WCOZ 94.5 MA Boston, "Rock 94"  
2217 WMJS 92.7 ME Prince Fredrick, wx  
2241 WMMR 93.3 PA Philidelphia, m  
2358 WAAP 107.3 MA Worcester

6/11 tr

0005 WPJB 105.1 RI Providence, "JB 105"  
0016 WSRS 96.1 MA Worcester, ads  
0040 WWYZ 92.5 CN Waterbury, "YZ"  
0054 WALK 97.5 NY Patchogue  
0055 WODQ 97.5 NH Dover, in WALK fade  
0114 WJTB 96.9 MA Boston  
0121 WBLM 107.5 ME Lewiston, ann. of  
"Lingerie Fantasy Contest"  
0201 WWOC 94.3 NJ Avalon  
0203 WYSP 94.1 PA Philidelphia  
0205 WPOR 101.9 ME Portland, nx briefs  
0217 WGMG 103.7 NJ Atlantic City, "Rock 104"

6/13 Es

1918 KOEZ 92.3 KS Newton  
1938 KDSA 91.1 KS Wichita, ID

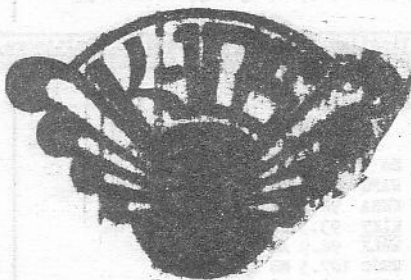

6/16 tr

0245 WDAC 94.5 PA Lancaster  
0300 WSBA 103.3 PA York-Lancaster, m  
0344 WCAU 98.1 PA Philidelphia  
0800 WGBB 96.1 PA Red Lion, wx  
1604 WAYV 95.1 NJ Atlantic City  
1630 WSLT 106.3 NJ Ocean City, "Stereo 106"  
1816 WWCS 106.9 MD Hagerstown  
1855 WTRR 100.7 MD Westminster  
(mentioned vacation post card contest)

6/23 tr

0605 WRQR 94.3 NC Farmville, s/on, "Q 94"  
1617 WRRZ 107.1 NC Clinton, wx

6/24 Es

1913 KLEF 94.5 TX Houston  
1920 KSNB 96.1 LA Lake Charles  
1925 KXKZ 102.5 LA Ruston  
1933 KJOS 103.3 TX Nacogdoches  
1936 KWIC 107.7 TX Beaumont

cont.

6/24 Es  
1941 KIOC 106.1 TX Orange, "K-106"  
1945 KVIL 103.7 TX Dallas  
2054 KTEN 93.3 OK Ada, K-10-FM

6/29 Es  
1706 WIAM 93.3 WI LaCrosse  
tr  
2035 WMYS 98.1 MA New Bedford  
2149 WRCN 103.9 NY Riverhead  
2212 WCCG 106.9 CN Hartford, "CCG-FM"  
2220 WKKS 107.9 MA Hartford, "Kiss 108"  
2247 WPLR 99.1 CN New Haven  
2315 WBLI 106.1 NY Pachogue

6/3 tr  
0016 WQQQ 100.9 NC Wilmington  
(calls itself Wilmington's Double Q)

7/2 tr  
0640 WAZZ 101.9 NC New Bern, "country ways"  
1816 KUHF 88.7 TX Houston  
1825 KALO 95.1 TX Beaumont, "K-Low-95"  
1925 KYKR 93.3 TX Port Arthur

7/3 Es  
1511 WKHP 96.9 ME Presque Isle

7/5 Es  
1755 CFQM 103.9 NB Moncton  
1800 CKWM 97.7 NS Kentville, m  
1805 CBC 96.9 PE Charlottetown, nx  
1910 CHOZ 95.9 NF St. Johns, "Radio Oz"  
1900 GJCB 94.9 NS Sydney, "Stereo 95"

7/7 Es  
1545 KNEN 94.7 NE Norfolk  
1615 KEZO 92.5 NE Omaha, "Z-92"

7/9 tr  
2336 WSNJ 107.7 NJ Bridgeton  
7/11 tr  
0640 WESP 106.3 MD Cambridge  
7/15 Es  
1750 WORO 92.5 PR Corozal. ID in spanish  
7/21 Es  
1948 KRLT 94.5 TX Harlingen, "FM-95"

8/2 Es  
1949 WKUX 92.7 WI Waupaca  
8/4  
(WEXM Exmore, VA on 107.9 for two days, back  
on 107.5 Monday morning)

8/7 Es  
1730 WOI 90.1 IA Ames

9/10 tr  
2044 WLRG 92.3 VA Roanoke, "Large Radio"  
2055 WWWV 97.5 VA Charlottesville, "3WV"  
2105 WMIT 106.9 NC Black Mountain, c  
2130 WMBW 88.9 TN Chattanooga, g  
2136 WWID 106.7 GA Gainesville, "Wide 107"

9/11 tr  
0647 WTTX 107.1 VA Appomattox, "Big T country"  
0700 WSHA 88.9 NC Raliegh  
1900 WVPR 88.9 SC Rock Hill, nx  
1930 WSPA 98.9 SC Spartanburg  
9/12 tr  
0656 WPCM 101.1 NC Burlington

Tom Yingling, jr, 221 Pinewood Rd, Baltimore, MD 21222 - June 3 to Sept. 13 EDT  
Equip.: Pioneer TX-9100, Channel-Master Probe-9 up 50 ft.

6/3 Es  
KROK 94.5 LA Shreveport (at 2052)

6/24 Es  
1510 WAFG 90.3 FL Ft. Lauderdale  
1530 KERA 90.1 TX Dallas  
1800 KIKT 93.3 TX Greenville  
1810 WBLX 92.9 AL Mobile  
1832 WSJC 107.5 MS Magee  
1840 WGUF 96.7 MS Gulfport  
1900 KWIC 107.7 TX Beaumont  
1905 KHOO 99.9 TX Waco  
1915 KOAX 105.3 TX Dallas  
1925 KATT 100.5 OK Oklahoma City, KATT-100  
1930 WXEL 105.3 LA Slidell  
1934 WTGI 103.3 LA Hammon  
1950 KTFK 106.9 KS Topeka  
1954 KEPT 96.7 LA Shreveport  
2000 KJSC 103.3 TX Nacogdoches  
2010 WYNK 101.5 LA Baton Rouge  
2030 KGRC 92.9 MO Hannibal

6/28 Es  
2100 KISR 93.7 AR Ft. Smith, on car radio  
2115 KEZQ 94.1 AR Little Rock, IDs as  
"Magic-94, at home now & IDs as "KQ-94"

6/29 Es  
1600 WNJC 90.1 MS Senatobia  
1630 WFLN 90.2 TN Nashville  
1640 WKMS 91.3 KY Murray  
1645 KBFL 90.3 MO Buffalo

6/29 Es  
1650 KSAU 90.3 TX Nacogdoches  
1700 KVLU 91.3 TX Beaumont

6/30 Es  
1158 KSJN 91.1 MN St. Paul  
tr  
1400 WPTG 90.3 PA Lancaster  
Es  
1600 CBNM 90.3 NFD Marystown  
tr  
1725 WIOK 98.3 NY Hempsted  
1730 KMRJ 96.9 KS Pittsburgh  
1737 KWFC 97.3 MO Springfield  
1738 KWTX 97.5 TX Waco  
1800 KXCV 90.5 MO Marysville  
1810 KUT 90.7 TX Austin

7/5 Es  
1700 CKMF 94.3 PQ Montreal  
1720 CBN 106.9 NFD St. Johns  
1730 CBNM 90.3 NFD Marystown

7/7 Es  
1500 KNED 101.3 OK McAlester  
1510 KJLS 103.3 KS Hayes  
1515 KBLF 90.3 MO Buffalo  
1530 KFPI 101.3 KS Wichita  
1540 KMOD 97.5 OK Tulsa  
1545 KGFX 103.3 SD Pierre, new station  
1600 KBRX 92.7 NE O'Neill  
1630 KUT 90.7 TX Austin, CONT.....

7/20 tr  
0100 WJRZ 100.1 NJ Shipbottom  
0115 WRCH 100.5 CT New Haven  
0130 WPLR 99.1 CT New Haven

7/27 Es  
2000 KBID 92.9 TX Wichita Falls  
2010 WAQT 94.1 AL Aliceville  
2030 WQST 92.5 MS Forrest

8/7 Es  
1600 KSCS 90.1 OK Edmond

9/6 tr  
2300 WKTC 104.3 NC Tarboro, local off air  
2330 WBCY 107.9 NC Charlotte, new call  
2400 WDJF 107.9 CT Bridgeport

9/13 tr  
0000 CBL 94.1 ON Toronto, ID is CBC  
0030 WJTV 96.1 NY Buffalo, new call?? WBNY ex  
0045 WPHD 103.3 NY Buffalo  
0100 WLQR 101.5 OH Toledo  
0115 WFOR 100.5 NY Rochester  
0200 CKO-FM-2 99.1 ON Toronto

This is all for now. I misplaced some of my skip notes, so my skip loggings may look weak. This year was better for skip on FM than last year. Since I DX FM skip for QSLs my number of loggings are less than those who just DX for hearing the call sign, and then go to another frequency. I did this last year and got many new loggings, but not many QSLs as this year. 73.

Rick Samford, 404 S. McNeill, Burnet, TX 78611 - Sept. 5 to Oct. 4 CDT

9/10 (all tr)  
1024 KTTS 94.7 MO Springfield, k 525  
frequent IDs, "Ozark Country," "The Radio  
Ranch" slogans  
1129 KPCG 103.5 MO Joplin, g 480  
over 3.2 kw reg. KGBR, still in at noon

9/25  
2304 KIKM 96.7 TX Sherman, k 220  
out of local nx; heard before but not  
counted due to the short, insufficient  
nature of the reception

9/26  
0812 KKYK 103.7 AR Little Rock, "k-Kick"  
0818 WMC 99.7 TN Memphis 570  
1827 WEZI 105.9 TN Memphis, "Easy-FM-106"

9/26  
0839 WHRK 97.1 TN Memphis, nx, wx, "k-97"  
0903 KLAZ 98.5 AR Little Rock 445  
0909 KLPQ 94.1 AR Little Rock, ad,  
"KQ-94", local nx and wx

0922 WZXR 102.7 TN Memphis, "Rock-103"  
"T.Y.'s Mornin' in Memphis"

0937 WQUD 104.5 TN Memphis, ad, "Quad-104"  
1032 WQOX 88.5 TN Memphis, nx, wx, "X-88"  
1052 KSSN 95.7 AR Little Rock, promo  
1146 KASU 91.9 AR Jonesboro, wx 560  
1219 WLYX 89.3 TN Memphis, local nx,  
out of ABC Am. FM nx, "Alternative Radio,  
FM-89," another strict nonIDER.

The Memphis signals were much stronger than those from Little Rock during most of the Sept. 26th trop session, with WLYX being the only one too weak for stereo. The opening started to die soon after the WLYX logging, before I could tape that station's call letters or log the more powerful WKNQ, which suffered from KAMU-KNCT QRM.

John M. Jefferson, 4016 Crest Court, Pleasanton, CA 94566 - 8/14-78 to 9/13-79  
(New loggings underlined. Logged in concord before 4/79, Pleasanton after)

8/14 tr (1978)  
0030 97.7 KQEZ CA Shafter, g 225  
10/9 Ms  
0145 93.3 KCB NM Albuquerque 875  
10/20 tr  
1720 89.5 KVMR CA Nevada City, 10w. 118  
12/30 MS  
0058 97.1 KFAM OR Portland, ID 545  
1/27 tr (1979)  
0220 95.9 KSNR CA Red Bluff, ID 150  
1/29 MS  
0300 96.9 KMEO AZ Phoenix, ID 649  
(first logging on freq. since 1961)

2/18 MS  
0300 94.1 KRKE NM Albuquerque, ID 875

BEGINNING OF PLEASANTON ERA. RELOGS TOO  
NUMEROUS TO LIST UNLESS NOTEWORTHY!

5/20 Es  
2005 93.7 KWYR SD Winner, ID 1200  
2010 91.7 KRSW MN Worthington, c 1390

5/20 Es  
2010 95.1 KWOA MN Worthington, wx  
(Lost tape of this due to technical difficul-  
ties, so couldn't verify place names)  
2015 88.3 KESD SD Brookings, local ref. 1340  
2030 93.9 KKHJ SD Rapid City, ID 1060

5/22 tr  
0325 93.1 KNX CA LA, ID 315  
0328 95.5 KLOS CA LA, local ad 315  
0450 91.9 KCSB CA Santa Barbara, ID 245  
(logged on 91.5 in 1970. At the time they had  
a DA, six watts to the north. Probably still  
1635 89.9 KBHI CA Modesto, ID 45

5/28 Es  
2030 92.9 KBID TX Wichita Falls, local ref.  
2035 94.5 KCAF TX Gainesville, nx 1400

5/29 Es  
0845 92.1 KFAH NE Alliance, ID 1020

cont.



5/29 Es  
 0847 92.9 KMCR NE Scottsbluff, nx 985  
 0850 88.3 KESD SD Brookings, c, nx 1340  
 0851 95.5 KSDZ NE Gordon, ID 915  
 0900 93.7 KWYZ SD Winner 1200  
 0915 94.5 KAWY WY Casper, ID 885  
 0940 93.3 CEX? AT Edmonton, c

6/3 Es  
 0005 93.3 CEX AT Edmonton, s/off 1175  
 0007 93.7 CKUA-1 AT Calgary, j, ann. 1025  
 0015 92.9 KREM WA Spokane, ID 750

6/5 (most rest Es)  
 1045 88.3 KLYT?NM Albuquerque, g  
 1045 89.1 KANW?NM Albuquerque, talk  
 1045 92.3 KRST?NM Albuquerque  
 1045 94.1 KRDE?nm Albuquerque, r  
 (signal 4.8 on scale of 5, strongest Es  
 ever noted.)  
 1045 96.3 KHFM NM Albuquerque, c 875  
 (confirmed via phone)

6/8  
 2000 90.5 KXCV MO Maryville, ID 1440  
 2010 91.5 KIOS NE Omaha, c 1395

6/13  
 1056 92.9 KBID TX Wichita Falls, ID 1320  
 1110 93.9 KWLW TX San Angelo, ad 1285

6/15  
 1513 92.3 KFIM TX El Paso, local ad 970  
 1515 99.9 KTSM TX El Paso, ID 970  
 1516 90.7 KRWG NM Las Cruces, ID 940  
 1525 93.9 KPAS TX El Paso, ID as "Pass" 970  
 1530 93.5 KVMW AZ Show Low, local ad 685  
 2105 93.7 KSNM ID Pocatello, ID 600

6/18  
 0830 89.9 KACV TX Amarillo, wx 1115  
 0839 93.1 KQLE TX Amarillo, "Z-93"  
 0917 94.7 KEBC OK Oklahoma City, ID 1355  
 0932 90.1 KCSB OK Edmond, psa 1355  
 0933 92.5 KKNC OK Oklahoma City, ID 1355  
 0945 93.9 KSEI OK Stillwater 1370  
 (slogan & "FM-94"---verified by phone &  
 letter.)  
 0947 91.7 KOSU OK Stillwater, talk 1370  
 0950 89.5 KWGS OK Tulsa, talk 1475  
 0955 95.5 KWEN OK Tulsa, "Queen" unID  
 1000 100.1 KYFM OK Bartlesville, nx 1420  
 1005 92.5 KSYN MO Joplin, ad, wx 1495  
 1010 93.9 KTTL KS Dodge City, ID 1195  
 1013 90.7 KOBC MO Joplin, wx 1495  
 1014 95.5 KGNO KS Dodge City, ad 1195  
 1020 95.1 KICT KS Wichita, local ad 1315  
 1020 94.7 KTTS MO Springfield, ID 1550  
 1021 93.5 KLKC KS Parsons, local nx 1415

6/19  
 1948 93.5 KTTT NE Columbus, ann. 1290

6/23  
 1050 91.1 KDSA KS Wichita, loc. ref. 1315  
 1100 93.1 KWLS KS Pratt, ID 1260  
 1107 89.1 KMUW KS Wichita, opera  
 1110 103.7 KEYN KS Wichita, ID  
 1113 97.9 KBRA KS Wichita, local ad

6/23  
 1125 95.9 KDRB KS Derby 1315  
 1130 93.3 KLMR CO Lamar, wx, local ad 1015  
 1145 92.5 KKNG OK Oklahoma City, ID 1355

6/26  
 0830 92.9 KWBE NE Beatrice, loc. ref. 1350  
 0905 94.7 KTTS MO Springfield, ID 1550  
 0910 93.9 KTTL KS Dodge City, loc. ref. 1195  
 1025 92.3 KEZO NE Omaha, wx 1395  
 1030 93.5 KTTT NE Columbus, ID 1290  
 1032 90.5 KXCV MO Maryville, ID 1440  
 1035 93.1 KRVN NE Lexington, loc. ref. 1195  
 1038 93.5 KIGS NE Hastings, loc. ref. 1250  
 1045 95.3 KBHL NE Lincoln, loc. ad 1330  
 1050 104.9 KAWL NE York, loc. ref. 1330  
 1054 103.9 KTAP NE Crete, loc. ref. 1330  
 1054 106.3 KHAT NE Lincoln, "106-FM in Linc."  
 1100 91.5 KIOS NE Omaha, ID 1395  
 1100 93.5 KTTT NE Columbus, ID 1290  
 1101 99.9 KGOR NE Omaha, ID 1395  
 1105 92.5 KLEO SD Sioux Falls, ID 1370  
 1115 89.7 KUSD SD Vermillion, C 1355  
 1118 95.3 KSID NE Sidney, local ref. 1010  
 1120 97.1 KEIN NE North Platte, loc. ad 1120  
 1120 99.5 KZZL IL Le Mars, ID 1400  
 1124 95.5 KBCM IA Sioux City, local ad 1395  
 1130 92.1 KFAH?NE Alliance, nx  
 1135 94.7 KVNE NE Norfolk, ID 1290  
 1239 92.9 KYYY ND Bismarck, "Y-93" 1230  
 1245 94.5 KQDY ND Bismarck, "QD-94"  
 1330 91.5 KANU KS Lawrence, loc. nx 1400

6/27  
 1030 93.9 KKHJ SD Rapid City, ID 1060  
 1045 100.3 KGGG SD Rapid City, "KG-100"  
 1046 97.9 KVSR SD Rapid City, ID  
 1130 92.9 KBID TX Wichita Falls, ID 1320  
 1131 99.9 KLUR TX Wichita Falls, ID

7/1  
 2022 93.9 KESS TX Ft. Worth, local ref. 1425

7/2  
 1955 93.9 KPAS TX El Paso, Pass unID 970  
 2002 94.7 KSET TX El Paso, ID  
 2005 95.5 KLAQ TX El Paso, unID as the "Q"  
 2015 103.5 XHEM CH Ciudad Juarez, ID  
 2015 104.3 XHTO CH Ciudad Juarez, announc.  
 2016 99.9 KTSM TX El Paso, local ref.  
 2017 96.3 KEZB TX El Paso, ID 970  
 2030 94.3 KDEM NM Deming, ID 885

7/3  
 1245 88.1 KITX TX Lubbock, ID 1150  
 1338 92.9 KBID TX Wichita Falls, ID 1320

7/4  
 1300 90.5 KUAT AZ Tucson, wx 735  
 1300 99.5 KNDE AZ Tucson, g  
 2100 104.7 KVMT CO Vail, ID 835  
 2105 93.9 KTTL KS Dodge City, ID 1195  
 2115 92.3 KRST NM Albuquerque, ID 875  
 2117 93.3 KOB NM Albuquerque, ID  
 2119 99.9 KTQM NM Clovis, ID 1060  
 2120 99.1 KKQQ NM Clovis, ID  
 2121 99.5 KZZX NM Albuquerque, ads 875  
 2125 93.7 KSEL TX Lubbock, ID 1150  
 2135 100.7 KORQ TX Abilene, local ad 1275

7/4			
2135	105.1	KEAN TX Abilene, o/KEWT	
2137	99.1	KKKK TX Odessa, ID	1275
2200	104.7	KCOT TX Lamesa, s/off	1160
2208	97.7	CBUF BC Vancouver, c	820
2210	92.9	KISM WA Bellingham, local ad	775
2212	99.9	KISW WA Seattle	705
2213	99.3	CFOX BC Vancouver, c	820
2214	104.3	KERI WA Bellingham, local ad	775
2215	103.5	CHQM BC Vancouver, chamber mx	
2215	102.7	CPRO BC Vancouver, ann.	820
2216	105.7	CBU BC Vancouver, c	
2224	95.7	KIXI WA Seattle, ID	705
2225	91.5	KOAP OR Portland, c	560
2228	99.1	KPDQ OR Portland, g	
2229	103.5	CHQM BC Vancouver, ann.	820
2230	101.1	CFMI BC New Westminster, ID	820
2231	99.5	KJTB OR Portland, ID	560
2232	97.7	CBUF BC Vancouver, ann.Fr.	820
2240	104.7	KDUX WA Aberdeen, WA psa	660
	93.7	KPDQ OR Eugene, ID	445

7/6			
0958	90.1	KHCC KS Hutchinson, c & talk	1280
1010	94.5	KULL KS Scott City, local ref.	
1015	93.9	KTTL KS Kodge City, local ref.	
1030	92.9	KWBE NE Beatrice, local ref.	1350
		tr	
2325	97.7	KEWE CA Oroville, ID	128
7/11	Es		
1100	90.1	KCSC OK Edmond, ID	1355

8/3			
1242	92.9	KBID TX Wichita Falls, ID	1320
1300	90.1	KCSC OK Edmond, ID	1355
1305	102.7	KZUE OK Oklahoma City, "Z103"	1355
1315	94.7	KEBC OK Oklahoma City, ID	
1317	93.9	KTTL KS Dodge City, local ref.	
1729	90.1	KHCC KS Hutchinson, ID	1280
1732	92.3	KOEZ KS Newton, ID	1310

Have been KPN in Eugene on business since 8/9, so that's it. Not a wasted year but could have been better.

TOTAL: 434, Concord: 325, Pleasanton: 250, Castro Valley: 177. Using a Heathkit AJ-15, Winegard SC-650 antenna w/rotor at 15 ft. Newer GH-6065 antenna had to be left behind in Concord, as could not retrieve from roof.

QUICKIES:

(time: 0930, 9/2)

\*\*\*Ron Wing, 705 N. Emporia, Apt. 2, Wichita, KS 67214 reports picking up WCEM 105.1, Quincy, IL on his car radio about five miles south of Scott City, KS, (about 528 mi.)

\*\*\*September has been barren for DX--nothing heard on FM worth noting. On a 0 to 10 scale for FM, September rates a 0. It's almost enough to drive one back to BCB! (horrors!); relates John Combs of 2485 Ivan Court, Orlando, FL 32807.

\*\*\*Paul Mount writes of his reception experience at Table Rock, highest point in MD, between 2030 & 2300 on a Sanyo AM-FM stereo cassette recorder with three ft. whip. His 33 loggings seem to show conditions were normal as most milages were well below 200 miles. Since this column is for reporting abnormal reception, his report will not be detailed here.

FROM THE SFM EDITOR: Conditions have been normal here, too. Since I moved, I haven't managed to remove the antenna from my old location. Expect to though soon. Using a T-wire now, barely good enough for the semi-locals as expected. Before I moved, I found about the only way to add to my log was to go after the new stations and those old, weak, elusive ones. I found, with enough patience, some of the stations would rise enough out of the noise long enough to get an ID even sometimes at the top of the hour, appropriately enough. Well, I gotta go now, running late. Until next month, 73. DB

+++++



411 SEVENTH AVENUE, PITTSBURGH, PENNSYLVANIA 15219

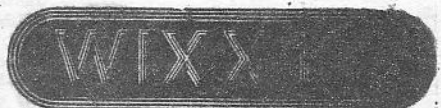

115 So. Jefferson St. • Green Bay, Wisconsin 54301



P.O. BOX 12, SOUTH BEND, INDIANA 46624



90.3 Stereo FM

P.O. Box 265, 4647 Stone Avenue, Sioux City, Iowa 51102





John F. Combs Cont'

this morning. UHF dish OK, but VHF log a total loss. Hope I fare better. In case anyone's wondering "where's the rest of John's report", don't bother! This is the entire, 100 %, bona fide September report. Undoubtedly the worst month for DX I've seen-maybe the worst month of all time..! Things may be looking up, though. I've been noticing improving early morning extended CW/mild Tr conditions out to 200 mi. or so, and the nights are getting cooler. By the way, by the time you read this I will have started working for the Postal Service. Late, irregular hours, but good \$! This, plus a full load of classes, will severely curtail much DXing, especially as regards to F2. I will rarely, if ever, be around to monitor the peak periods each day. Oh well... perhaps during the next 11 years I can prepare myself a little more adequately for F2-assuming there will still be some Europeans on lo-band."

Somehow I forgot to put my usual words of wisdom concerning the months DX at the beginning of the report. As I reported last month, tropo was unbelievable for people in the Northern part of the US & in Canada. The Sept. 3-5 openings was one of the best ever to Ontario, so reports Marvin Shults and ye olde editor. Marvin and myself both noticed CCI on trop that looked more like Es (at my location, ch 11 was at least 8 stations deep). Bob Seybold reported a super opening into IL, IA, MN, & WI. Bill Thompson reports the best signals ever to IL. The most interesting logging on the 9/9-10 opening was Paul Gaines' WFAA-8(985 miles). Tom Yingling reports many good loggings into Ontario, OH, MI, & IL 9/10-43. Another duct opening occurred on 9/24, with TN, MS, & AR being logged in IL. The opening of Sept. 3-5, occurred, according to the local weatherman, because of Hurricane David. The extreme low pressure of this storm sort of created a hole in the troposphere. High pressure then attempted move east to fill this hole, resulted in a large, very strong high pressure ridge covering most of the Northern part of the US, west of the Rockies.

Roy D. Horsley Jr. Rt. 10 169 Lakeshore Drive Gadsden, AL 35901 (CDT)	
<u>June</u>	<u>August</u>
24 Es 1000 XHY-3 FUC	7 Es 2225 3-SS B&W
2200 XHRIO-2 TAMS	"Combat"
2230 KMID-2 TX	3- Lawrence
	Welk
<u>JULY</u>	
2 Es 1000 KIII-3 TX	2230 3-SS "Mod"
KMID-2 TX	Squad"
2140 Severe CCI 2-6	14 Tr 0100 WCCB-18 NC
2145 KRIS-6 TX	WRBT-36 NC
2200 KMOL-4 TX	WGHP-8 NC
2205 KMID-2 TX	0130 WDBJ-7 VA
2210 KACB-3 TX	WJHL-11 TN
2228 KFDX-3 TX	WXIA-8 VA T
22 Tr 2200 WBRZ-2 LA	"Picture
WAFB-9 LA	wouldn't frame"
2205 WBCA-27 FL	WFMY-2 NC
WMAW-14 MS	CCI to 3-WRBL
	WHSV ?
	<u>September</u>
	2 Tr 0930 WKGA-8 GA
	WDCO-15 GA
	"Equipment- '79 RCA 25" Color-
	Trak, '62 GE 9" B&W. '72
	Admiral 19" color, 1979 Philco

VHS-VTR; antennas- (1) 7' UHF parabolic dish, 20 element VHF, Blonder-Tongue UHF-VHF preamp, Alliance rotor, at 50', (2) 8-bay bowtie UHF, 22 element VHF, Blonder-Tongue preamp, Channel Master rotor, at 25'. (On order a CT118-Panasonic 10" color). Now that I have good equipment for DXing, it seems that I don't have the time to devote to it as I would like. I have found I can DX by VTR in my absence. The only thing is you are limited to one channel. It really helps on the Spanish stations. I have caught the tailend of quite a few E-skip periods in the last month so I think it should have been a good month for most DXers. By the way, the CBS to ABC switch is not always permanent, apparently WCBI-4 has changed back to CBS. '73's Roy.

Glenn Hauser University Radio WUOT, Knoxville, TN (CST)

Rx: 4 TV sets, UHF & VHF ants. as previously described; TX-9100 for FM.

1 Sept. Around 1430 noted NBC baseball from west,  $\beta$  offset to WSJK and overriding it on rabbit ears; 1534 10-kHz offset, KSN ID in BB, so KCKT-2. 1818 on 3, Kansas tornado warning, so KARD-3; 1825 PBS from west, Marriage of Figaro; 1959 2//3 KSN weather streamer, 2027 on 3 end "Dancing Disco", KENW ID (NM), billboard of programs.

2 Sept. 1025, WBIR translator on ch. 4, northwest, about 15 kHz offset to WSM.

10 Sept. As hams were establishing 70-cm contacts between CO & VA, I was having best tropo opening I've observed from this location: 1745, PBS NW on 9, 1759 WWIN ID photoed; 1759 WAVE ID. Also NW Happy Days on 7, probably Evansville. 1745 CCI to the TN on 22. 1802, PBS on 15, same direction as WSVN-47 and ??, so WBRA Roanoke, VA; some CCI to N from WKPC. 1803 14 NW NBC, so Evansville. 1820 checked FM, finding ATC stereo on 91.1, stereo rock on 89.1, 1826 ID as WVJC Mt. Carmel, IL, ID, local FSA; 1929 on 91.1

## Glenn Hauser cont'

Vincennes, ID. At 1959, WVU-24 Morgantown, WV with program summary for tomorrow nite, ID as "WVU Television". 2003 on ch 22, record offer, Pittsburgh address, "Avengers", 2015 ad for Penn Hills. 2015 on 40, Greek religious pgr with phone (412) 824-3900 supered; this is the new WPCB near Pittsburgh. 2016 on 53, old movie. 2030 on 40, "Jesus is the Answer" program starts. 2031 on 38 offset CCI; farther west than 40. 2032, "You Bet Your Life" on 41, Louisville I assume. 2034 PBS on 48--?? 2035 Drama not // nets, furniture ad on 30, KDNL St. Louis with distinctive logo. 2052, woman with news on 53, odd time for that. 2053 40 now supering a different number (412) 847-0300. 2100 WVU attempting to imitate commercial formats with local newscast, "The Mountain Scene Tonight" co-anchor Valerie Guonzo was really green; I hope it was her first nite on the air; interrupted every few minutes for "commercials" for PBS Summerfest 79. 2100 WCHS-8 ID. 2101 Lucille Ball W/Gale Gordon on 22. 2102 Book Beat on 33, same direction as 24. 2105 WSAZ-3 with "Charleston News Center". 2115, Cavett on 20. 2116 Roanoke with "11 O'Clock report", 7 news logo with a star above the 7. 2116, Homestead-Wilkinsburg ad in Lucy on 22. 7 had a Ford ad showing a VA/NC map, and Roanoke was giving weather for WV too. 2123 on 42, not in earlier, now with film drama, Twilight Zone, FNB Birmingham ad coming in off the back of the dish. 2130, 24 and 33 now in parallel with ABC Captioned News. 2133 CBS on 33 // Birm 42, 10 kHz CCI with WV. 2137 PBS on 48, assume WCET; had been CCI with Alabama. 2144, WPGH "TV 53" with Night Gallery. 2146 22 with ad for Emsworth, PA. 2149, WOKW TV 13 Action News, Huntington, WV. 2200 finally got definite ID from new WPCB-40 Greensburg/Pittsburgh PA. 2200 WVU signing off with scenes, Copland's Appalachian Spring, listed several translators including W48AA, W69AC, W69AB, W44AA, W41AA, photoed ID; off at 2202 revealing an NBC which caused no CCI to WVU; 2005 House of Lloyd ad, 483-7409 phone, and Florida vacation ad, both slides with local anc; 33 had CBS late movie, lotsa PSAs but no IDs; 2240 33 proved to be Alabama per local ad, before 2300 local WTVK was off revealing 25 Evansville, 14 also in.

11 Sept. 46 with AM Weather (PBS), 0629 clock and next program billboard, but no IDs (KET airs this program between 0615 & 0630 CST, so maybe WKLE, ed), 0629, KDNI-30.

Thomas J. Yingling 221 Pinewood Rd. Baltimore, MD 21222 (EYT)

April									
27 Tr	2000	WGCB-49 PA	20 Tr	2400	W65/-65 VA	28 Tr	1800	WTVG-68 NJ	
		Red Lion			New Market			to W64/-64 VA	
					XLTR WVDM-9		2400	Jackson Mt	
May				0030	WVIT-30 CT			XLTR WSET-13	
10 Es	1800	WLBT-3 MS		0100	W59AA-59 CT			W69AA-60 NY	
		KATC-3 IA			West Haven			New York	
		WEAR-3 FL	24 Es	1800	WJXT-4 FL			XLTR WTVG-68	
11 Tr	1850	WICZ-40 NY		1815	WUFT-5 FL		27 Es	1800	KTVY-4 OK
		WENY-36 NY		1830	KOTV-6 OK		August		
15	0010	WATU-26 GA 500	27	1800	KLNB-3 NE		1 Tr	0200	W66/-66 NY
		Augusta		1810	CJAP-3 NFLD			New York	
		WCWB-41 GA 560			Argentina		22	2300	WNJU-47 NJ
		Macon		1830	CJON-6 NFLD		22	2330	W51AC-51 PA
	0100	WRET-36 NC		1840	CJCN-4 NFLD			W73AH-73 PA	
30 Es	1600	WML-4 LA	28	1800	WOWT-6 NE			Chambersburg	
		MUF 97.5 MHz		1830	WCOO-4 MN			XLTR WITF-33	
			29	1900	KCEB-6 TX				
June			July						
3 Es	2100	KOET-3 OK	2 Es	1430	KATC-3 IA		30	0022	WAKR-23 OH
		Bifaula		1500	KLNE-3 NE			0030	WPGH-53 PA
Tr	2200	WNYC-31 NY			KMTV-3 NE			WKBN-27 OH	
		to WSEK-38 MA		1510	WOWT-6 NE		September		
	2300	WNJU-47 NJ		1400	CBOT-4 ON		1 Es	1600	KOTV-6 OK
		WPFF-28 NC	5	1600	CJAP-3 NFLD			1630	WDBO-6 FL
		WRET-36 NC		1610	CJBR-3 FL		Tr	1800	WSEK-38 MA
13 Es	2000	KATC-3 IA		1300	KYTV-3 MO			to WKNE-25 MA	
16 Tr	2200	WVU-24 WV	7	1320	KARD-3 KA			2330	WEDN-53 CT
		to Morgantown		1330	KOTV-6 OK				WLVI-56 MA
	2400	WPGH-53 PA			KTVY-4 OK				WTNH-8 CT
		Pittsburgh		10	1800	WCCO-4 MN			WEDW-49 CT
		W69AB-60 WV			1830	CBWT-3 MB			WEDH-24 CT
		Cacapon Mt.		28 Tr	1800	WVU-24 WV			WVIT-30 CT
		XLTR WVU			to W41AB-41 VA				WSBE-36 RI
		W64/-64 VA		2400	W42AC-42 VA		2	0030	WQTV-68 MA
		New Market			W75AL-75 VA				Boston
		XLTR WRC-4			Lurray		10	1630	WFMZ-69 PA
		W63/-63 VA			XLTR WVPT-51			1849	WSBE-36 RI
		New Market			W67AL-67 VA			2100	W41AB-41 VA
		XLTR CBS, not			Staunton				W42AC-42 VA
		WVDM-9			XLTR WVIR-29			2120	WRET-36 NC
		WCDC-19 MA							WCCB-16 NC

## Tom Yingling cont'

## September

10 Tr 2145 W48AA-48 WV  
 Keyser  
 XLTR WVVU-24  
 2200 WRLK-35 SC  
 2230 WYEA-38 GA 650  
 Columbia  
 2245 WATU-26 GA 550  
 0010 WKPT-19 TN  
 0100 WAKR-23 OH  
 0130 WOLO-25 SC  
 Columbia  
 1600 WVIZ-25 OH  
 Cleveland  
 2000 WRRT-36 NC  
 2035 WAKR-23 OH  
 2050 WUAB-43 OH  
 Lorain  
 2100 WGPR-62 MI  
WKBD-50 MI  
 2104 CITY-79 ON  
 2120 WBAO-49 OH  
 Akron  
 2130 WEYI-25 OH  
WTVS-56 MI  
 2200 WOSU-34 OH  
 Columbus  
 2230 CKCO3-42 ON 400  
 Sarnia  
 2300 CICA-19 ON  
CICO-59 ON  
 2330 CBLFT-25 ON  
 2400 CICO-28 ON  
 Paris

12 Tr 0030 WJET-24 PA  
 0020 WIFR-23 IL T  
 Freeport  
 0031 WUCM-19 MI T  
 University Center  
 0100 WJBK-2 MI  
 "new mode, seen  
 before by Ms"  
 0102 WSEE-35 PA  
 Erie  
 0121 WDHO-24 OH  
 Toledo  
 0131 WYTV-33 OH  
 0149 WGPR-62 MI  
 0215 CICO-28 ON  
 0220 CICO-32 ON  
 Windsor  
 0230 WTAB-4 PA  
 0235 WIVB-4 NY  
 Buffalo  
 New call  
 0600 WENY-36 NY  
WICZ-40 NY  
 0608 WKBW-7 NY  
 0615 WSYE-18 NY  
 1600 WCNY-24 NY  
 1800 WUTV-29 NY  
 1805 CICA-19 ON  
CBLFT-25 ON  
 2000 WJET-24 PA  
 2010 WPGH-53 PA  
 2015 WSYE-18 NY  
 2030 WVIT-30 CT  
WSBK-38 MA

12 Tr 2100 WKBN-27 OH  
 2128 WYTV-33 OH  
 2130 WPMJ-21 OH  
 2146 WHDH-24 CT  
 2150 WGDC-19 MA  
 2155 WLTV-21 NY  
 2157 WNJU-47 NJ  
 2200 W59AA-59 CT  
 2210 WLVI-56 MA  
 2215 WBDT-65 CT  
 2220 WSBE-36 RI  
 2230 WNYC-25 NY  
 2250 WVIZ-25 OH  
 2300 WSEE-35 PA  
 2310 WSKG-46 NY  
 2330 WPCB-40 PA  
 Greensburg  
WNED-17 NY  
CBLFT-25 ON  
 2340 WKBD-50 MI  
WGPR-62 MI  
 13 Tr 0000 WKCF-22 OH  
 Dayton  
 0100 CKCO3-42 ON  
 0200 WKBW-7 NY  
 0201 WIVB-4 NY  
 0240 CICO-24 ON  
 Ottawa  
 0300 FM to Buffalo,  
 Toronto, & Ohio  
 0600 WIVB-4 NY  
 1800 WTVG-68 NJ  
 to WSBE-36 RI  
 2400 WLVI-56 MA  
WSBK-38 MA  
WNYB-25 NY  
WNYG-31 NY  
WGBY-57 MA

"TV set: Sony Trinitron model kv-1214 12" color. Antennas;  
 Channel Master Quantum model 1114 chs 2-13, Finco 5' dish up  
 50' using Winegard bc-234 chs 2-13, BTB-CMA-ub chs 14-83.

Jeff Wolf 1131 University Blvd. W. Apt. 701 Silver Spring, MD 20902 (EST/EDT)  
 December 1978  
 7 Tr 2000 W75AP-75 VA 63  
 Oak Grove  
 WGVN XLTR  
 24 Tr 0002 W48AA-48 WV T  
 "off when other  
 WVVU XLTRs sign  
 off"  
 14 Tr 2343  
 15 0010 WRRT-36 NC 332  
 0022 WPTF-28 NC 251  
 0030 WRLK-35 SC 409  
 Columbia  
 March 1979  
 22 Tr 2241 WNJS-23 NJ  
WNJT-52 NJ  
 23 0002 WCNC-40 NC 119  
 "Rare"  
 0200 WITN-7 NC 257  
 0240 WCTI-12 NC 269  
 0504 WCTI-12 NC 269  
 0527 WNCT-9 NC 243  
 0530 WITN-7 NC 257  
 30 0701 WTPA-27 PA 86  
 Harrisburg  
 0710 WTFP-33 PA T  
 0724 W42AC-42 VA 66  
 25 0517 WPTF-28 NC  
 0521 WXII-12 NC 263  
 0527 WNCT-9 NC T  
 0544 WDBJ-7 VA 226  
 Roanoke  
 0604 WSLS-10 VA 226  
 Roanoke  
 0639 W42AC-42 VA  
 0650 WSET-13 VA  
 26 2103 WPCB-40 PA 173  
 Pittsburgh  
 30 2222 WGCB-49 PA T  
 May  
 2 Tr 2300 WCFB-28  
 "Snow free"  
 3 0204 WGAL-8 PA  
 8 Es 2019 UnIDed 2, NBC  
 10 1959 UnIDed 2, PBS  
 11 Tr 0306 WCBS-2 NY 200  
 Es 1714 UnIDed 3, 3/4 CB  
 1736 UnIDed 2, 3/4 CB  
 1738 Cuba-2 T  
 13 Ls 1805 CCI on 13 during  
 lightning flash  
 14 Tr 1658 WBWT-12 VA  
 1703 WHRD-15 VA T  
 1900 WPTF-28 NC 251  
 0136 WXII-12 VA T  
 "CCI O/WBWT"  
 0303 WABC-7 NY T  
 0512 WPTF-28 NC  
 0537 WGHP-8 NC 268  
 0559 WGCB-41 GA 577  
 Moon  
 "My furthest  
 tropo logging"  
 0627 WPTF-28 NC  
 0633 WSET-13 VA  
 0712 WRLK-35 SC 409  
 0715 WNBC-30 SC 369  
 Rock Hill  
 0724 WRRT-36 NC  
 0737 W69AB-60 WV 86  
 0750 W75AP-75 VA 63  
W73AS-73 VA 63  
 0806 WUNG-58 NC 332  
 Concord  
 0900 WTVI-42 NC 338  
 Charlotte  
 0927 WTVD-11 NC 246  
 1002 WRRT-36, WRLK-35,  
WTVI-42 still in  
 1006 WPTF-28, WSET-13

Jeff Wolf cont'

May											
15 Tr	2318	WGCB-49 PA	22 Es	2028	WLBT-3 MS	30 Es	2110	UnIDed	5	ø	offset
		Red Lion			2224	WBRZ-2 IA					
16	0000	Richmonds 23, 12, "like locals"	30 Tr	0734	W74AU-74 VA 118	2328	KATC-3 IA				
21	0400	WXII-12 NC 263									(Sorry, I seem to have mis-
	0409	WCBS-2 NY T									counted the number of lines, I
22 Es	1720	UnIDed 3, 3/4 GB									guess I'll have to go back
	1725	Cuba-2 ?		0801	W75AP-75 VA						to school, hi, ed.)
	1730	WBRZ-2 IA 950			W73AS-73 VA						
	1750	UnIDeds 4, thru local		0813	WUNK-25 NC 244						
	1801	UnIDed 5 ø local		0830	WUNJ-39 NC 336						
	1830	KTBS-3 IA 983			Wilmington						
	1851	UnIDed 3, CBS		0836	WTVD-11 NC 246						
	1903	WEAR-3 FL	Es	2000	WMAB-2 MS						
	1919	KPRC-2 TX			2016	WEAR-3 FL					
	1930	KATC-3 IA 1000			2023	UnIDed 3, CBS					
					2030	WRBL-3 GA T					

Mike Rosen 9256 Cloisters West Richmond, VA 23229 (EDT)

June			30 Tr	0300	WCBS-2 NY 300	5 Es	1730	KTVI-2 MO 700
28 Es	1800	KTIV-4 IA 1060	July			29	1730	CKCO-2 ON 550
29	1830	CBFT-2 FQ 600	2 Es	1700	CFCM-4 FQ 600		1930	KARD-3 KA 1200

John Barber Jr. Box 65 Carolina, RI 02812 (EST/EDT)

March			22 Es	1930	KATC-3 IA	24 Es	list of UnIDeds that	
22 Tr	2000	WYAH-27 VA 500			Shreveport		was too long to print, ed)	
		WHRO-15 VA 500			KETS-2 AR	25	0800	WREG-3 TN
		WBOC-16 MD 200		2000	WCBI-4 MS			WRCB-3 TN
		WBRE-28 PA 235			Columbus			WRBL-3 GA
		WVIA-44 PA 230	23	1337	WSJK-2 TN			WKRG-5 AL
		WBFF-45 MD 200			Sneedville	28	0900	UnIDed 2-4 Canada
23	0700	WDCA-20 DC 240		1400	UnIDed 3, ABC		1330	WBEZ-2 IA
		"Snow Free"	30	1900	CMKU-2 CUBA			UnIDed 4, edu
		WETA-26 DC 240	June				2100	WYAH-27 VA
		"Snow Free"	2 Es	1900	CMKU-2 CUBA	Tr	2115	WHRO-15 VA
		N.J., Philly Us			WPBT-2 FL			WAVY-10 VA
April			Tr		WVEC-13 VA			WBRE-28 PA
20 Tr	2000	Same as 3/22			WHRO-15 VA			WBET-12 VA
		WAVY-10 VA			WYAH-27 VA			WOGA-20
		NY ext. strong	5 Es	2000	CKMJ-3 CUBA			WBFF-45 MD
25	1930	NY & Phillys			CMH-5 CUBA	Es	2128	UnIDed 4- "Skywarn"
		strongest ever			WFBC-4 SC			(KDUH uses this, ed)
		WGBH, WKNE, WBEZ,			Greenville	29	0600	WBBH-2 IL
		WCVB, WMAC			WJXT-4 FL			Chicago
May					Jacksonville		1000	WMT-2 IA
3 Tr	0326	WGTI-12 NC 725	10 Tr	0600	VA 15,27,13	Tr	2100	WHRO-15 VA
	0530	WBNG-12 NY 250	18 Es	1300	WNGE-2 TN			WYAH-27 VA
6	2235	Same as 3/22		1330	WAVE-3 KY			WTVD-11 NC
10 Es	2000	WTES-2 FL			Louisville	30	0700	WTV-2 NY
		WEDU-3 FL			WREG-3 TN			Es
		WTVJ-4 FL			Memphis	1100	WCBI-4 MS	UnIDed
		UnIDed 5, CBS			WMC-5 TN			KDIX-2 ND
11	0000	WRBL-3 GA		1400	WEAR-3 FL			Dickinson
	0030	WBEZ-2 LA	19 Es	1530	WBEZ-2 LA			KSTP-5 MN
Tr	2147	WVIB-4 NY			"1st Ms Stn"			St. Paul
12	0638	NY, NJ & Philly Snow Free	22	1200	KUSD-2 SD			KTCG-2 MN
					"MUF 10, heavy het on 10, in & out like Es"		1300	WCCO-4 MN
19 Es	1300	KMOX-4 MO				July		Minneapolis
		WMT-2 IA				1 Es	1200	WSB-2 GA
		WBRF-4 IL	24	1955	WRBL-3 GA			KXJB-4 ND
		KYIV-4 IA		2000	KYTV-3 MO			KTBS-3 IA
		WDAF-4 MO		2200	WCIX-6 FL			Shreveport
	1400	KUSD-2 SD			Miami		1530	KQTV-2 MO
		Vermillion			WMAB-2 MS		1729	WTWO-2 IN
	1436	KPCA-2 MN			WESH-2 FL		1730	KYTV-3 MO
22 Es	1900	KALB-5 LA			(John also had a long		1800	WTMJ-4 WI
		Alexandria						Milwaukee





Bob Seybold Bennett Rd. Dunkirk, NY

"Here is a summary of some of my DX activities for the summer. As a whole the E-skip season has not brought much to my location. Ver few log dates were kept, but Florida stations were most frequent visitors, Cuba was in on two occasions, a couple of Canada openings, only a few openings to channel 6 or above and only one new skip station added to log. Best opening brought in Tennessee, Arkansas, Florida, Texas, Alabama, Louisiana, Georgia, Oklahoma, Kansas, Mississippi, Nebraska in one big opening all channels 2-6. However, E-skip has lingered with recent openings (late August) to Florida, Cuba, Texas and Mississippi. Some tropes as of late including Indiana, Ohio, Penns., Wisconsin, Illinois, Missouri, Kentucky, and Michigan on UHF- latest opening 8/30 into 8/31-trops-WCMU-14, WANE-15, WIGD-15, WNDU-16, WJAN-17, WLEK-18, WLPT-18, WUCM-19, Cincinnati 19, WGSU-34, WNTT-34, Lima-35, WXON-20, WPTA-21, WSBT-22, Pittsburgh 22, Greensburg 40, WKAR-23, WDHO-24, WEYI-25, WCIU-26, WKYT-27, WSJV-28, Toledo & St. Louis -30, WMED-31, (also Peoria 19), Springfield, Ill 20 & 55 (new); WQRF-39 (new), WFLD-32, also Chicago 38 & 44; WKJG-33, WUHQ-41, Indianapolis-40, WPBO-42, WNEO-45, S. Bend 46, WABD-49, WKBD-50, Detroit 62, WFFT-55, WTWS-56, WBGU-57, also translators 55, 64, 67 (WVTZ-25), with 55 & 67 new also Lansing 67 and Ontario 15, 18, 19, 22, 25, 28, 32, 35, 40, 42, 44, 48, 55, 59, 68, 76, & 78 in one hours time they were. 4 stations on 55 an usually empty channel here. Also skip opening to Texas on 9-1-79. In hills DX location new 22 & 40 from Pennsylvania are in daily- good signals. 13 new stations totals now 805. Super opening- Sept. 4th into morning of Sept 5- great tropes to Iowa, Minnesota, Wisconsin, Illinois, Michigan- WCMU-14, KMEC-14, WANE-15, WIGD-15, WMTV-15, WNDU-16, WTVO-17, WJAN-17, WVTY-18, WLPT-18, WUCM-19, WXOW-19(new), WRAU-19, WXOW-20, WHRM-20(new), WPTA-21, WHA-21, KTIIN-21(new), WSBT-22, WKAR-23, Rockford-23, WDHO-24, KYIN-24(new), WEYI-25, WEEK-25, WCIU-26, WKOW-27, KSIN-27, WSJV-28, WHWC-28, WGTU-29, WGTB-30, WMED-31, WHLA-31, KRIN-32, WFLD-32, WKJG-33, K33AA Ottumwa (XLTR KIIN-12) (possibly most distant XLTR ever seen here), WNTT-34, WGVG-35, WMYT-36, KHIN-36, WLEF-36(new), WCFC-38, WPNE-38, WQRF-39, KDUB-40, WUHQ-41, CKCO-42, WSNB-44, WNEO-45, WMBE-46, WTVF-47, WLPB-49, WKBD-50, ---50 (Iowa ?), WFFT-55, WTWS-56, WBGU-57, W47AB-47 (Ohio), W7AO-70(Wisconsin), W72AJ-72, W75AJ, W76AI, Iowa-59 XLTR (WHO-13) (new) (this is K59AJ Unionville, MO, ed), KWCM-10(new), WMTV-10, WISN-12, WEAU-13, WLUK-11, WKBT-8, WAOW-9, plus Iowa and Minnesota V's. New Toronto 47 daily here. Sept 13 start of another big tropes opening: WCMU-14, WFBF-14, WMTV-15, WANE-15, WIGD-15, WNDU-16, WOET-16, KUHI-17, WJAN-17, WAND-17, WLFI-18, WLEK-18, WUCM-19, WKPT-19, WRAU-19, WXIX-19, WXON-20, WIGS-20, WPTA-21, WSBT-22, WKFP-22, WKAR-23, WDHO-24, WEEK-25, WEYI-25, WCIU-26, WKYT-27, KMTC-27, WSJV-28, WGTB-30, WTIU-30, KDNL-30, WMED-31, WFLD-32, WKYK-32, WKJG-33, WGSU-34, WNTT-34, WLIO-35, WKHA-35, WGVG-35, WCFG-38, WQRF-39, WHMB-40, WUHQ-41, WQRB-41, WPBO-42, WSNB-44, WOU-44, WNEO-45, WLPB-49, WCFB-48, WTPP-47, WCAE-50, WKBD-50, WKON-52, WIGB-53, WFFT-55, WTWS-56, WBGU-57, WTVQ-62, WKYH-57, Ohio XLTRs on 47, 52, 55, 64, 67- Lansing on 67, also many VHF seen too numerous to list except new Sault Ste. Marie on 8. Next AM (Sept. 14)- many of above seen plus: WKPC-15, WQEK-16, WHIZ-18, WTAP-15, WKMR-38, WHNT-19, WOUB-20, WKFI-22, WTVK-26, WETV-30, WOPC-38, W41AA (WVVU-24), WSVN-47, WRIP-61, plus V's from Kentucky, Tennessee, W.Va, also KGTO-36(new). Evening brought more tropes mostly to East, southeast and northeast, V's & U's, evening: WMUB-14, WLYH-15, WNEP-16, WPHL-17, WHCT-18, WSYE-18, WDCD-19, WUTR-20, WDCA-20, WHP-21, WDAU-22, WKFP-22 (all Baltimore & Annapolis V's & U's), WNUB-23, WHAG-25, WETA-26, WPTA-27, WSMW-27, WYAH-27, WBRE-28, WTAJ-29, WHNB-30, WWPB-31, WNYC-31, WMUL-33, WITF-33, Binghamton 34 & 40, WENY-36, WLPT-39, W39// (Greenville, TN WKPT-19 XLTR), WHYN-40, Pittsburgh-Greensburg, PA 22-40-53} WXTV-41, WBSA-43, WVIA-44, WSKG-46, WKBS-48, Red Lion-49(new), WVPT-51, WTVT-53, WCVW-57, WJNT-52, WJNB-53, WBTB-68(new), Boston 68(new), WFMZ-69 Allentown, plus V's from NYC, Boston, Philly, Providence, etc, also XLTRs on 42, 52, 55, 59, 60(2), 64, 66(2), 67(2), 68, 70(2), 71, 72, 73, 74, 75, 76, 77, 78, 79, 80, 81 (this opening lasted into next AM) Sept. 16-20: some tropes like Indiana, Ohio, Michigan.. 9/21- tropes: WCMU-14, WUCM-19, WNEP-16, WMPB-16, WUTR-20, WPTA-21, WENY-36, WICZ-40.. 9/22: WCMU-14, WUCM-19, WEYI-25, WKAR-23, WNPB-16. 9/23: WCMU-14, WUCM-19, WMPB-16, WENY-36. Total now 810."

Greg Monti 5 Hickory Road Bayville, NY 11709 (EDT)

From Douglaston, NY

June 8 Tr 2055 WHRO-15 VA 8 Tr 2058 WAPB-22 MD  
2058 WCPB-28 MD 2202 WBOC-16 MD

From Bayville

July 24 Es 1605 KYTV-3 MO  
Springfield

"Equipment: Zenith S-2909-W13 19" color, various UHF & VHF antennas, fixed bearings @ 25 feet or so. Lesson 1: when you see lines on channel 2 while watching M\*A\*S\*H (what if you're watching a different program, hi, ed) turn to channel 3 and have a look."

Steven Sprachman 3939 Eve Drive Seaford, NY 11783 (EDT)

WGBB-49 PA (Red Lion, PA, note the corrected location Steve, ed)

6/28 KOET-3 OK Eufaula, 7/15 CJON-6 St. John's, NFID 1930. Channel 3 at this time was mush-at least 3 stations, 1 was CBE from the Atlantic Provinces. The other 2 came from the midwest. 7/10/79 More Es-WEDU-3 Tampa. 8/1/79 Trop 2000 Boston-Norfolk-Schenectady. WQTV-68 Boston-Tent. with STV, how will one know if the station is correct, especially with 2 STVs on the same channel ? 8/2 Es channel 3, stations, at least one was WLBT-3

Steven Sprachman comt'

Jackson, Mississippi (you mean there was a possibility they BOTH were WLBT, hi, ed).  
Channel 2 UNIDed.

"For all of those who would like to know what I'm doing, it seems that I'll be staying home on Long Island for a while. School and traveling (which included a trip to Bangor, ME) are over for now. And I have a job at a New York State Unemployment Office in Queens. I'll have some time to DX. Hi to Greg Monti. Not that I'm home, I've come back to my old radio listening habits which include WGEE. It's good to hear them on at better hours. And then there's the convention. Maybe next year. In fact, I'm seriously thinking about going next year. It depends on if I'm still working and where it will be held. My lick, it will be someplace expensive. I'll worry about it next year. Well that's it for now."

Frank Wheeler 6589 Wattsburg Rd Erie, PA 16509 (EDT)

August	September	
30 Es 1729 WESH-2 FL 1098	11 Tr 0658 WWTW-9 MI 313	1 Es 1701 KIII-3 TX 1384
31 Tr 0850 WNEP-16 PA 223	13 0628 WBNG-12 NY 216	1800 KJAC-4 TX 1124
0900 WCMU-14 MI 262	1 Es 1605 KBTX-3 TX 1199	1830 KFDX-3 TX 1144
	1700 KPRC-2 TX 1210	4 Tr 0700 WCMU-14 MI 262
		0800 WNDU-16 IN 318

Equipment: Yr. 1970 Zenith color, Antenna: Archer VU-160, Servo-rotor.

George Greene 1527 Sunset Ave Akron, OH 44301 (EDT)

Witnessed by Paul Mount & John Sally

September		
12 Tr 2150 WNEP-16 PA	12 Tr 2155 WNYC-31 NY	12 Tr 2203 WICZ-40 NY
2151 WDAU-22 PA	New York	WSKG-46 NY
	2201 WENY-36 NY	

(Yes I still collect CMs & could use a WLN, RK).

Robert S. Ross VE3JFC Box 4373, Stn G London, ON (EDT)

August	September	
6 Tr 0150 WOTV-8 MI	20 Tr 2322 WKBD-50 MI	5 Tr 0035 WCMR-20 IL 350
7 Es 1601 KFDX-3 TX	2324 CBLFT3-48 ON	(Bob, are you sure about this? WOME is not on the air yet. You probably had WHRM Wausau, WI, ed).
1730 KATC-3 IA	2355 WBAO-49 OH	0123 WCIU-26 IL 350
1830 KMOL-4 TX	2245 W75AL-75 OH	0118 WZZM-13 MI 225
8 0355 WSPD-13 OH	XLTR WVIZ	0305 WISN-12 WI 340
0358 WJAN-17 OH	September	0312 WGN-9 IL 350
0450 WJKW-8 OH	4 Tr 2257 WPBN-7 MI 255	0330 WITI-6 WI 340
0530 WJET-24 PA	2311 WNDU-16 IN 275	0440 WAOW-9 WI 440
0230 CBET-9 ON	2315 WCMU-14 MI 185	0353 WBYA-2 WI 355
20 2250 WAKR-23 OH	2319 WSET-22 IN 275	0430 WCCO-4 MN 625
2252 WVIK-25 OH	2326 WHEM-46 IN 275	0434 WTCN-11 MN 625
2255 WUAB-43 OH	2329 WSNS-44 IL 350	0012 WKEF-22 OH 275
2250 WNEO-45 OH	2332 WCFR-38 IL 350	0035 CBLFT-36 ON
2255 WYTV-33 OH	2340 WKOW-27 WI 420	0054 WFTI-20 IN 300
2305 WKAR-23 MI	2351 WSJV-28 IN 275	0100 WIGS-20 IL 500
2319 WQPR-62 MI	2355 WFLD-32 IL 350	0102 WICD-15 IL 375
2320 CICO-59 ON	5 0000 WHA-21 WI 420	0210 WAND-17 IL 500
2321 WTVS-56 MI	0026 WGTU-29 MI 255	0252 WTTV-4 IN 470
2322 WQLN-54 PA	0033 WMRD-31 IL 470	(Bob, WTTV is in IN not IL, ed)
	0035 WPNE-38 WI 355	0333 WGRQ-9 OH 350
		0340 WTHR-13 IN 300
		0358 KPLR-11 MO 600

"36 new stations this month, all via tropo conditions. Nothing unusual seen here after Sept. 10, so really 36 new stations were logged in 10 days. Reception to the east is poor here, as I live in an APT. building. My ant. was on the balcony, which faces west, and there are 2 buildings behind me blocking reception to the east. Log totals now stand at 142 stations logged, 81 verified, 23 states heard, 19 verified, 1 prov. hrd, 1 verified. I have several UNIDeds that I can find no answers for. Can anyone help me identify the following stations? WUTV-Buffalo Channel 19-Is this a translator of WUTV-29 (yes but it must be rather new, because the 1979 TV Factbook has no listing, ed), CKGN-Global- does CKGN have a translator or relay on channel 19? CBLFT- does CBLFT have a translator on channel 36? Any help with these would be greatly appreciated. 73's. Bob Zent 1835 Fruit St. Huntington, IN 46750 (EST)

August	September	
17 Tr 1820 WSVN-47 VA 325	4 Tr 1100 KDNL-30 MO 300	4 Tr 1300 WLEF-36 WI 445
WKPT-19 TN 350	KDUB-40 IA 290	Park Falls
W39AB-39 TN	WGTU-29 MI 265	#315
WKPT XLTR	1230 WHRM-20 WI 350	WPNE-38 WI 285
	Wausau # 314	1730 KRIN-32 IA 375
		1810 WOC-6 IA 275

"My apologies to everyone for not getting to the WTFDA convention. Things often occur unexpectedly and ruin one's plans. I hope everyone had a good time. Nice opening into Northern Wisconsin netted me two new ones, the first new loggings since last winter. 73's Bob.

Paul Gaines 15920 Puritan St. Detroit, MI 48277 (EDT)

August		5 Tr 0852 WQML-6 MI 190		11 Tr 2223 WDAU-22 PA 385	
19 Ms	0419 WCBS-2 NY 490		Alpena	2224	WBRE-28 PA 380
21 Tr	2327 W47AB-47 OH 115		#383	2225	WYIA-44 PA 385
	2332 W64AK-64 OH 125		0912 WLUK-11 WI 275	2232	WRIP-32 NH 545
22	0207 WWUP-10 MI 285	6	0242 WREX-13 IL 300		Keene
24	0210 WTHI-10 IN 290		0311 WTTV-4 IN 255		#386
	0221 WWUP-10 MI 285		0829 WAND-17 IL 340	2240	WMGC-34 NY 365
25 Ms	0829 WNBC-4 NY 490		0838 WIGD-15 IL 305	2241	WICZ-40 NY 365
31 Tr	0210 WWUP-10 MI 285		0842 WILL-12 IL 305	2243	WSKG-46 NY 365
	0824 WGTQ-8 MI 285		0856 WFLD-32 IL 225	2246	WENY-36 NY 320
	Sault Ste. Marie		"GCI TVO-32"	12	0020 CKGN-19 ON 300
	#377	9	2132 KFVS-12 MO 475		Sudbury
	2328 W47AB-47 OH 115		2156 WIGD-15 IL 305		#387
September			2216 WAND-17 IL 340	0031	WICD-15 IL 305
1 Tr	0828 W64AK-64 OH 125		2241 WKYT-27 KY 305	0108	WLYH-15 PA 375
4	2237 WILL-12 IL 305		2246 WSO-29 KY 370	0117	WAND-17 IL 340
	2246 WIFR-23 IL 325		2252 WKPC-15 KY 310	0240	WTAJ-10 PA 275
	2258 WQRF-39 IL 300		2255 KDNL-30 MO 450	0245	WJZ-13 MD 400
	Rockford		2301 WTHI-10 IN 290	0304	WBAL-11 MD 400
	#378		2313 WDRB-41 KY 210	0310	WCAU-10 PA 445
	2312 WMTV-15 WI 315		2315 WBAK-38 IN 290	0326	CKNY-10 ON 325
	2315 WHA-21 WI 315		2326 WFIE-14 IN 375	0335	WTTV-4 IN 255
	2318 WKOW-27 WI 315		2328 WBHT-25 IN 375	0610	W46AB-46 NY 180
	2324 KDUB-40 IA 375		2336 WILL-12 IL 305	0615	WLXT-9 NY 350
	2330 WHO-13 IA 530	10	0007 WIGS-20 IL 375		Syracuse
	Des Moines		0015 WZTV-17 TN 475		#388
	#379		0050 KMTC-27 MO 630	0650	WHCC-10 NY 280
	2346 WTVO-17 IL 300		0056 WKPT-19 TN 405	0653	WOKR-13 NY 280
5	0013 WREX-13 IL 300		0147 WMBD-31 IL 345	0712	CHEX-12 ON 270
	0045 WHRM-20 WI 360		0148 WREK-25 IL 345	0715	WXXI-21 NY 280
	0113 WSAU-7 WI 360		0152 WLKY-32 KY 310	13	0122 WHCC-10 NY 280
	0116 KWVL-7 IA 450		0211 WREX-13 IL 300	0157	WROC-8 NY 280
	0206 KCCI-8 IA 530		0213 KPLR-11 MO 450	0211	WOKR-13 NY 280
	0214 WBAU-13 WI 440		0215 WTTV-4 IN 255	0217	WBNG-12 NY 365
	0221 KORG-9 IA 415		0328 KMOX-4 MO 450	0219	WJZ-13 MD 400
	"CCI on CBET-9"		0356 WFAA-8 TX 985	0231	WTAZ-10 PA 275
	0230 KSTP-5 MN 525		Dallas	0236	WBAL-11 MD 400
	St. Paul		#391	0252	WTVH-5 NY 350
	#380		(nice one, ed)	0317	CBFST1-13 ON 300
	0234 WAOW-9 WI 360		0707 WLEX-18 KY 305	0320	WCAU-10 PA 445
	0258 WTCN-11 MN 525		0739 KETC-9 MO 450	Ms	0415 WCBS-2 NY 490
	0259 WWUP-10 MI 285		0755 WTVQ-62 KY 305	17 Tr	0105 WOKR-13 NY 280
	0309 WTTV-4 IN 255		0816 WKMR-38 KY 290		0107 WHCC-8 NY 280
	0340 WBAY-2 WI 275		0817 WKLE-46 KY 305		0110 WROC-8 NY 280
	0419 CKGN-2 ON 320		0818 WKON-52 KY 275		0219 WLUK-11 WI 275
	0429 CKNC-9 ON 300		0820 WKPI-22 KY 345		2300 W47AB-47 OH 115
	0430 CHNB-4 ON 325		0823 WKZT-23 KY 345	18	0240 WTAJ-10 PA 275
	North Bay		0830 WKMJ-68 KY 310		0901 WILL-12 IL 305
	#381		0919 CFMT-47 ON 205	19	0840 WIGD-15 IL 305
	0435 CKSO-11 ON 355		Toronto		0900 WILL-12 IL 305
	0439 CBFST-7 ON 320		#384	20	2236 W47AB-47 OH 115
	0441 CKSO-5 ON 300		0928 WSVN-47 VA 380	22 Au	0335 K - 2
	0446 CKSO1-3 ON 280		Norton	24 Tr	0842 KFVS-12 MO 475
	Elliot Lake		#385		0855 WKNO-10 TN 615
	#382		1008 WVU-24 WV 255		Memphis
	0740 KRIN-32 IA 450		1017 WNUJ-33 WV 280		#389
	0850 WNMU-13 MI 355		1205 WOWK-13 WV 280	0922	WMC-5 TN 615
		11	2221 WNEP-16 PA 385		Memphis
					#390

Paul E. Petosky Box 51 Trout Lake, MI 49793 (EDT)

August		7 Es 1930 WPBT-2 FL 1398		21 Es 0100 CFCN-4 AB 1328	
3 Tr	0550 WTOL-11 OH 325		2000 KTEW-2 OK 892	Tr	0113 CKNI-8 ON 240
	0600 Detroit V's	8 Tr	0130 Detroit V's	Es	0145 CFAC-2 AB 1328
	0620 CBET-9 ON 283		"snow free"	Tr	2050 WUCM-19 ME 190
7	0130 Detroit U's	17	0200 Detroit V's		2100 WKAR-23 MI
	"snow free"		"Snow Free"		2130 CKGN-29 ON 253
	0140 WJKW-8 OH 330		0205 CHNB-4 ON 304		Sarnia
	Cleveland	20 Es	2345 CKSA-2 AB 1186	22	0215 Detroit U's
	1855 KDFW-4 TX 1104		2355 CKBI-5 SA 1015		0115 CHNB-4 ON 304



## Paul Petoskey Cont'

## September

4 Tr 1830 WEYI-25 MI 200  
 1930 WCVG-35 MI 186  
 1930 WMTV-15 WI 310  
 "Snow Free"  
 2000 WTV0-17 IL 330  
 WNDU-16 IN 330  
 WICD-15 IL 460  
 WILL-12 IL 460  
 Urbana  
 WREX-13 IL 330  
 2020 WTVV-18 WI 257  
 2115 WISN-12 WI 257  
 2220 WKOW-27 WI 310  
 5 0000 WKAR-23 MI 240  
 WCMU-14 MI 178  
 Milwaukee V's

5 Tr 0002 WAND-17 IL 500  
 Decatur  
 0030 WILX-10 MI 254  
 0200 WEAU-13 WI 260  
 0240 WMAQ-5 IL 330  
 0255 WAOW-9 WI 256  
 WLFI-18 IN 420  
 Lafayette  
 0310 WGN-9 IL 330  
 0315 WCCO-4 MN 400  
 0300 WTOL-11 OH 325  
 WTHR-13 IN 460  
 Indianapolis  
 0320 KHQA-7 MO 570  
 0322 WTCN-11 MN 410  
 1930 Milwaukee V's  
 6 0145 Detroit V's

6 Tr 0155 WIS-7 IL 330  
 0215 WREK-13 IL 330  
 2100 WABD-12 WI 220  
 10 0130 WISN-12 WI 257  
 0145 WEAU-13 WI 260  
 WSAU-7 WI 257  
 11 2045 CKNC-9 ON 190  
 CKNC1-7 ON 112  
 CBLFT6-12 ON 112  
 CBLFT2-13 ON 190  
 2200 CKGO-2 ON 212  
 CKGO-13 ON 290  
 12 0000 CKS01-3 ON 112  
 CKMX-8 ON 240  
 2300 Milwaukee V's

## Steven Shaffer 10956 Indianapolis Blvd. Hammond, IN 46326

(CDT)

## May

22 Es 1716 WWAY-3 NC  
 1830 WEDU-3 FL  
 1849 WTVJ-4 FL

## June

13 Es 1802 WJXT-4 FL  
 1825 WEDU-3 FL  
 30 1100 CBHT-3 NS  
 1129 CHSJ-4 NB  
 1200 WCAX-3 VT

## July

5 Es 1723 WBZ-4 MA

5 Es 1800 CBOT-4 FJ  
 20 Es 1130 WCTV-4 SC

## August

16 Tr 0859 WTHR-13 IN  
 17 0830 WEAU-13 WI

## September

3 Tr 1800 WILX-10 MI  
 1809 WMTV-15 WI  
 1815 WHA-21 WI  
 1817 WTIU-30 IN  
 1820 WBGU-57 OH  
 1825 KDUB-40 IA

3 Tr 1845 WGTB-30 OH  
 1930 WAND-17 IL  
 2000 KTTX-10 MN  
 2030 WKON-20 MI  
 2035 WREK-25 IL  
 2040 WKJG-33 IN  
 2045 WQPR-62 MI  
 2225 WKBD-50 MI

"Wiping out lcl WCAE,  
 whose tower is 2 1/2  
 air mi away"

"Really did turn out to be a bad year for any good long haul Es, with the exception of a few dates in May, June & July. Even those weren't terrific. (Longest apx 1000 mi) I suppose we'll just have to hope next year is somewhat better. 73's.

## Michael L. Hogan 13918 Chippewa Ave. Apt. 1 Burnham, IL 60633

(312) 868-4392

(CDT)

## September

4 0600 WMTV-15 WI  
 0715 WHA-21 WI  
 1800 WGTU-29 MI  
 1900 KIN-12 IA  
 1830 WAKR-23 OH

4 Tr 2030 WTVP-47 IL  
 5 0410 WTCN-11 MN  
 0350 KSTP-5 MN  
 10 0630 WKBD-50 MI  
 0615 WSEB-35 PA  
 0625 WTVQ-62 KY

10 Tr 0630 WDRB-41 KY  
 0728 WKRP-22 OH  
 0720 WKPT-19 TN  
 0735 WKYT-27 KY

## October

1 Tr 0030 KDNL-30 MO

## Donald B. Ruland 4448-68th Place Kenosha, WI 53142

(CDT)

## August

13 Tr 0530 WJKW-8 OH 330  
 17 0520 KFVS-12 MO 370  
 21 Es 2230 KDIX-2 MD 780  
 2300 KWGN-2 CO 880

5 Tr 0505 WCCO-4 MN 320  
 0515 CICO-24 ON 630  
 Ottawa  
 #473

5 Tr 0645 WREB-11 MI 280  
 9 2015 WGBT-48 OH 300  
 WKON-52 KY 330  
 WCVN-54 KY 310

## September

1 Es 1730 WEDU-3 FL 1070  
 4 Tr 2030 WJET-24 PA 400  
 WSEB-35 PA 400  
 WQLN-54 PA 400  
 WUTV-29 NY 460  
 5 0450 WLUU-6 MI 280

0530 CKCO-11 ON 470  
 Huntsville  
 #474  
 0630 KTIK-21 IA 320  
 KYIN-24 IA 270  
 CITY-79 ON 430  
 CBLFT4-44 ON 500  
 Peterborough  
 #475  
 0640 CICO-28 ON

10 0515 WTVQ-62 KY 360  
 0530 WPGH-53 PA 430  
 0545 WJHL-11 TN 520  
 WJVS-12 MO 370  
 0625 WKPT-19 TN 510  
 0630 WLBK-18 KY 360  
 WKYT-27 KY 360  
 0815 WKON-52 KY 330  
 WKGB-53 KY 400

"Log at 475 with 3 new."

## William J. Draeb Ellis St. Kewaunee, WI 54216

(CDT)

## August

14 Es 0000 KID-3 ID  
 "other tent.  
 from MT, AT, WY,  
 SD until 0017  
 Tr 2100 WPIE-14 IN 420  
 WHEH-25 IN 420  
 WKZT-23 KY 473  
 WKMA-35 KY 499  
 2115 KHIN-36 IA 453  
 KCBJ-17 MO 450

14 Tr 2115 KDNL-30 MO 432  
 KTSB-27 KA 560  
 KHNE-29 NE 617  
 KBIN-32 IA 476  
 KYFC-50 MO 525  
 WUSI-16 IL 402  
 WVUT-22 IN 405  
 WLKY-32 KY 437  
 WKPC-15 KY 437  
 WDRB-41 KY 437  
 15 1700 KOZK-21 MO 589

15 Tr 1700 KMTC-27 MO 589  
 KTSB-27 KA 560  
 1725 WKYT-27 KY 473  
 1910 KCBJ-17 MO 450  
 1914 KTVP-29 MN 683  
 2013 KSIN-27 IA 462  
 WKPC-15 KY 437  
 2040 WKSQ-29 KY 538  
 2051 KHIN-36 IA 453  
 2056 WMUL-33 WY 498  
 2117 WPTT-24 TN 667

16 Tr 2117	WKYT-27 KY 473	1 Es 2100	WEAR-3 FL 986	9 Tr 2127	WHIZ-18 OH 400
	WKET-23 KY 473		WKRQ-5 AL 967		WKBN-27 OH 420
	WEHT-25 IN 420	3 Tr 2000	KAVT-15 MN 288		WYTV-33 OH 420
2122	WMAO-23 MS 781		KMEG-14 IA 462		WFMJ-21 OH 420
	WFIE-14 IN 420		KSIN-27 IA 462	2154	WPTF-28 NC 743
	KLAA-14 LA 877		KTCI-17 MN 280	2226	WETA-26 DC 650
	WKMA-35 KY 499	4 2315	CICO-19 ON 350	2243	KYFC-50 MO 525
2130	WHNT-19 AL 685		Sudbury		KBMA-41 MO 525
	WHIQ-25 AL 685		"Snow Free"		KDNL-30 MO 432
	WAAY-31 AL 685		CICA-19 ON 410	10 0640	WPTF-28 NC 743
	WAFF-48 AL 685		GBLFT-25 ON 410		WKYT-27 KY 473
	WCET-48 OH 400		WUTV-29 NY 445		WLEX-18 KY 473
2134	WFIQ-36 AL 675		WJET-24 PA 405		WKBN-27 OH 420
	WSVN-47 VA 610		WKBN-27 OH 420		WMUL-33 WV 498
	WKLE-46 KY 473		CICO-24 ON 583		WKPT-19 TN 612
	WTVK-26 TN 626	5 0005	KSIN-27 IA 462		WXIX-19 KY 400
	WCTE-22 TN 589		"Snow Free"	0712	WKAS-25 KY 486
	WZTV-17 TN 585		WUTV-29 NY 445		WKLE-46 KY 473
2151	WAFT-16 MS 865		"Snow Free"		WSVN-47 VA 610
	WMAA-29 MS T		KHIN-36 IA 453	0721	WKMR-38 KY 487
2214	WHTV-24 MS T		WKBN-27 OH 420		WKHA-35 KY 551
	WOWL-15 AL T		"Snow Free"		WKON-52 KY 437
17 2030	WNEP-16 PA 630		KMEG-14 IA 462	2000	CICA-19 ON 410
	WPTT-22 T	0630	CICO-24 ON 583		GBLFT-25 ON 410
	WKBN-27 OH 420		WJET-24 PA 405		CFMT-47 ON 410
	WUTV-29 NY 445	0645	CHEX-12 ON 458		"All 3 Snow Free"
	WJET-24 PA 405	1000	KMTC-27 MO 589		CITY-79 ON 410
	WFMJ-21 OH 420		KTSB-27 KA 560		WNED-17 NY 445
Is 2300	KDNL-30 MO 432		KBMA-41 MO 525		WUTV-29 NY 445
Tr 2305	WPTY-24 TN T	1950	KHIN-36 IA 453	2010	WNPE-16 NY 600
Is 2310	WUSI-16 IL 402		WKYT-27 KY 473	2200	WJET-24 PA 405
18 Tr 0740	KSIN-27 IA 462		WKSQ-29 KY 538	20620	WBNY-36 NY 575
0748	KXNE-19 NE 525	2056	WRBT-33 LA 1002		WICZ-40 NY 600
	KDSD-16 SD 538		WLPB-27 IA T		WMGC-34 NY 600
	KHIN-36 IA 453		WUSI-16 IL 402		WSKG-46 NY 600
1426	CICO-19 ON T		KDNL-30 MO 432	0700	WSYB-18 NY 575
1745	KHIN-36 IA 453	2112	WPTY-24 TN 667		WVIA-44 PA 630
	WJET-24 PA 405	2132	WGNO-26 IA 1030		WJET-24 PA 405
	WQIN-54 PA 405	2136	WAFT-16 MS 865		WSEE-35 PA 405
	WKBN-27 OH 420	2139	WMAA-29 MS 865		WFMJ-21 OH 420
	WFMJ-21 OH 420	2246	WMAW-14 MS T		WKBN-27 OH 420
	WPTT-22 T	9 1614	WCTE-22 TN 589		WYTV-33 OH 420
22 0730	WMUL-33 WV 498		WTVK-26 TN 626	0720	WQIN-54 PA 405
24 2200	KDNL-30 MO 432		WKLE-46 KY 473	1955	WQEK-16 PA 480
25 2200	WFMJ-21 OH 420		WKYT-27 KY 473		WPTT-22 T
	WKBN-27 OH 420	1640	WMUL-33 WV 498		WVVU-24 WV 513
	WYTV-33 OH 420		WKAS-25 KY 486		WHIZ-18 OH 400
	WJET-24 PA 405	1916	WKSQ-29 KY 538	2010	WPCB-40 PA 480
	WQIN-54 PA 405		WMAW-14 MS T		WPGH-53 PA 480
	CICA-19 ON 410		WFIE-14 IN 420	2016	WUTV-29 NY 445
	GBLFT-25 ON 410		WEHT-25 IN 420		WJET-24 PA 405
	CITY-79 ON 410	2000	WCPT-55 TN 610		WQIN-54 PA 405
	CKGN-22 ON 413	2030	WTVQ-62 KY 473	2045	WKYT-27 KY 473
	Uxbridge		WKMJ-68 KY 437		WKSQ-29 KY 538
26 Tr 0540	WSEE-35 OH 405		WKLE-46 KY 473	12 1850	WBRE-28 PA 630
	CICO-20 ON 210		WKON-52 KY 437	0700	Youngstown U's
	Sault Ste Marie		WCVN-54 KY 407		WKYT-27 KY 473
0600	WJET-24 OH 405		WCET-48 OH 400	1905	WDAU-22 PA 630
1045	W26AA-26 446		WSVN-47 VA 610		WNEP-16 PA 630
1930	WKYT-27 KY 473		WPBO-42 OH 461	2019	WKBN-27 OH 420
	WUTV-29 NY 445	2127	KCBJ-17 MO 450		WPCB-40 PA 480
	WKSQ-29 KY 538		WKYH-57 KY 551		WPTT-22 PA T
30 0715	Youngstown U's		"Snow Free"	13 1905	WKYT-27 KY 473
	WNEO-45 OH 406		WRET-36 NC 736		1912 WKLE-46 KY 473
	WJAN-17 OH 395		WAAY-31 AL 685	14 1953	WMUL-33 WV 498
	WJET-24 PA 405		WHIQ-25 AL 685	15 1730	WKYT-27 KY 473
			WAFF-48 AL 685	19 2025	KDNL-30 MO 432
			WEAO-49 OH 380		2040 WKYT-27 KY 473
			Wouc-44 OH 427		KSIN-27 IA 462
			WVVU-24 WV 513		KMEG-14 IA 462
			WBRE-28 PA 630		2045 KTSB-27 KA 560
September					
1 Es 2100	WPBT-2 FL 1368				
	WTVJ-4 FL 1368				
	WCIX-6 FL 1368				
	WFTV-5 FL 1305				

## Bill Draeb cont'

19 Tr	2046	KYFC-50	MO	525	24 Tr	0550	WPTY-24	TN	667	24 Tr	0755	KLTS-24	LA	T
		KEMA-41	MO	525		0600	WAPT-16	MS	865		1223	WKSO-29	KY	538
	2156	KDSD-16	SD	538		0610	WKPC-15	KY	437			WKYT-27	KY	473
21	2022	WKYT-27	KY	473			WPGH-53	PA	480	26	0620	Youngstown	U's	
23	1915	WKBN-27	KY	420			WKBN-27	OH	420			WPGH-53	PA	480
		WPTT-22	PA	T			WYTV-33	OH	420			WPTT-22	PA	480
	2152	WOWL-15	AL	675			WPTT-22	PA	480		0637	WJET-24	PA	405
		KDNL-30	MO	432			"Snow Free"					CIGA-19	ON	410
		WFIE-14	IN	420		0622	WMAV-18	MS	715			CFMT-47	ON	410
		WEHT-25	IN	420			WEHT-25	KY	420			WUTV-29	NY	445
		WUSI-16	IL	402		0624	WMAA-29	MS	865	27	2200	KDNL-30	MO	432
		WKYT-27	KY	473		0630	WUTV-29	NY	T			KOZK-21	MO	589
		WCTE-22	TN	589		0645	WFIE-14	IN	420			KMTG-27	MO	589
	2155	WFIQ-36	AL	675		0659	WAAY-31	AL	685			WPTY-24	TN	T
		2210	WKSO-29	KY	538	0705	WMUB-14		365			KDOG-26	TX	T
		2233	WPTY-24	TN	667	0728	WKMA-35	KY	499	28	0700	KDNL-30	MO	432
		2236	WZTV-17	TN	585		WKMU-21	KY	553			"Snow Free"		

## Marvin Shults R.R. #1 Toulon, IL 61483

(CDT)

August					4 Tr	2058	CBFLT2-40	ON		5 Tr	0513	WEYI-25	MI	
30 Tr	0959	KXON-5	SD			2108	CICO-59	ON			0517	WBAY-2	WI	
	1328	KDSD-16	SD				Chatham				0519	WJIM-6	MI	
		Aberdeen				2114	CICO-18	ON			0520	CKCO-42	ON	
	1329	KELO-13	SD				London				0524	CICO-32	ON	T
	2129	WKGB-53	KY			2120	CFPL-10	ON			0531	WXON-20	MI	
		WCET-48	OH			2127	CICO-20	ON			0535	WXIX-19	KY	
	2130	WKSO-29	KY				Sault Ste Marie				0536	WLKY-32	KY	
	2151	WEAU-13	WI			2135	CHGH-11	ON	540		0540	WPBN-7	MI	
	2158	WPBO-42	OH				Hamilton					Traverse City		
	2202	WKON-52	KY			2141	CBEFT-76	ON	512		0544	WWUP-10	MI	
	2212	WTWV-7	IN				Kitchener				0600	WGTU-29	MI	
	2217	WBKO-13	KY			2143	WCML-6	MI	436		0800	WMTV-9	MI	
	2230	WHWC-28	WI				Alpena					WCMU-14	MI	
31	0821	WAKR-23	OH			2155	CITY-79	ON	568		1825	WZZM-13	MI	
	0823	WUAB-43	OH				Toronto			6	0657	WDHO-24	OH	
	0829	WDHO-24	OH			2159	WCMU-14	MI			0700	WUAB-43	OH	
	0830	WSPD-13	OH			2200	WUCM-19	MI			0727	WXON-20	MI	
	0851	WGTU-29	MI	T		2208	CBFLT9-68	ON				WKBD-50	MI	
	0854	WKBD-50	MI				Sarnia			8	0830	KIMN-24	AR	
	0858	WKAR-23	MI			2213	WCNY-24	NY	T			KTVP-29	AR	
	2227	WKZO-3	MI			2236	CKGN-22	ON	584		0833	KODE-12	MO	
	2230	WCMU-14	MI				Uxbridge				0839	KMTC-27	MO	
		WOTV-8	MI			2240	WKBN-27	OH			0900	KAFT-13	AR	
	2240	WGTU-29	MI			2245	WJIM-6	IA				Fayetteville		
September						2249	CKGN-29	ON			1158	KTVJ-16	MO	
3 Tr	0417	WXOW-19	WI		5	2349	WKYC-3	OH	T		1323	KOZK-21	MO	
		WXIX-19	KY			0409	WTCN-11	MN			9	0537	KNOE-8	IA
	0428	KAAL-6	MN	T		0410	CKGN-22	ON				KINI-15	IA	T
	1059	WILX-10	MI			0413	WGPR-62	MI			0559	KFVS-12	MO	
	2130	Detroit	U's			0415	KMTC-27	MO			0600	WHNT-19	AL	
		WCTE-30	OH			0417	WCOO-4	MN				WKPT-19	TN	
		WUAB-43	OH				Minneapolis				2129	Lexington	U's	
4	0819	WLIO-35	OH			0420	KSTP-5	MN			2130	WKMJ-68	KY	
	0830	WDHO-24	OH			0428	CICO-24	ON	776			KET 23,29,52,53,54		
		WCET-48	OH				Ottawa					WKYH-57	KY	
	0831	WIPB-49	IN			0439	WITI-6	WI			2131	11,32,41	Louisville	
	1029	WCMU-14	MI			0440	WDHO-24	OH			2139	WPTY-24	TN	
		WFIE-14	IN			0443	WNEM-5	MI			2200	Detroit	U's	
	1059	WGTU-29	MI				Bay City				2206	WUAB-43	OH	
	1859	WBGU-57	OH			0449	WDIV-4	MI			2207	Toledo	U's	
	1928	WUAB-43	OH				Detroit				2217	WLIO-35	OH	
	1930	WJLN-54	PA			0450	WLUC-6	MI			2218	WNBO-45	OH	
		CKCO-42	ON				Marquette				2224	WPGH-53	PA	
	1931	WUTV-29	NY			0452	CICO-28	ON	512		2225	WKEP-22	OH	
		CBFLT3-48	ON			0500	CKCO-13	ON			2246	WJLN-54	PA	
	2030	WVIZ-25	OH				Kitchener			10	0645	WPGH-53	PA	
	2047	WJCO-32	ON			0505	WZZM-13	MI				WUAB-43	OH	
	2050	CBFLT-78	ON			0511	WJRT-12	MI			0647	CICO-59	ON	
		Windsor				0512	CIGA-19	ON	568		0659	KTVP-29	AR	
	2058	W677/-67	MI				Toronto					KIMN-24	AR	
		Ann Arbor												

Marvin Shults Cont'

September

10 Tr 0650	KRCG-13 MO K110J-11 MO	11 Tr 2028	WKSO-29 KY	13 Tr 0459	WBIR-10 TN T
0700	WUTV-29 NY CKCO-42 ON	12	0407 WGPR-62 MI KMTC-27 MO 0415 WCCO-4 MN 0424 WNEM-5 MI	Ms 0503	WCBS-2 NY T
0713	KET 52, 53, 54, 68		0438 WBBM-2 IL	18 Tr 0730	KTVP-29 AR T
0715	WSVN-47 VA W63AH-63 OH		0448 WDHO-24 OH	20	0128 WTCN-11 MN
0729	WQIN-54 PA WCVN-54 KY	Ms	0453 WDTN-2 OH	22	0800 KLMN-24 AR KTVP-29 AR
0730	WKMR-38 KY	Tr	WDTN-2 OH	23	2230 WFTQ-36 AL 2232 WBBQ-13 TN 2234 WPTY-24 TN
0733	WCET-48 OH		0500 WLBK-18 KY		2236 WOWL-15 AL
0742	WAKR-23 OH		0505 WKYX-32 KY		2242 WAFP-48 AL T
0745	WBGU-57 OH W39AA-39 IN		0509 WXIX-19 KY		2300 K44AB-44 IA Pt. Madison
	WLIO-35 OH WOUU-44 OH		0510 CKGN-29 ON	24	0815 WMAV-18 MS 0821 WUAB-43 OH 0822 WCET-48 OH 0828 WSVN-47 VA WESO-29 KY
0756	WIIU-11 PA		0511 WZZM-13 MI		0829 WPTY-24 TN WMAA-29 MS 1145 WMAO-23 MS
0800	WVVU-24 WV		0516 WJTM-6 MI	28	0800 K79BL-79 IA
0811	WGPR-62 MI		0518 WJRT-12 MI	29	0800 WKSO-29 KY 0800 WDHO-24 OH
0825	WSBA-43 PA T		0523 KIMT-3 IA		
0828	WKEF-48 PA T		0534 KTHV-11 AR		
11 0828	WBMG-42 AL		0537 KYTV-3 MO		
0900	WCET-48 OH KET 52, 53, 54 W68AA-68 IL		0547 KATV-7 AR		
	WKMJ-68 KY		0551 KTVP-29 AR		
0930	WCAE-50 IN		0600 KSDK-5 MO new call KFVS-12 MO		
		13	0828 KIMN-24 AR 0422 KMTC-27 MO 0447 WNEM-5 MI T 0449 WDHO-24 OH		

"Sept. 4 was the worst CCI that I've ever experienced on both VHF and UHF. The Sept. 4 & 5 opening was the best tropo

opening that I have ever seen in that direction. I believe I could have received the entire province of Ontario if the channels were free of CCI. Thanks to Morrie Goldman for the tip on WCCO's all night programming. On Sept. 12 I received WDTN-2 Dayton via both Tr & Ms-something unusual. K110J-11 Sedalia, Mo is the satellite of KRCG-13 Jefferson City and not KMOS-6 which apparently was in the old days. KMOS-6 is supposed to become a PBS station and apparently have not been on for quite some time."

Robert Kramer 3406 W. Pierce Chicago, IL 60651 (312) 235-5188 (CDT)

September

13 Tr 0342	KSD-5 MO 265	27 Tr 0430	WTCN-11 MN 360	29 Tr 0905	CITY-79 ON 440
18 0444	CKGN-29 ON 260		WCCO-4 MN 360		Toronto
	CKCO3-42 ON 260		KSTP-5 MN 355	0908	CFMT-47 ON 440
24 0451	WHIO-7 OH 237		0528 WKBT-8 WI 230	1750	WXOW-19 WI 230
	WKRC-12 OH 250	28	0147 KRCG-13 MO 335		WHIA-31 WI 230
	WKEF-22 OH 237		0439 WSPD-13 OH 220		2026 KYIN-24 IA 307
0455	WHAS-11 KY 277	29	0140 WHAS-11 KY 277	30	1610 WKHD-50 MI 240
0516	KFVS-12 MO 332		0145 WLKY-32 KY 277		WTVS-56 MI 240
0520	WPTY-24 TN 492		WKEF-22 OH 237	1834	WBGU-57 OH 200
	Memphis		0509 WXIX-19 KY 257	2229	WBBW-55 IL
0528	KTHV-11 AR 565		0551 WXIX-22 KY 237		Springfield
	Little Rock		0615 WTHI-10 IN	2238	KDNL-30 MO 260
0540	WTVW-7 IN 267		0618 WDHO-24 OH 220		"Local Grade"
0626	WGTU-29 MI 231		WLIO-35 OH 200		
	KDNL-30 MO 265	0633	WBHT-25 IN 267		
0650	WMAV-18 MS 533		WEXI-25 MI 222		
	Oxford		"Local Grade"		
	State 35	0655	WCMU-14 MI		
0726	WKMU-21 KY 373		Mt. Pleasant		
	Murray	0719	WBGU-57 OH 200		
0835	WUAB-43 OH 293		Detroit U's		
0839	WBGU-57 OH 200		"Local Grade"		
0904	WPTY-24 TN 492	0749	CKCO3-42 ON 260	8	0925 W39AA-39 IN T
	"Snow Free"	0801	WUCM-19 MI		WLIO-35 OH 200
0959	KTEJ-19 AR 455		W39AA-39 IN		0927 WBGU-57 OH 200
	Jonesboro	0805	CIGO-59 ON 287		0959 WGSU-34 OH 280
1029	WBBQ-13 TN 492	0902	CBLFT3-48 ON 287	9 Ms	0529 WTVY-4 AL
	Memphis		CBLFT9-68 ON 260		



## Feature

This month, PHOTO-NEWS presents a column of photos of stations in Puerto Rico and the Dominican Republic. The photos on this page were taken by Richard Clark (La Vega, Santo Cerro, Dominican Republic). This month's photos were of color originals, re-made into black-and-white (for publication) by John Combs (Orlando, FL). Another reminder -- in response to a recent inquiry -- color photos are not useable for publication. If you have a photo of something highly unusual, but it is in color, send it to your editor, and we'll see if a way can be found to use it.

73 and good DX,

*Jim*

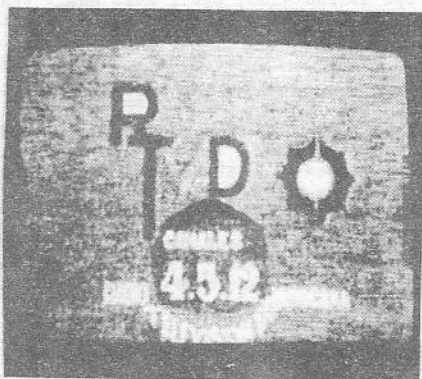

RTV, Dominican Republic



WAPA- 4  
San Juan, Puerto Rico



WORA- 5  
Mayaguez, Puerto Rico



Color Vision, Dominican Republic

# WESTERN TV-DX

Fred McCormack  
Box 5221  
State University Sta.  
Fargo, ND 58105

November 1979

Deadline: 5th

I thought Es had died out early in August, but Dyer's report indicates that in Texas it was another story. Reports and my own observations indicate a poor tropo season also, but I must admit that Battin's loggings from Duluth look real good to me. Also, check Pizzi's report for high band Es last July 4.

New \_\_\_\_\_ New Mode \_\_\_\_\_ Tentative - t Unidentified - unid.

Ron Wing, Apt. 2, 705 N. Emporia, Wichita, KS 67214 assume CDT

9-2-79 1000-1200 from Leoti, KS, K16AB Guymore, OK at a distance of 124 miles was seen with a 12" b&w Sylvania with a 2 bay indoor bowtie. Also seen was a trace of KTSB-27, Topeka and numerous eastern Colorado translators in the 50's and 60's.

9-8-79 0930-1000 on Kansas highway 96 between Maize and Yoder with a 9" b&w Zenith with a clip-on bowtie, K33AC Pawnee City, Nebraska was seen at a distance of 178 miles. Also seen were Kansas City U's (good) and traces of KHIN-36, KLMN-24, and KTVP-29.

Jim Pizzi, 300 Park, Orcutt, CA 93454 Log Total - 203 CST

June 1979	June 1979	July 1979
3 Es 0003 KOMO 2 WA 1010-1015 2 unids on 2 and 1 on 4 sp	26 Es 1230 CKCK 2 SK 1230 KTVQ 2 MT	6 Es 0914 unids 2-4 ne 1101 KPRY 4 SD 1103 KDLOT 3 SD ( @kHz - KEYT)
5 Es 1835 XHCH 2 CH 1420 CFAC 2 AT 1421 CFCN 4 AT 1422 KLEW 3 ID 1425 CKRdt 6 AT	27 Es 0950 KDIX 2 ND 0952 unid 5 ne 30 Es 0930 unid 2 se sp. 0932 unid 4 se	1118 KOTA 3 SD 1130 KDIX 2 ND 7 Es 1002 KMID 2 TX 1133 unid 4 NBC 1135 XHIT 4 CH 1200 KWAB 4 TX 1405 unid 2 ne
11 Es 1430 KREM 2 WA 1437 KXLY 4 WA	July 1979 1 Es 1532 KDFW 4 TX 1600 KTEW 2 OK 1658 KMID 2 TX 1658 KACB 3 TX 2000 KMID 2 TX 2000 KBTXT 3 TX (20kHz - KEYT)	8 Es 1115 KMID 2 TX KACB 3 TX KWAB 4 TX 1128 XEPM 2 CH 10 Es 2215 KDIX 2 ND 11 Es 0915 unids 2,4 e 1130 unids 2 e 1530 unids 2,4 se sp.
12 Es 1150 KTXF 5 TX3/4CB unid 4 east unid 3 east KMID 2 TX 2256 unid 2 se sp.	2Es 2000 KJAC 4 TX 1570 2016 CKCT 2 KS 2023 KAMR 4 TX 2110 KDFW 4 TX 2112 KXAS 5 TX 2143 XEPM 2 CH 4 Es 1718 KREM 2 WA 2201 CHKM 6 BC ( @kHz - KSBY) 2204 KHQ 6 WA (20kHz - KSBY) 2205 KSPS 7 WA 890 (20kHz - KGO w/PBS) 2220 XEPM 2 CH 2221 KMID 2 TX 2245 KREM 2 WA 2245 KOMO 4 WA	12 Es 2135 unids 2 e 2145 unids 4 e 19 Es 2203 KTVQ 2 MT 22 tr 0805 KGO 7 CA 0805 KQED 9 CA 24 Es 1655 KMID 2 TX KACB 3 TX 1705 KWAB 4 TX MS 1706 KDBC 4 TX 30 Es 1948 KREM 2 WA 1952 CBUT 2 BC 2001 KPICt 4 OR 2002 KXLY 4 WA 2005 KATU 2 OR 2130 KTWQ 2 WY 2224 KDIX 2 ND
13 Es 1655 unid 2 e		
15 Es 2213 KBGI 2 ID. 2223 KOMot 4 WA 2231 CBUT 2 BC		
18 Es 0916 unids 2,3 e		
23 Es 1028 unids 2-5 e 1224 KNOP 2 NE 1650-1708 unids 2-5 1712 KMID 2 TX 1800 KDBC 4 TX		
26 Es 0900 KAMR 4 TX 0900 KTWQ 2 WY 1130 CFAC 2 AT KDIX 2 ND KXLF 4 MT 1130 KXGN 5 MT		

August 1979  
3 Es 1805 unids 2-4 n  
10 Es 1200 unid 2 ene

August 1979  
15 Es 1200 unids 2-4 e  
(Nice loggings, Jim. I think your KJAC may have been single hop Es, however. fm)

B.W. Battin, 4305 Pitt St., Duluth, MN 55804

September 1979		
3 tr 1734 Chicago Us 405 S.Bend Us 470	3 tr 1734 Peoria Us 445 1311 WGVC 35 MI 425 1328 WUHQ 41 MI 475 1338 WAND 17 IL 510	3 tr 1856 Ft.Wayne Us 540 2020 WLFI 18 IN 525 2028 KDNL 30 MO 575 2057 WHMB 40 IN 585

B.W. Battin (continued)

## September 1979

3 tr 2100 WISN 12 WI 335	4 tr 1833 CICO 59 ON 590	4 tr 2200 CKGN1 22 ON 575
2012 WIPB 49 IN 580	1908 KDNL 30 MO 575	2205 WJET 24 PA 690
2054 WBAK 28 IN 570	1937 unid fr on ch68	2352 WKEF 22 OH 640
2318 WTIU 30 IN 610	1941 WQLN 54 PA 690	5 tr 0008 WXYZ 7 MI 555
2320 WIGS 20 IL 500	1948 WCHU 14 MI 430	0115 WWUP 10 MI 380
2321 WFIE 14 IN 655	2003 WDHO 24 OH 565	10 tr 2003 WTVV 18 WI 335
2325 Detroit Us 555	2005 WGTE 30 OH 565	16 tr 2241 WGVC 35 MI 425
2359 WFYI 20 IN 585	2005 WUAB 43 OH 635	2244 Chicago us 405
4 tr 0006 WZZM 13 MI 425	2009 WNEO 45 OH 700	17 tr 0055 WEYI 25 MI 475
0010 WICD 15 IL 500	2034 WKBN 27 OH 710	19 tr 2051 Sioux City U365
1728 S.Bend Us 470	2047 CBLFT2 40 ON605	30 tr 0028 Chicago Us 405
1733 CKCO3 42 ON 555	2050 WFMJ 21 OH 710	0033 WGVC 35 MI 425
1738 WEYI 25 MI 475	2054 WMPB 67 MD 950	Duluth Log Total - 269
1739 Detroit Us 555	2103 CICI 32 ON 555	
1746 CKGN 29 ON 555	2109 CICO 18 ON 605	
1758 WUCM 19 MI 470	2111 WGSF 31 OH 690	
1828 CBLFT 48 ON 590	2127 CBLFT1 76 ON630	
	2137 WSEE 35 PA 690	

Hasn't been much DX here lately. In August it was so uninteresting I didn't even bother to report it. The late summer-early fall tropo season here has failed to materialize so far. The only really good opening was that of September 3-4. I hope other DXers have been more successful than I.

Pat Dyer, 5315 Silvertip Drive, San Antonio, TX 78228

CST

Equipment: 1976 model 9" b&w Penncrest, Archer V-100 and 8-bay bow-tie UHF array at 20 feet with rotor.

## August 1979

3 Es 2030-2045 unid 2 e	1 Es (MUF 92.3 @ 1932)	6 Es 1828 KDKat 2 PA 1280
WESH 2 FL 1055	1933 KSBYt 6 CA 1335	1900-20 lull
5 Es 0800-0840 unids 2,3	2010-2055 unid2-4eps	1920 KNBCT 4 CA 1190
0829 WESH 2 FL 1055	2117 WTWO 2 IN 935	KTVKt 3 AZ 835
0840 WEDUt 3 FL 985	2235 f/out, ne -2300	1925 KNXT 2 CA 1190
1220-1230 unid 2 sp	2 Es 0820-0930 unids 2 ne	1930 XHBT 3 BCN1010
2100-2120 unids 2	(very unstable)	1945 apx f/out
(lost of ms overlap)	1025-1030 unid 2	11 Es 1100 KTVXt 4 UT 1080
8 Es 0910-0945 unids 2,3	1530-1540 unid 2 se	KSL t 5 UT 1080
	3 (tried for some ms with	1125 KUTV 2 UT 1080
	Lewis Telethon, no luck	1229 KNOP 2 NE 815
	ch 2-5 in via tropo)	KID 3 ID 1215
	Es 0640 WEDUt 3 FL 985	1300 f/out
	WPTVt 5 FL 1150	21 Es 1740-1840 unids 2,3
	0648 WTVJ 4 FL 1150	spanish, south
	0708 Cuba 2 tp 2stn	1845 YSut 4 ES 1200
	0718 Cuba 3 tp	1848 YSR 2 ES 1200
	0750 fade/trace-0820	TGvt 3 GU 1120
	4 Es 0855 unid 2 e	2100 apx f/out
	1040-50 unids 2 nw	(maybe some Es link w/TE
	1050 KNBCT 4 CA 1190	as 50MHz did to Argen-
	1059 KNXT 2 CA 1190	tina and Chile.)
	1100 KOAI 2 AZ 855	22 Es 0815 KOAI 2 AZ 855
	XHBT 3 BCN1010	23 Es 0920-1100 unid2-4MEX
	1125 f/out	1112 XHAP 2 GRO 880
	6 Es 1815 KTWot 2 WY 1015	1215 XEWO 2 JAL 690
	1826 KWGN 2 CO 810	1240 fade/trace-1310
		24 Es 1855 KNXT 2 CA 1190
		1900 KTVKt 3 AZ 835
		KNBCT 4 CA 1190
		25 Es 0850-0930 unids 2
		tr 0930 KETS 2 AR 515
		29 Es 1125-30 KNXTt 2 CA
		30 tr 0553 KPLC 7 LA 325
		10-1 tr 0005 lots of tr -MEX

ES - El Salvador GU - Guatemala

The long-lived summer Es season really dropped off after the first few days of September, but several more openings during the rest of the month kept things interesting. 73, WA5IYX

(I have nothing more to add. Regretably, no DX was observed here during the reporting period. Hopefully I will have something next time, but I am not too optimistic as October has not been a good month in the past. If DX is happening where you are, please report it. fm)

# VHF UTILITY DX

Pat Dyer  
5315 Silvertip Drive  
San Antonio, TX 78228  
Deadline: 5th of month

NOVEMBER 1979

Paul Petoskey of WIDG in Michigan sent along some copies of some of the publications available concerning the NOAA 162-MHz weather system stations and technical information regarding reception equipment (receivers and antennas etc.). The most recent issues of these may be obtained by writing to:

NOAA  
National Weather Service  
8060 13th Street  
Silver Spring, Maryland 20910  
Attn.: W112

Glenn Hauser of WUOT in Knoxville, TN has some 2nd harmonics to report GMT used; confer with WRTVH for more information on the fundamentals

9-15:  
1704 30.49 Portugal (DW) 9-15: (1713 30.69 USA (VOA))  
1706 30.34 Portugal (RFE) 1733 30.37 Portugal (DW)  
1707 30.61 Morocco (VOA)  
1708 30.95 Egypt ? 9-21:  
1722 30.58 Spain (RFE) 1220 30.71 Spain (RFE)  
1220 30.37 Antigua (DW)

My loggings. Bearcat 210, Hallicrafters SX-62, Hammarlund SP-600-JX-10, Allied A-2586, Swan 250 with Ameco nuvistor preamplifier; antennas: 30' wires at 12' running ne-sw and nw-se, 11-m ground plane at 14'; 5-element 6-m Cushcraft horizontal Yagi at 23' with rotor; all F2 mode unless noted (\* Es, bs = backscatter)(of course, the high-band VHF is tropo) with daily MUF peaks noted; GMT used, new underlined

9-6:  
1630 US 31+ ne; 2115 41.62  
2330 KLF527 35.22 Honolulu, HI-tp  
9-7:  
0057 KOE257 35.22 Phoenix, AZ-tp \*  
1855 30.42 Canada, 2035 41.62 Span.  
9-8:  
0213 KLF527, 1325 low-33 US  
2015 42.8 Spanish  
9-9:  
1615 low-30 Canada, 1945 40.86  
9-10:  
1140 WXX26 162.475 Laredo, TX-w  
1259 KGL714 31.10 NY, NY-transit  
1308 KCI315 33.64 Beacon Falls, CT-f  
1315 35 US ne; 1435 34.225 Canada  
1436 KCB781 33.70 Barnstable, MA-cf  
1855 42.800  
9-11: (magnetic activity)  
1720 38.500  
9-12:  
0735 WXX98 162.4 Del Rio, TX-w  
1745 low-30 Canada; 2115 46.74 Peru?  
2316 KLF527  
9-13:  
0013 30.475 Espinal, Colombia (5th ha)  
0055 30.04 VIR Australia (cw harm.)  
1805 41.62, 1900 hi-33 US  
9-14:  
1300 KCD244 33.70 Falmouth, MA-f  
KCD246 " S. Yarmouth, ""  
1301 KCF264 " Truro, " "  
KCD271 " Harwich, " "  
9-14:  
1301 KCF358 33.70 Centerville, MA-f  
KCD492 " Dennis Port, " "  
KCD497 " Buzzards Bay, " "  
1302 KCD498 " Sandwich, " "  
KCD556 " Orleans, " "  
KCD594 " Chatham, " "  
KCD760 " Osterville, " "  
KCB781  
KCD845 " Brewster, " "  
KCD574 " Eastham, " "  
1303 KCD454 " Hyannis, " "  
1305 KCF310 33.66 Chelmsford, " "  
KCF947 " Lowell, " "  
1308 KCE358 35.54 Shelburne, "-cf  
1434 36.23 BA, Argentina (stl)  
2010 46.24 Peru ?  
9-15:  
1520 38.500, 1525 40.86 ?  
1618 KCB715 33.90 Whitman, MA-f  
1620 KCD697 33.70 Provincetown, ""  
1630 KDC288 33.90 Hollis, NH-f  
KDA383 " Milford, " "  
KCE570 33.54 Turners, "-fdi  
KJ253 " Gill, "-f  
1649 KCB364 33.70 Hubbardstown, ""  
1723 KCF308 33.66 N. Reading, " "  
9-16:  
1720 38.5 Span., 2355 40.68 Pac.?  
36.23 (Arg. stl)  
9-17:  
1428 KCI981 33.70 Union, ME-f  
1800 38.500



## VHF UTILITY DX

NOVEMBER 1979

(Dyer, cont.)

9-18: (large magnetic storm)

1715 38.500

9-19:

1510 38.500, 1530 36.275 (Arg.stl)

1620 low-30 Canada

9-20:

1525 KCA351 33.90 Duxbury, MA-f

1529 KCA695 33.78 Manchester, NH-f

1531 KCD306 33.70 York, ME-f

1540 KCC997 " York Beach, ""

1717 KCD574, 1740 hi-35 US ne

1750 KGE960 33.78 NewCastle, DE-vf

1806 KCF944 33.54 Brattleboro, VT-f

KCE358

1825 KCE691 33.86 Weston, CT-vf

1915 36.8 multiplex, ne ?

1920 hi-37 Canada (Fr); 38.63

1930 KCF337 33.70 Boylston, MA-f

1933 KCF264

9-21:

1326 KCC825 33.70 Kennebunk, ME-f

1330 KCF364/367/366/370/368/369

33.78 Brookline, MA-f

38.500 Spanish

1331 KCC350 33.90 E. Bridgewater, MA-f

1334 KCC957 33.70 Bethel, CT-f

36.275 (Arg., stl)

1424 KCE869 33.70 Prospect, CT-vf

1433 KCA305 37.54 Eddington, ME-u

1435 KCC405 " Bangor, " -he

1436 KCA346 " Ellsworth, " "

1503 KEC515 35.58 Albany, NY-tp

1559 KDA381 33.90 Wilton, NH-f

1601 KDC288

1602 KDQ338 33.82 Sayreville, NJ-f

1910 42.105 Spanish; 1945 KLF527

2152 KCA585 33.90 Plymouth, MA-f

2155 KCH585 33.70 Rutland, " "

2158 KCD658 " Westminster, ""

2200 KCD353 " Lancaster, " "

KCG574 33.50 S. Easton, " "

KCA627 " N. " " ""

KCC825

2201 KCF311 33.66 Carlisle, MA-f

KCE579 33.78 Keene, NH-f

KCA695

2202 KCF944, KCF310

2209 KDX459 33.54 Medway, MA-f

2210 KCB364

2216 KCG711 33.54 Hamden, CT-f

2217 KCL540 33.90 Halifax, MA-f

2220 KCD598 33.54 Athol, " "

KCD500 33.70 Wellfleet, ""

2224 KCH794 33.54 Wrantham, ""

2235 KCE562 " Montague Center,

MA-fire district

2240 KCD556 33.66

2245 KCE563 33.54 Orange, MA-f

2259 KCF314 33.66 Tyngsborough, ""

2300 KJS918 " Dunstable, " "

KCF297 33.50 Foxboro, " "

2304 KCF364/366/368/369

9-22:

0155 LUSAHW 50.1+ B.A., Argentina-a

LU3EX " " " "

9-22:

0235 CE30K 50.1+ Santiago, Chile-a

0237 LU8MBL " Mendoza, Arg.- "

(Es to TE link, f/out apx 0320)

1404 KCA695

1413 KCB999 33.78 Burlington, VT-f

35 US ne

1430 KDA381, KDA383; 1515 KCE869

1530 KDT357 33.96 E. Lyme, CT-f

1545 36.8 multiplex (Canada ?)

1644 KOP303 35.46 Langley, WA-mp

1658 - 35.26 Seattle, " "

(1648 36.27 Arg.stl) 1730 43.18

2224 KCD500, 2249 KCD556 33.66

9-23:

0028 30.475 Espinal

1359 KDA383, KDC288, KCA695

1400 KDA381, 1401 KCA585 33.90

1412 KED411 33.86 Cliffside Park,

NJ-f

1430 KCC482 35.22 Concord, NH-vp

1436 KCB479 33.90 Kingston, MA-f

1448 KCD346 " Tolland, CT-f

1454 KCD575 33.70 Cheshire, " "

KBA626 33.50 Burlington, CT-vf

KRV295 33.96 Eastchester, NY-cf

1500 KBZ283 33.90 Orford, NH-fdi

KGG651 33.70 Derby, CT-f

1505 36.8 multiplex

1600 KCH954 33.70 N. Brandford, CT-f

1601 KCE584 33.92 Poquonock Bridge,

CT-f

1604 KCH236 33.70 Oxford, CT-f

1910 42.8

9-24:

0010 45.24 New Zealand ?

1329 KCD306

KCD471 33.70 Wells, ME-f

1330 KDC288, 1332 KDA381

1335 KCF367/366/370/368/369

1344 KEW451 33.78 Toms River, NJ-cf

1406 KCC405, 1407 KCA305

1429 KCD664 37.62 Holbrook, MA-gas

1438 - 35.58 Scranton, PA-vp

1440 - 35.22 Wilkes-Barre, ""

1442 KCI299 " New Haven, CT-tp

1446 KCA346, 1455 40.205 Canada (Fr)

1510 41.62 Spanish

1521 KCD392 33.86 S. Norwalk, CT-f

1635 KCA695, 1700 KDA383

1737 KCA585, 1750 KCB999

1759 KCA585 33.90

1806 KCW348 " Ft. Fairfield, ME-f

2100 36.275 (Arg.stl), 2256 KOE257\*

9-25:

0206 KLF527

1247 KCD371 33.98 Raynham, MA-f

1255 KCA585 33.90

KCH677 33.70 Fitchburg, MA-cf

KCB404 " Ashburnham, "-f

KCG342 " Barre, " "

KCB778 " Berlin, " "

KBA887 " Bolton, " "

KCF337

KCH246 " Clinton, " "

KCA395 " Gardner, " "

(Dyer, cont.)

9-25:					
1255	KCD582	33.70	Harvard, MA-f	9-27:	
1256	KCC705	"	Holden, " "	2200	KCD511 33.70 Camden, ME-f
	KCB364, KCD353			2215	46.55 Spanish
	KCB360	33.70	Leominster, MA-f		45.24/.25/.26 NZ (TV video)
1257	KAX916	"	Lunenburg, " "	2355	KLF527
	KDN599	"	Paxton, " "	9-28:	
	KCN575	"	E.Princeton, " "	1320	KCA328, 1327 KCF264 33.66
	KCH585			1330	KCD306
	KCE537	"	Sterling, " "		KFN716 33.70 Arundel, ME-f
	KCH239	"	W.Boylston, " "	1332	KCF364/367/368, 1335 KCC957
	KCD658			1336	KCD598
1258	KAV492	"	Winchendon, " "	1337	KCF596 33.86 Brookfield, CT-cf
1300	KCD454, KCD244, KCD246, KCD271			1348	KCD271, 1357 KCE869
1301	KCD492, KCD497, KCD498			1359	KDA383, KCA695; 1402 KCE358
	KCF574 33.70 Mashpee, MA-f			1403	KCE879 33.54 Colrain, MA-f
	KCD471, KCD760, KCB781, KCD306			1405	KCE570
	KCD574				KBF372 33.54 Hadley, MA-f
1303	KCA695, 1304 KCB999				KCE565 " Northfield, ""
1309	KCN689 33.54 Norfolk, MA-f			1408	KCB781, 1413 KCC405
1311	KCI233 33.66 Watertown, CT-f			1600	KBZ283, 1603 KCA585 33.90
1312	KCC405, 1316 KCI299			1628	KCE275 33.82 Fall River, MA-f
1322	KCE515			1629	KCA639 33.90 W.Wareham, " "
1503	KSA774 42.50 Sterling, IL-sp *				KCD697
1509	KCA305, 1515 KOP303 35.46			1633	KDA381, 1645 36.285(Arg.stl)
1517	36.275 (Arg.stl)			1655	43.7, 2155 40.68 Pacific ?
1528	- 35.26 Portland, OR-mp			9-29:	
1533	KOK418 35.46 (west)-mp			0031	KLF527
1534	- 35.26 Centralia, WA-mp			1258	KCH677, KBA887, KCD353, KCB360
1545	KAA201 42.06 Macon, MO-sp *			1259	KCH585, KCE537, KCH239, KCD658
1548	KAA203 " Kirkwood, "" "				KAV492
1558	- 35.26 Eugene, OR-mp			1300	KCD454, 1301 KCD492, KCD556 33.7
1601	KAA204 42.06 St. Joseph, MO-sp *			1301	KCF574, KCD760
1604	- 35.38 L.A., CA-mp *				KCB844 33.70 Greenfield, MA-f
1818	KVA288 35.22 Portland, OR-tp			1304	KCE579, 1308 KCD511
1945	- 35.26 Roseburg, " -mp			1310	KCI233, 1316 KCA583
2030	KDA381, 2111 KLF527			1318	KCF315 33.66 Westford, MA-f
2115	46.74			1327	KEG722 33.86 Ramsey, NJ-f
9-26:				1329	KDC288, 1330 KCF364/368
1259	KCD244, KCD246, KCF264 33.70			1336	KCB999, 1410 37's Canada (Fr)
1300	KCF358, KCD497, KCD498, KCF574			1428	hi-35 US ne
	KCD760, KCB781, KCD574, KCD454			1512	WR5ACD 146.94 C.Christi, TX-ar
1316	KCA583 33.98 Sudbury, MA-f			1530	KDA383, 1558 KCA639
	KCA328 33.50 Mansfield, ""			1701	KCH954
1329	KCA695; 1330 KDA383, KDA381			1704	KCH209 33.90 Waterford, CT-f
1347	KCH677, KDN599, KCH585, KCH239				KCC284 " Tolland, CT-f area
1348	KCD353, 1349 KAX916			1716	KCA661 " Carver, MA-f
1400	KDC288, KBZ283; 1401 KCH954			1720	KCE681 33.70 Rockland, ME-f
1404	KCC405, 1428 KCA346			1730	L.A. 35.38 *, 1732 L.A. 35.46 *
1505	KCA305, 1600 36.275(Arg.stl)			2220	45.26 Spanish, 2243 40.68 Pac?
(1420	41.62 Spanish), 1642 KCD697			2307	KLF527
1659	KCD306, 1701 KCD582			9-30:	
1703	KCE579, 1705 KCB999			0030	37.80 Russian
1722	KCG933 33.90 Norwell, MA-f			0934	WR5AFR 146.82 Victoria, TX-ar
1727	KCF310			1100	KWH351 155.37 Hempstead, TX-cp
1842	KOH894 33.70 Winslow, WA-cf				KVJ745 " Hebronville, ""
2100	45.36 ?, 2147 KLF527			1525	43.18 (1415 US ne only to 31's)
9-27:				1842	KLF527 (1450 36.285 Arg.stl)
1438	KCC405, 1528 KCD471			2108	40.68 Pacific ?
1530	KBZ283, KCA695; 1531 KCD353			10-1:	
1553	KBA887, 1559 KDC288			1532	KCF582 33.70 Thomaston, ME-f
1655	KCD753 33.90 Putnam, CT-f			(1505	36.285 (Arg.stl), 2000 46.55
1659	KCB781; 1958 KCD492, KCD246			2101	KCC907 33.70 Blue Hill, ME-f
2017	KCJ939 33.70 Tenants Harbor, ME-f			2132	45.24 New Zealand
				2159	KCC825, 2200 KCC997
				2202	KCE681, 2203 KCD511

(Dyer, cont.)

10-1:  
 2204 KLD863 33.70 Rockland,ME-f  
 2220 KCD500  
 2225 KLU466 33.70 Warren,ME-f  
 2226 KCD492, 2230 KCD271  
 2234 KCN689, 2239 KCD556  
 2256 KCF264 33.66, 2349 KLF527  
 10-2:  
 1359 KCC482, KDA383; 1402 KCB999  
 1605 36.285 (Arg.stl), 1903 KCC997  
 1958 KFN716, 2000 KCF311  
 2028 KCE681, 2059 Portland 35.26  
 2108 KOP303 35.46, 2123 46.24 Sp.  
 2144 Seattle 35.26, 2145 KCE537  
 2145 KCA303 33.70 Dover,MA-f  
 2151 KCA585 33.90, 2154 KCF366  
 2156 KCH585, 2158 KCD658  
 2159 KBA887  
 KCY582 33.70 Franklin,MA-f  
 KCN857,  
 KCD820 33.70 E.Bridgewater,MA-f  
 2200 KCL540, 2201 KCD511  
 2202 KCA378 33.82 New Haven,CT-f  
 KCD575, KCD471  
 KJR439 33.70 New Milford,CT-vf  
 2203 KDA381, 2204 KCE358  
 2206 KCD598, 2207 KCB844  
 2209 KDX459, 2210 KCB364  
 2214 KCG711, 2216 KDC288  
 2228 KCF980 33.50 Sharon,MA-f  
 2229 KCC825; 2230 KCG342, KCE570  
 2234 KCF310  
 2240 KCF375 33.50 Walpole,MA-f  
 2244 KCD556 33.66  
 2247 KDB386 " Pepperell,MA-f  
 2258 KCD500, 2259 KCF314  
 2300 KKSJ918, 2300 KCG933  
 2301 KCL524 33.90 Bristol,NH-f  
 2304 KRZ280 " Glens Falls,NY-cf  
 2317 KBI789 " Mapleton,ME-f  
 10-3:  
 0056 KLF527  
 1347 KCC405, 1357 KCA346  
 1406 41.27 France (TV audio)  
 1420 41.52 Canada, 1540 40.28 Rus.  
 2145 46.24 Spanish  
 2201 KBZ283, KCW348; 2202 40.68 Pac?  
 2207 KCA585 33.90, 2212 KDX459  
 2216 KDG722 33.66 Littleton,MA-f  
 2230 KCN689, KCD556 33.66  
 2255 KCF264 33.66, 2259 KCA695  
 2333 KLF527, 2359 KOP303 35.46  
 10-4:  
 0005 Portland 35.26  
 1416 KCB999, 1425 36.295 (Arg.stl)  
 1741 KCA585 33.90, 1755 KOP303 .46  
 1829 KDA381, KDA383, KDC288  
 1905 46.24 Spanish  
 2139 KCG491 33.60 Wallingford,CT-f  
 2141 KLM647 33.54 Whatley,MA-f  
 2142 KCD575  
 2145 KEP595 33.54 Bellingham,MA-f  
 KCF528, KCE537  
 2150 KCC748 33.94 Windsor,CT-f  
 2155 KCE869; 2156 KCH585, KCE358

10-4:

2157 KCE287 33.94 Rocky Hill,CT-f  
 2158 KCD658, KCB778, KCA639  
 2159 KCN857  
 2200 KCC532 33.58 Plainfield,CT-f  
 2201 KJE253  
 2204 KCH469 33.54 Shutesbury,MA-f  
 KCC944 33.70 Torrington,CT-f  
 2205 KCC825, 2208 KBA887  
 2210 KDX459, 2211 KCD246 33.58  
 2212 KCE816 33.58 Southington,CT-f  
 2213 45.25/.26 New Zealand  
 2216 45.24 NZ  
 2231 KCE669 33.70 New Milford,CT-f  
 2232 KCA276 33.94 New London, " "  
 2239 KCE879  
 KEM734 33.94 Canton,CT-vf  
 2240 37.56 Russian, 2247 KCG651  
 2300 KCG933  
 KCR901 33.98 Rochester,NH-f  
 KR6627 33.84 Colonie,NY-f  
 2304 KCF364, 2313 KCB999  
 2315 KCF617 33.70 Middlebury,CT-f  
 2333 Seattle 35.26

10-5:

1338 41.23/.25 France (TV audio)  
 1354 KCA346, 1356 KCA305  
 1415 41.5 England (TV audio)  
 1417 41.48 " " "  
 1520 43.7; 1525 36.295 (Arg.stl)  
 1525 KOP303 35.46, 1714 same 35.62  
 1754 Portland 35.26, 1902 KCC405  
 2015 Seattle 35.26  
 2155 KCF315 33.66 Westford,MA-f  
 2157 KCY582, KCD658  
 2158 KCB778, KBA887, KCD353  
 2201 KCG574, KCA627  
 2202 KDR298 33.86 Somerville,MA-f  
 2325 38.22 Russian

10-6:

0015 KLF527

Sep solar flux avg 201 made a Mar smoothed avg 178. Swiss think peak has been passed. Boulder still opts for Nov...45 BBC video into east well, 41 audio to California...48.25 African E2 to Europe and Canada...49.75 video to CA via bs to NZ...  
 50-MHz news: Cyprus beacon 50.498 into NB Canada Oct 3 @15z, also to S.Africa & Brazil...Gibraltar to French Guyana & Brazil...S.Africa to s.Europe...S.America to Hawaii & Japan...French Guyana and Brazil to s,se,e,& ne US and Canada...FY7THF fsk beacon now on 50.037...for the latest VHF news monitor the 28.885 spot on 10-m.

will decode these abbreviations when space and time permit

73, Pat

WA5IYX

# IN SEARCH OF PSB

Donald L. Blevins  
1715 Earhart Road  
Baltimore, MD 21221  
301-574-2714

IN SEARCH OF PSB....This month will deal with frequencies in the low band VHF range that should be possible to receive via F-2 skip. These frequencies will be useful especially for those of you on the west coast, considering the fact reception is possible from the west coast at the contributor's location.

Mr. Mark S. Lucas of Lancaster, Ohio is responsible for the list of frequencies from Ohio, and Mr. Micheal Scheel is responsible for the excellent illustration of Northwest Illinois state Police Districts.

I only know from my own observations what could be received from here in the Baltimore area, so take what I am about to say with that in mind. My total loggings of stations during the period 10-78 through 4-79 generally began at the beginning of each day at about 9:30 AM through 7:30 PM with the following sequence of events.....

- 1) Spanish repeaters on 39.18, 42.90 and 41.50 (9 AM throughout day)
- 2) Los Angeles County Sheriff on various frequencies from 39 - 40 mhz (Generally present from 9 AM throughout daylight hours frequently until 8 PM November through February)
- 3) Montana Sheriff Departments (10 AM until 4 PM)
- 4) California Highway Patrol (11AM until 3 PM)
- 5) Oregon State Police (12 PM until 4 PM)

With this in mind as a general guideline, F-2 should be fun and profitable.

Mark S. Lucas  
Lancaster, Ohio reports:

Bill Phillipson  
Cupertino, CA reports:

- 33.90 Groveport-Madison FD
- 33.92 Whitehall FD
- 33.98 Perry County Fire Control
- 46.42 Lancaster-Logan-athens-Nelsonville FD
- 154.13 Ross County Fire Control
- 154.31 Columbus Fire Department
- 39.40 Lancaster Police Department
- Hamilton County Sheriff's Department
- 39.44 Fairfield County Sheriff's Department
- Lancaster County-Pickaway County
- 39.58 Common Use Frequency
- Lexington
- 39.64 Perry County
- New Lexington
- Athens County
- Athens City
- Logan City
- Hocking County
- 39.96 Pickerington Police Department
- 44.74 Athens District #7 Ohio State Patrol
- 44.94 Ohio Highway Patrol District #6
- 44.98 South/Southwestern Ohio Highway Patrol
- 45.02 Inter-Post Ohio State Patrol
- Radar Enforcement
- 45.10 Mobile Command Post
- Liquor Control
- 45.22 Statewide Health & Mental Hygiene
- Statewide Department of Corrections

San Francisco Field Office  
United States Park Police 164.80

David Wilson  
Suffield, OH reports:

- 33.74 Akron FD KQA 880
- 33.86 Akron FD KQA 880
- Bath Twp FD KQF 420
- Boston Hts FD KJL 606
- Copley FD KLI 271
- Coventry Twp KBK 516
- Fairlawn KVG 731
- Franklin Twp KQF 421
- Green Twp KBK 517
- KLW 311
- Hudson KBK 518
- Macedonia KYD 899
- Mogadore KBK 519
- Northfield KEY 974
- Northfield CTR KQI 236
- Norton KBK 520
- Peninsula KBS 487
- Reminderville KYG 716
- Richfield Twp KBK 521
- Springfield Twp KBK 522



NORTHWEST  
ILLINOIS  
STATE POLICE  
DISTRICTS

© 1979

QUAD-CITIES  
TELECOMM

PERMISSION TO BE PRINTED  
IN WTFDA'S VHF-UHF DIGEST  
GRANTED. MWSchul

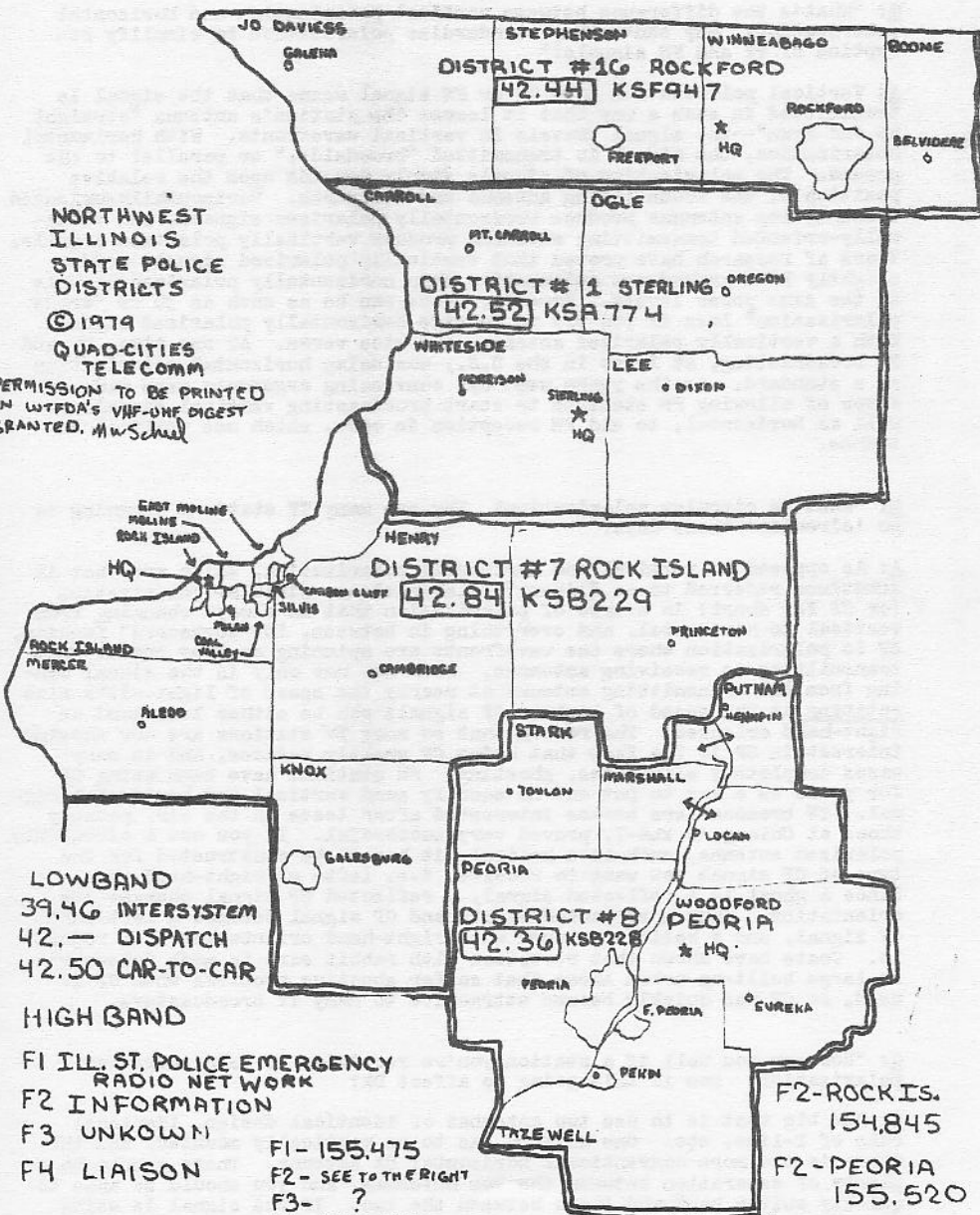

LOWBAND  
39.46 INTERSYSTEM  
42. — DISPATCH  
42.50 CAR-TO-CAR

HIGH BAND

F1 ILL. ST. POLICE EMERGENCY  
RADIO NETWORK

F2 INFORMATION

F3 UNKNOWN

F4 LIAISON

F1 - 155.475  
F2 - SEE TO THE RIGHT  
F3 - ?  
F4 - 155.460

F2-ROCK IS.  
154.845

F2-PEORIA  
155.520

DIST # 1 & 16  
NONE

# TECHNICAL TOPICS



**Q:** "What's the difference between vertical polarization and horizontal polarization? Why can't they standardize polarization to simplify reception of TV and FM signals?"

**A:** Vertical polarization of a TV or FM signal means that the signal is transmitted in such a way that it leaves the station's antenna "straight up and down"--the signal travels in vertical wavefronts. With horizontal polarization, the signal is transmitted "broadside," or parallel to the ground. The polarization of signals simply depends upon the relative position of the transmitting antenna and the earth. Horizontally-oriented transmitting antennas produce horizontally polarized signals, and vertically-oriented transmitting antennas produce vertically polarized signals. Years of research have proven that vertically polarized signals suffer slightly less groundwave attenuation than horizontally polarized signals at the same power levels. However, there can be as much as 30 dB "cross polarization" loss if you try to receive horizontally polarized signals with a vertically polarized antenna, and vice versa. At one time, TV and FM broadcasting, at least in the U.S., was using horizontal polarization as a standard. As the years went by, convincing arguments were made in favor of allowing FM stations to start broadcasting vertical signals as well as horizontal, to aid FM reception in cars, which use vertical antennas.

**Q:** "What is circular polarization? Why are many TV stations planning to go 'circular' these days?"

**A:** As opposed to vertical and horizontal polarization, which are what is sometimes referred to as "linear" polarizations, circular polarization (or CP for short) is a type of polarization that is always changing from vertical to horizontal, and everything in between, in "corkscrew" fashion. CP is polarization where the wavefronts are spinning as they travel from transmitting to receiving antennas. With CP, not only is the signal coming from the transmitting antenna at nearly the speed of light--it's also rotating at the speed of light. CP signals can be either left-hand or right-hand oriented. The reason that so many TV stations are now showing interest in CP is the fact that using CP greatly reduces, and in many cases completely eliminates, ghosting. FM stations have been using CP for years as a way to put out an equally good vertical and horizontal signal. TV broadcasters became interested after tests on the air, notably those at Chicago's WLS-7, proved very successful. If you use a circularly polarized antenna, such as a helical, it has to be constructed for the type of CP signal you want to receive, i.e. left- or right-hand type. Since a ghost is a reflected signal, a reflected CP signal changes its orientation. Thus a reflected right-hand CP signal becomes a left-hand CP signal, and a helical antenna with right-hand orientation will reject it. Tests have shown that reception with rabbit ears is much "cleaner" in large built-up urban areas that suffer ghosting problems when CP is used, so CP has quickly become attractive to many TV broadcasters.

**Q:** "How can you tell if a station you're receiving is using circular polarization? How is this going to affect DX?"

**A:** The big test is to use two antennas of identical design, identical runs of T-line, etc. One antenna has to be vertically mounted, and the other is the more conventional horizontal DX antenna. There should be plenty of separation between the two antennas, and you should be able to quickly switch back and forth between the two. If the signal is using CP, there will be no difference between the two antennas, assuming they are both at the same height above ground. Obviously, it's easier to do this type of test with a good FM receiver which features an S-meter for signal strength indication. With a station not using CP, and using

only horizontal polarization (such as most TV stations), the difference between signals on vertical and horizontal antennas should be very dramatic, with much weaker signals from the horizontally polarized station noted with the vertically-mounted antenna. In theory, the difference is supposed to be around 30 dB—but in actual practice, it will be much closer to 25 dB, due to some "repolarization" from terrain and buildings, power lines, etc. The effects on DX are quite interesting, primarily during a skip opening. Fading during an E-skip opening should be reduced, and not quite as "deep" as with horizontally-polarized only signals. Using a vertical antenna to reduce the signal strength of a horizontally polarized local station, which many DXers have been doing for years, may also be of great assistance for receiving CP stations during a skip opening, if your local does not have CP.

Q: "What causes the E-skip 'clouds' to float at a constant altitude? Are the E and F layers of the ionosphere like 'ceilings' in the upper limits of the atmosphere?"

A: The various layers of the earth's ionosphere do not have sharply defined limits, contrary to what you might think. There is ionization between the areas that we have defined as "layers"—but since most of the refraction of HF and VHF frequencies takes place in these layers, they are most frequently illustrated by drawings such as the one below, which shows what the ionosphere is like in the daytime, from the DX enthusiast's point of view:

(NOT TO SCALE)

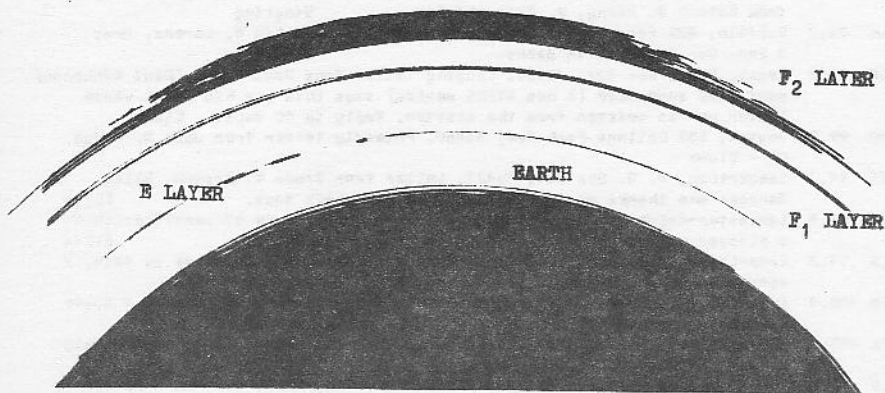

Not shown in this illustration is the D layer, which is below the E layer, and is only of concern to the DXer when it absorbs signals. The D layer prevents, rather than causes, good DX conditions. When we talk about an ionospheric layer, keep in mind that what we are actually talking about is an area of greatest electron density. Each layer is ionized under different sets of conditions, so each has its own special kind of conditions and characteristics. The E layer can be at an altitude of 50 miles or lower—or at a level of 90 miles or higher (but very rarely much higher or lower). E-skip clouds do not float at a specific altitude, and vary greatly in size and shape. The ionization of the F layer, and subsequently the height, varies with time of day, time of year, and so forth. The maximum electronic density of the lowest layer is less than that of each layer above it, but of course the higher the altitude, the thinner the actual atmosphere becomes. An ionospheric layer is simply an area with the greatest number of free electrons, and not something that has sharply defined boundaries (such as tropospheric cloud layers often have) that can be seen with the naked eye. The variations in average heights of each layer above the earth is directly affected by the heating and cooling of the earth's atmosphere; as it heats, it expands—and when it cools, it contracts.

# QSL CORNER

FM-QSL's

Thomas J. Vingling, jr.  
221 Pinewood Road  
Baltimore, MD 21222  
Phone # 1-301-282-5649  
Deadline: 10th

- AL WERH 92.1 Hamilton-QSL Card, bumper stickers, & coverage-map from Edgar Clayton, CE, in 2 weeks. Alexander
- FL WCRD 92.1 Hialeah-Short but specific letter rating sheet & flyer in 1 week from E. Glynn Walden, CE Wood
- WTMI 93.1 Miami-Short, inspection letter, CM, bumper sticker, rate card & data sheet from Alvis Sherouse, Dir. of Broadcast Operations. said that my report was most distant yet. Wood
- CO KHDW 95.7 Denver-Letter in 1 week from Hue Beavers, CE. Wood
- IL WSIU 91.9 Carbondale, Dept of Radio-TV, Southern Ill. Univ, 62901. Letter from Jim Moore, Dir. of Eng. Sawatzky
- IN WIKS 99.5 Greenfield, 1649 West Main, 46140. Letter & map from Curtis R. Steele, CE in 1 month. Date not specified, they're "pleased" to receive DX reports. Mount
- KS KFNF 101.1 Oberlin-Letter from David Strang, Staff Announcer, says my report is fastest in the stations 2 year history. Reply in 12 days without return postage. He was the announcer I heard when I reported reception. Chernos
- MN KSJN 90.7 St. Paul-Letter from Marilyn Heltzer, Dir of Membership, send bumper sticker & program magazine. Chernos
- KROC 106.9 Rochester, 122 SW 4th St, 55901. Send letter from Alan P. Melberg, Program Director. Told of a report from Rockford, IL. Boehl
- NV WFFV 90.7 New York-Specific verification send by Frank A. Seitz, GM. Elving
- WAVV 106.5 Buffalo, 2200 Rand Bldg, 14403. Letter from Rick Lesniak, Program & GM, says my report is unusual as is out of map, ask if I heard regularly. reply in 15 days with no return postage. Chernos
- WVOR 100.5 Rochester, Box 40340, 333 Midtown Tower, 14604. Letter, map, & 4 post cards from Robert W. Denny, V. Pres. of Eng. Vingling
- WBLK 93.7 Buffalo, 429 Franklin St, 14202. Letter from Franklin W. Lorenz, Pres. & Gen. Man. Reply in 1 1/2 weeks. Vingling
- OH WLGW 98.3 Logan, P. O. Box 429, 43138. Lengthy letter from Paul Mount (Paul Richards) part time announcer (a new WTFDS member) says this was his first verie letter he has written from the station. Reply in 10 days. Clark
- WVUD 99.9 Dayton, 300 College Park Ave, 45469. Friendly letter from John W. Fudge, CE - Clark
- PA WYSS 94.3 Saegertown, P. O. Box 321, 16437. Letter from Bruce W. Dawson, Sales Manager who thanks me for send then an air check tape. Ellis
- WDAC 94.5 Lancaster-Ralph Haneman, CE send engraved certificate of verification & a clipped on note of once being heard in Minnesota. Ellis
- WOLN 91.3 Erie-Letter from Ron Slomski, Manager of Membership. Asked me to join, & send a donation, did send program guide. Chernos
- SC WGF6 100.1 Lake City, P. O. Box 1177, 29560. Letter from Ken Martin, Program & Music Director, reply in 13 days. Chernos
- WYAK 103.1 Surfside Beach, P. O. Box A, 29577. Letter from Robert E. Johnson, reply back in 21 days. Chernos
- SD KOLV 99.5 Mobridge-Very specific letter from Jan Leuning, Oper. Man. in 1 week, with bumper sticker, & told of another report from Nashville, TN Wood
- KRCS 93.1 Sturgis,-Brief letter from Hardy Koontz, Manager, reply in 1 week. Wood
- WV WWHF 92.7 Clarksburg, 350 W. Main St, 26301. Letter from Mike Hornick, Program Dir. says they only operate with 620 watts erp! They don't know how I heard then with that low power. Vingling

Reporters this time are: Jim Alexander, Richard Wood, Peter Sawatzky, Saul Chernos, Bruce Elving, Albert Ellis, Paul Mount, & Tom Vingling, Editor. This was an all FM QSL Month. One thing I must say for those who report to this column, please send a report with the signers' name & station mailing address. This column is no good without both. Not all the members can afford to buy station address books, like Broadcast Yearbook. So PLEASE when you report, you do this to help the other club members out when they report to that station that YOU just got verified. I hope this is done soon, thanks, 73's Tom Vingling



# TUNE IN ON SIX

What's the world's hottest DX band right now? If you're already an avid VHF DXer, you probably already know the answer.

It's 6 meters, the amateur radio band that runs from 50 to 54 MHz--and you don't have to be an amateur radio operator to share some of the DX excitement that's taking place on the band.

What makes 6 meters "special" to the VHF DXer isn't just the fact that it presents more of a challenge to DX, because of the low power used by many hams (as compared to that used by TV and FM broadcasting stations). The most interesting thing about 6 isn't even just the F2 skip that's currently bringing the band to life. The single most interesting aspect of 6 meters is variety--a variety of DX propagation not found on almost any other part of the VHF spectrum.

The 50 to 54 MHz band is in the right part of the spectrum for every major mode of DX propagation. You name it, 6 has got it. For instance:

**TROPO:** Not as frequent on 6 meters as say, FM or highband PSB or TV--but almost always interesting. In certain parts of North America, 6 meters will open out to 500 miles or more on tropo, and with the right receiving equipment, such as a three-element yagi fed into a good low-noise receiving converter attached to a shortwave receiver, you'll be able to hear stations running 100 watts or less in the 500-mile range, in an excellent opening.

**METEOR SCATTER:** If you can receive 6 meters, listen to 50.1 or thereabouts during the peak of a major meteor shower. You're liable to hear many "ping" type meteor bursts from ham stations--believe it or not, many successful two-way amateur contacts or "QSOs" have been made this way!

**TE SCATTER:** This is an almost nightly propagation utilized by hams in the Caribbean and Mediterranean these days, and they're making contacts with South America and southern African stations. By far, the best TE action is taking place in Asia and Australia, with hundreds of contacts already made during this current sunspot peak activity. North America is almost too far north of the geomagnetic equator in this hemisphere, so such loggings are rare in North America--but have been known to take place, especially when E-skip links the continent into a TE event.

**E-SKIP:** For many hams, Es is what 6 is all about. Distances are roughly similar to those we encounter on 30-50 MHz PSB, and on ch 2 TV, but multi-hop Es is much more common on 50 MHz than it ever is on TV, mostly because of the wideband nature of a TV channel, and the number of them usually on the air when such an event is taking place.

**F2-SKIP:** This is the reason that 6 meters is receiving so much attention in ham radio circles these days. We're now at the peak (or very near it) of the current sunspot cycle, and 6 has been breaking loose from time to time with some real earth-shaking DX.

If you're not tuning in on 6 these days, you're missing some real DX. Amateur radio stations are usually very easy to identify on SSB, if you have the right equipment and can speak English--the major language in use in amateur radio today. We've only given you a brief look at what's possible on 6. Tune in during a DX opening and find out for yourself--you may even end up getting bit by the amateur radio bug!





**TOUGH  
TO BEAT!**

# WORLDWIDE TV-FM DX ASSOCIATION

Post Office Box 97 Calumet City IL 60409 U.S.A.

Established 1967

SERVING THE VHF-UHF DX ENTHUSIAST



DUES: U.S. and CANADA, \$13 (via first class); overseas, \$18 (via air mail)

The VHF-UHF DIGEST is the official publication of the Worldwide TV-FM DX Association. WTFDA is a non-profit organization and a member club in the Association of North American Radio Clubs (ANARC).

Persons contributing their efforts for the Worldwide TV-FM DX Association do so without any monetary compensation. Dues and all other revenue cover printing, postage, and other expenses.

The WTFDA is governed by a five-man board of directors, composed of Morrie Goldman, Mike Hogan, Pete Oprisko, Bill Thompson, and John Zondlo. ANARC representatives are Morrie Goldman, Pete Oprisko, and John Zondlo.

EDITOR-IN-CHIEF.....	Bill Thompson	COMPROLLER.....	Gary Olson
PUBLISHER.....	Pete Oprisko	BOOKKEEPER.....	Bruce Elving
CIRCULATION.....	John Zondlo	PROCESSING.....	Dave Janowiak
DISTRIBUTION.....	Mike Hogan	LITERATURE.....	Morrie Goldman

S U P P L I E S and D X L I T E R A T U R E Available from WTFDA HQ.

REPRINT SERVICE.....Articles from May 1972 through 1978 are available.  
A complete catalog can be obtained FREE from HQ.

VUD Back Issues.....Available: January 1975 to present. 50¢ each

BEYOND SHORTWAVE....An introduction to TV, FM, and VHF-UHF radio, written by prominent DXers. \$1.50

THE FM ATLAS AND...An accurate and detailed listing of FM STATION DIRECTORY with maps and special articles, written by (Latest Edition!) Bruce F. Elving, VUD FCC FM News editor. \$4.50 via 1st class Also available at \$3.95 via 3rd class.

EDUCATIONAL FM.....A comprehensive guide to the educational FM GUIDE (EFM) stations in the U.S., featuring schedules. \$2.00

ONDAS FM.....A guide to coastal U.S., Central and South American FM stations, featuring FM Atlas-style maps. English and Spanish articles. \$3.00

Club Rubber Stamp...Official WTFDA emblem, as at the top of this page, 37 mm in diameter. Order from \* Weldon Patterson-Box 25-Adolph, MN 55701 \$3.50

WTFDA Stationery...Features official WTFDA emblem, as at the top of this page, printed in blue on bond. 45 sheets \$1.00

DX Log Sheets.....Punched for a 3-ring binder. Great to keep DXers' running logs neat and orderly. pad of 100 \$3.50

VUD Boxers.....Attractive cases designed to keep copies of the VHF-UHF DIGEST organized. \$1.50 each

Station QSL.....For requesting QSLs (verifications) from Report Forms TV and FM stations. Offset printed. 50 sheets \$2.00

DX Column.....For reporting to the DX columns printed Report Forms each month in the VHF-UHF DIGEST. FREE for a S.A.S.E.

All columns and feature articles to be printed in any VUD issue should be sent to editor Bill Thompson, 1907 Seneca Street, Buffalo, New York 14210. All information for VUD columns should be sent to the appropriate editors; all club business (supply orders, etc.) should be sent to HQ.